

CERTIFIED RECORD OF LAND CORNER MONUMENTATION

HISTORY OF ORIGINAL CORNER ESTABLISHMENT:

Plat of Union Orchard Tracts: Set 1 1/2" iron pipe
 Survey No. 23-89: Fnd 1 1/2" iron pipe
 Minor Partition No. 1994-02: Fnd 1 1/2" iron pipe
 Survey No. 004-1997: Fnd 1 1/2" iron pipe
 Survey No. 005-1997: Fnd 1 1/2" iron pipe

DESCRIPTION OF CORNER EVIDENCE FOUND:

Found 1 1/2" iron pipe

See Survey No. 032-1999

DESCRIPTION OF MONUMENT AND ACCESSORIES I ESTABLISHED TO PERPETUATE THE ORIGINAL LOCATION OF THIS CORNER:

At position of 1 1/2" iron pipe, I set a 2 1/2" x 30" Copper Clad monument marked as shown, 36" in the ground, from which:

NEW BEARING OBJECTS:

A 5/8" x 30" Iron rebar with aluminum cap marked NE RP, bears N 37°E a distance of 6.85 feet.

A PK nail 2 feet above ground in Power Pole, bears S 86°W, a distance of 63.80 feet.

A 5/8" x 30" Iron rebar with aluminum cap marked SW RP, bears S 27°W, a distance of 8.33 feet.

A PK nail 2 feet above ground in RR Tie, bears N 51°W, a distance of 78.23 feet.

I hereby certify that the corner was monumented on June 24, 1999

Witness: Gregory T. Blackman Jr. and Norb Volny

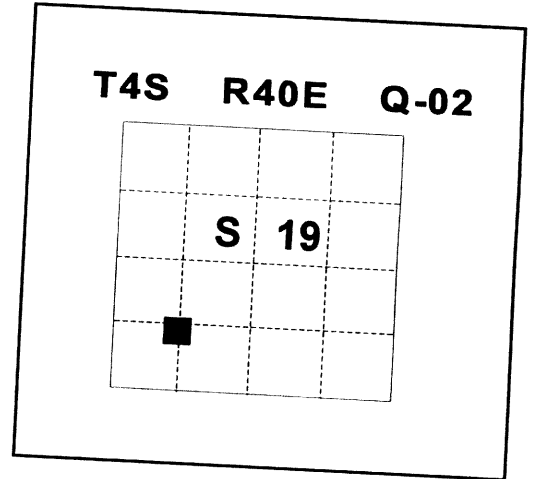

REGISTERED
 PROFESSIONAL
 LAND SURVEYOR

Gregory T. Blackman

OREGON
 JULY 13, 1973

GREGORY T. BLACKMAN
 991

Renewal Date: December, 31 1999

UNION COUNTY SURVEYOR

T 4S R 40E

SW 1/16

S19

1999

OPLS 991

UNION COUNTY SURVEYOR

Date Received 9/13/99

Date Filed 10/8/99

Filed By R. Robinson, Deputy

File Number 048-1999R

I used a steel tape and a magnetic compass in the establishment of the new accessories. I used 17 1/2° East declination. The distances are the center of each bearing object, unless otherwise noted above.

GEODETTIC CONTROL DATA

**OREGON STATE PLANE, NORTH ZONE (3601)
UNION COUNTY, OREGON**

STA. NAME: 9937

SW SIXTEENTH CORNER: GEODETTIC COOR: NAD 83(91)

SEC.19 TWP.4 S. RGE. 40 E LAT: 45:11'55.58496" N

UNION COUNTY, OREGON

DATE TIED: JULY, 1999 LONG: 117:51'55.69807" W

SURVEYOR: WALTER L. CASWELL SP. COOR: NAD 83(91)

PLS 737

N: 569633.356 INT.FT

FIRM: EAGLE GPS SURVEY CORP

6110 SW LOMBARD AVE.

E: 8881057.284 INT.FT.

BEAVERTON, OR. 97008-4736

(503) 643-1073

THETA: 1:52'06.134"

TYPE: GPS

SCALE FACTOR: 0.999894720

ORDER: SECOND CLASS: 1

ELEV: 2769.91 U.S.FT.

ELEV. DATUM: NGVD 1929(1947)

DIRECTIONS "TO REACH":

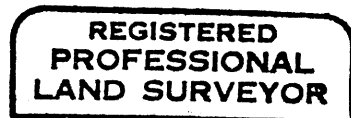

10-14-99

EXPIRES: 06/30/01

1 METER = 3.280833... U.S. FEET = 39.37 INCHES EXACTLY
1 METER = 3.280839895 INTL. FEET OR 1 INCH = 2.54CM. EXACTLY
TO CALCULATE ELEVATION FACTOR (IN THE NORTH AMERICAN CONTINENT)
DIVIDE 20,906,000 BY (20,906,000 + ELLIPSOID ELEV. IN FEET)