

CERTIFIED RECORD OF LAND CORNER MONUMENTATION

HISTORY OF ORIGINAL CORNER ESTABLISHMENT:

Corner not previously established

DESCRIPTION OF CORNER EVIDENCE FOUND:
NONE

See Survey No. 032-1999

**DESCRIPTION OF MONUMENT AND ACCESSORIES I ESTABLISHED
TO PERPETUATE THE ORIGINAL LOCATION OF THIS CORNER:**

At proportionate position determined by survey, I set a 2½"x 30" aluminum monument marked as shown, 30" in the ground from which:

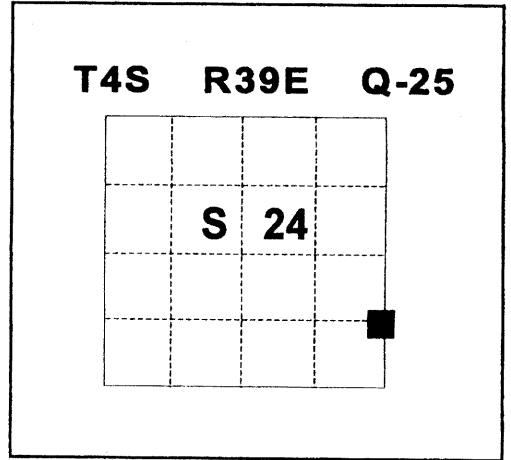

NEW BEARING OBJECTS:

A 5/8" x 30" Iron rebar with aluminum cap marked NE RP bears N 19°E, a distance of 22.85 feet.

A 5/8" x 30" Iron rebar with aluminum cap marked SE RP bears S 38°E, a distance of 25.10 feet.

A 5/8" x 30" Iron rebar with aluminum cap marked SW RP bears S 47°W, a distance of 43.00 feet.

A 5/8" x 30" Iron rebar with aluminum cap marked NW RP bears N 71°W, a distance of 19.30 feet.

I hereby certify that the corner was monumented on June 24, 1999
Witness: Gregory T. Blackman Jr. and Norb Volny

VOID

REGISTERED
PROFESSIONAL
LAND SURVEYOR

Gregory T. Blackman

OREGON
JULY 13, 1973

GREGORY T. BLACKMAN
991

Renewal Date: December, 31 1999

UNION COUNTY SURVEYOR

T 4S R 40E

S 1/16

S 24 | S 19

R 39E | R 40E

1999

OPLS 991

UNION COUNTY
SURVEYOR

Date Received 9/13/99

Date Filed 10/18/99

Filed By R. ROBINSON, DEPUTY

File Number 049-1999K

I used a steel tape and a magnetic compass in the establishment of the new accessories. I used 17½° East declination. The distances are the center of each bearing object, unless otherwise noted above.

GEODETTIC CONTROL DATA

**OREGON STATE PLANE, NORTH ZONE (3601)
UNION COUNTY, OREGON**

STA. NAME: 9936

SOUTH SIXTEENTH CORNER:
T4S SEC 24 | 19 T4S
R39E R40E
UNION COUNTY, OREGON
DATE TIED: JULY, 1999

GEODETTIC COOR: NAD 83(91)
LAT: 45:11'55.72197" N
LONG: 117:52'13.98088" W

SURVEYOR: WALTER L. CASWELL
PLS 737

SP. COOR: NAD 83(91)
N: 569604.585 INT.FT

FIRM: EAGLE GPS SURVEY CORP
6110 SW LOMBARD AVE.
BEAVERTON, OR. 97008-4736
(503) 643-1073

E: 8879748.474 INT.FT.
THETA: 1:51'53.168"

TYPE: GPS

SCALE FACTOR: 0.999894720

ORDER: SECOND CLASS: 1

ELEV: 2761.42 U.S.FT.

ELEV. DATUM: NGVD 1929(1947)

DIRECTIONS "TO REACH":

VOID

REGISTERED
PROFESSIONAL
LAND SURVEYOR

Albert Hertel 10-14-99

OREGON
JULY 18, 1980
ALBERT HERTEL
1896

EXPIRES: 06/30/01

1 METER = 3.280833... U.S. FEET = 39.37 INCHES EXACTLY
1 METER = 3.280839895 INTL. FEET OR 1 INCH = 2.54CM. EXACTLY
TO CALCULATE ELEVATION FACTOR (IN THE NORTH AMERICAN CONTINENT)
DIVIDE 20,906,000 BY (20,906,000 + ELLIPSOID ELEV. IN FEET)

CERTIFIED RECORD OF LAND CORNER MONUMENTATION

HISTORY OF ORIGINAL CORNER ESTABLISHMENT:

Corner originally established by Survey No. 032-1999

DESCRIPTION OF CORNER EVIDENCE FOUND:

Found corner monument set at erroneous coordinate position June 24, 1999.
Reset to true position as per Survey No. 032-1999

Found original Southeast, Southwest, and Northwest bearing objects

See Survey No. 032-1999

DESCRIPTION OF MONUMENT AND ACCESSORIES I ESTABLISHED TO PERPETUATE THE ORIGINAL LOCATION OF THIS CORNER:

At proportionate position determined by survey, I set a 2½"x 30" aluminum monument marked as shown, 30" in the ground from which:

ORIGINAL BEARING OBJECTS: (Bearing & Distance to reset corner)
A 5/8" x 30" Iron rebar with aluminum cap marked SE RP bears S 38°E, a distance of 27.44 feet.

A 5/8" x 30" Iron rebar with aluminum cap marked SW RP bears S 46°W, a distance of 44.78 feet.

A 5/8" x 30" Iron rebar with aluminum cap marked NW RP bears N 82°W, a distance of 18.36 feet.

No evidence found of original Northeast RP.

I hereby certify that the corner was monumented on May 3, 2001
Witness: Norbert Volny

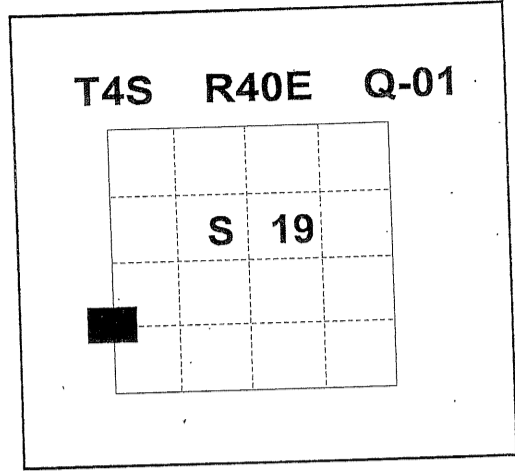

REGISTERED
PROFESSIONAL
LAND SURVEYOR

Rick G. Robinson

OREGON
July 17, 1986
RICK G. ROBINSON
2219

Renewal Date, December 31, 2002

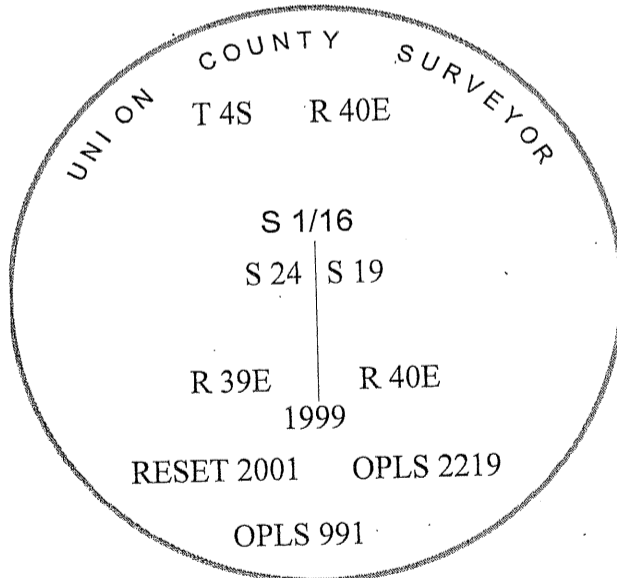

**UNION COUNTY
SURVEYOR**

Date Received 6/15/01

Date Filed 9/16/01

Filed By *[Signature]*

File Number 036-2001R

I used a Leica GPS system 500 in the establishment of the new accessories. Basis of Bearing is the same as Survey No. 032-1999. The distances are the center of each bearing object.

HORIZONTAL CONTROL DATA

UNION COUNTY, OREGON

OREGON STATE PLANE, NORTH ZONE (3601)

STA NAME: 200147

SOUTH 1/16 BETWEEN S24 & S19

TWP. 4 S. RGE. 39&40 E.

GEODETIC COORD: NAD 83(91)

DATE TIED: MAY 2001

LAT: 45 ° 11 ' 55.74875 " N

SURVEYOR: RICK G. ROBINSON

LONG: 117 ° 52 ' 13.98680 " W

OPLS 2219

FIRM: BAGETT, GRIFFITH, & BLACKMAN

SP. COOR: NAD 83(91)

2006 ADAMS AVENUE

LAGRANDE, OR 97850

(541) 963-6092

N: 569607.282

INT FT.

E: 8879747.962

INT FT.

TYPE: GPS

THETA: 1 ° 51 ' 53.1641963 "

ORDER: SECOND CLASS: 1

SCALE FACTOR: 0.9998947201

ELEV: 2761.42 US FT.

ELEV: DATUM: NGVD 29

COMMENTS:

This sheet replaces sheet 9306. The monument was out of position and has been moved.

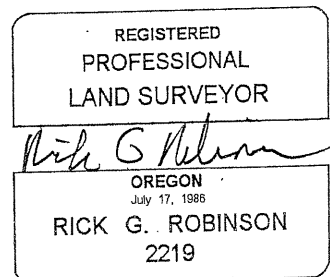
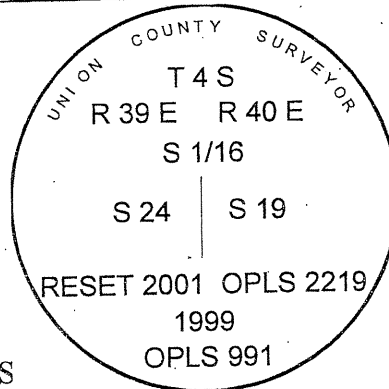

1 METER = 3.2808333333... US FEET = 39.37 INCHES

1 METER = 3.280839895 INT'L FEET OR 1 INCH = 2.54 CM

TO CALCULATE ELEVATION FACTOR (IN THE NORTH AMERICAN CONTINENT)

DIVIDE 20,906,000 BY (20,906,000 + ELLIPSOID ELEV. IN FEET)

Renewal Date December 31, 2002

CERTIFIED RECORD OF LAND CORNER MONUMENTATION

HISTORY OF ORIGINAL CORNER ESTABLISHMENT:

Corner Monumented June 24, 1999 by monumentation record 049-1999R which states: At proportionate position I set a 2 1/2"x30" aluminum monument marked as shown 30" in the ground from which: a 5/8"x30" iron rebar with aluminum cap marked NE RP bears N19°E, a distance of 22.85 feet; a 5/8"x30" iron rebar with aluminum cap marked SE RP bears S38°E, a distance of 25.10 feet; a 5/8"x30" iron rebar with aluminum cap marked SW RP bears S47°W, a distance of 43.00 feet; a 5/8"x30" iron rebar with aluminum cap marked NW RP bears N71°W, a distance of 19.30 feet;

Corner Monumented May 3, 2001 by monumentation record 036-2001R which states: Reset corner monument to true position as per survey number 032-1999 At proportionate position I set a 2 1/2"x30" aluminum monument marked as shown 30" in the ground from which: a 5/8"x30" iron rebar with aluminum cap marked SE RP bears S38°E, a distance of 27.44 feet; a 5/8"x30" iron rebar with aluminum cap marked SW RP bears S46°W, a distance of 44.78 feet; a 5/8"x30" iron rebar with aluminum cap marked NW RP bears N82°W, a distance of 18.36 feet; No evidence of original NE RP.

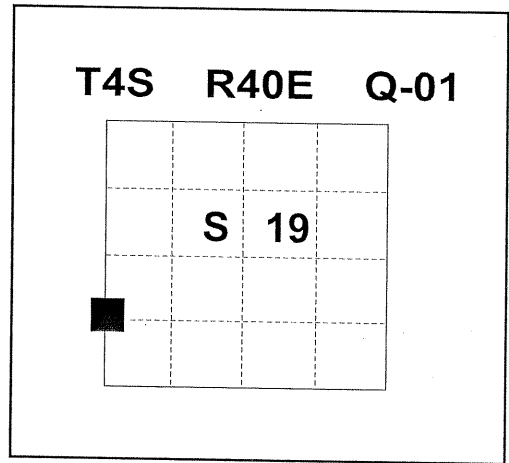

DESCRIPTION OF CORNER EVIDENCE FOUND:

Found 2 1/2" aluminum monument reset by monumentation record 036-2001R marked as shown: Found a 5/8"x30" iron rebar with aluminum cap marked SW RP bears S46°W, a distance of 44.78 feet; a 5/8"x30" iron rebar with aluminum cap marked NW RP bears N82°W, a distance of 18.36 feet; (NE and SE bearing objects could not be found).

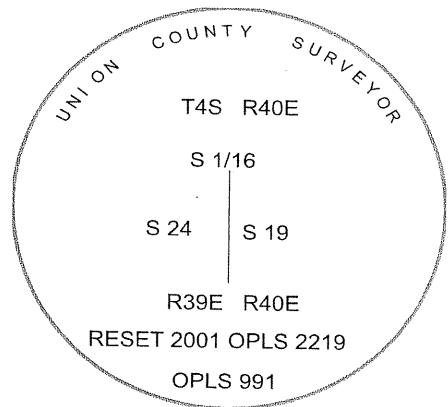

See Survey No. 055-2013

DESCRIPTION OF MONUMENT AND ACCESSORIES I ESTABLISHED TO PERPETUATE THE ORIGINAL LOCATION OF THIS CORNER:

This 1/16th corner position was originally placed by survey number 25-89, with that position being used and documented on survey number 046-1994, and partition plat numbers 1994-02, 1996-06 and 1996-22. Survey number 032-1999 monumented the corner, first at the position previously determined, then the monument was reset at proportionate position. I believe the correct position is that used by the previous surveys and partitions and replace the monument at that position. I cut the existing monument 3" below ground and left remaining pipe. At the position described above, I set a 5/8"x30" iron pin with 2 1/2" aluminum cap marked as shown, 28" in the ground from which:

OLD BEARING OBJECTS:

- A 5/8"x30" iron rebar with aluminum cap marked SW RP bears S47°W, a distance of 43.00 feet
- A 5/8"x30" iron rebar with aluminum cap marked NW RP bears N71°W, a distance of 19.30 feet;

I hereby certify that the corner was monumented on December 10, 2013

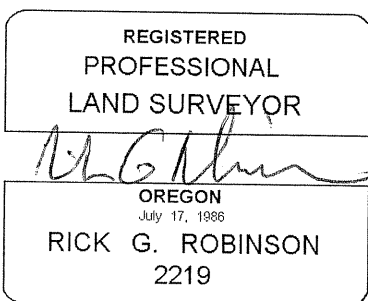

Renewal Date: December 31, 2014

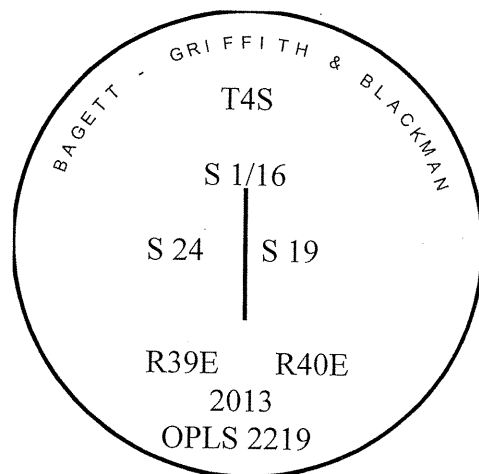

UNION COUNTY SURVEYOR

Date Received 12/11/13

Date Filed 12/11/13

Filed By [Signature] DEPUTY

File Number 449-2013R

I used a Leica GPS system 1200 in the establishment of the new accessories. Basis of Bearings is the same as Survey No. 054-1999. The distances are the center of each bearing object.