

CERTIFIED RECORD OF LAND CORNER MONUMENTATION

HISTORY OF ORIGINAL CORNER ESTABLISHED:

Corner originally established by David Thompson under GLO contract number 103 dated September 3, 1863. Surveyor General field notes state:

Set post for corner to secs. 16, 17, 20, and 21, in mound of earth with charred stake, pits, trench, as per instructions.

Corner noted by W.B. Blakeley in Old Book Survey number 186, page 315. Union County Survey record states: Corner to 17-16-20-21, rock in mound of rock 12 x 12 x 20

Corner found in 1938 by Union County Highway Department and tied in Union County Road record 20121. Record shows coordinate by local control.

T 4 S R 40 E N-09

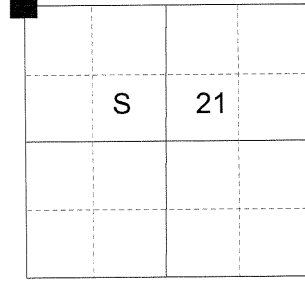

DESCRIPTION OF CORNER EVIDENCE FOUND:

None. Multiple rock piles exist along ancient fence lines in the area.

SEE SURVEY NUMBER 045-2019

DESCRIPTION OF MONUMENT AND ACCESSORIES I ESTABLISHED TO MONUMENT THE ORIGINAL LOCATION OF THIS CORNER:

At position by survey I set a 2 1/2" x 30" aluminum pipe, 26" in the ground, with a 2 1/2" aluminum cap marked as shown below, with 3' diam. mound of stone base to top of cap, from which:

NEW BEARING OBJECTS:

- A 5/8" x 15" iron pin bears North 46°42' East a dist. of 15.65 ft., with 1 1/2" aluminum cap marked NE RP.
- A 5/8" x 15" iron pin bears South 32°07' East a dist. of 17.73 ft., with 1 1/2" aluminum cap marked SE RP.
- A 5/8" x 30" iron pin bears South 31°04' West a dist. of 18.03 ft., with 1 1/2" aluminum cap marked SW RP.
- A 5/8" x 15" iron pin bears North 47°01' West a dist. of 14.21 ft., with 1 1/2" aluminum cap marked NW RP.

Set steel fence post approx. 2' East.

Fence corner to East/West/South bearing fence lines bears East South East approx. 60'.

I hereby certify that the corner was monumented on December 10, 2019.
Witness: Kyle A. Tucker

REGISTERED
PROFESSIONAL
LAND SURVEYOR



OREGON
June 2, 2010
JEFFREY S. HSU
83571

Renewal Date: June 30, 2021

**UNION COUNTY
SURVEYOR**

Date Received 12/31/19

Date Filed 12/31/19

Filed By N. G. Miller

File Number 079-209R

UNI ON C OUNTY SURVEY OR

T4S R40E

S17	S16
S20	S21

2019
OPLS 83571

I used a Leica GS18 RTK GPS for the establishment of the new accessories. Basis of bearings is as per Survey Number 045-2019. The distances and bearings are to the center of the aluminum caps.

HORIZONTAL CONTROL DATA

UNION COUNTY, OREGON

OREGON STATE PLANE, NORTH ZONE (3601)

STA NAME: 2020004

CORNER COMMON TO: SECTIONS 16,17,20, AND 21

TWP. 4 S. RGE. 40 E.

GEODETIC COORD: NAD 83(91)

DATE TIED: DECEMBER 31, 2019

LAT: 45 ° 12 ' 33.53122 " N

SURVEYOR: RICK G. ROBINSON
OPLS 2219

LONG: 117 ° 49 ' 46.66708 " W

FIRM: BAGETT, GRIFFITH, & BLACKMAN
2006 ADAMS AVENUE
LAGRANDE, OR 97850
(541) 963-6092

SP. COOR: NAD 83(91)

N: 573777.421 INT FT.

E: 8890163.954 INT FT.

TYPE: GPS

THETA: 1 ° 53 ' 37.6412825 "

ORDER: SECOND CLASS: 1

SCALE FACTOR: 0.9998948327

ELEV: 3193.60 US FT.

ELEV: DATUM: NGVD 29

COMMENTS:

Corner is a 2 ½" x 30" aluminum monument,
26" in the ground with mound of stone.

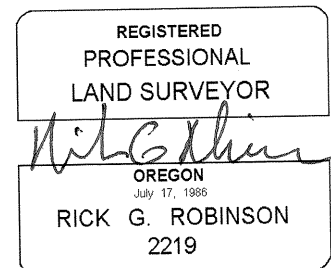
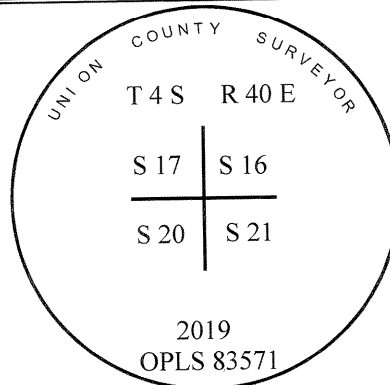

Renewal Date: December 31, 2020

1 METER = 3.280833333... US FEET = 39.37 INCHES

1 METER = 3.280839895 INT'L FEET OR 1 INCH = 2.54 CM

TO CALCULATE ELEVATION FACTOR (IN THE NORTH AMERICAN CONTINENT)

DIVIDE 20,906,000 BY (20,906,000 + ELLIPSOID ELEV. IN FEET)