

CERTIFIED RECORD OF LAND CORNER MONUMENTATION

HISTORY OF ORIGINAL CORNER ESTABLISHED:

Corner originally established by David T. Thompson under GLO contract No. 103, dated September 3rd. 1863. Surveyor General's field notes state:
Set post for 1/4 sec. corner in mound of stone.

T 4 S R 40 N-07

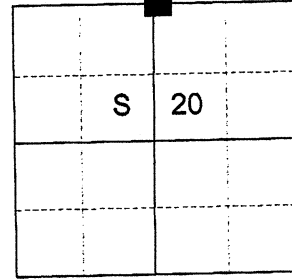

DESCRIPTION OF CORNER EVIDENCE FOUND:

Found an ancient rock jack with mound of stone. I find the proximate position harmonious with a proportionate position and accept the position as the best available evidence of the original corner position.

SEE SURVEY NUMBER 014-2024

DESCRIPTION OF MONUMENT AND ACCESSORIES I

ESTABLISHED TO MONUMENT THE ORIGINAL LOCATION OF THIS CORNER:

Set a 5/8" x 30" iron pin, 28" in the ground, with 2 1/2" aluminum cap marked as shown below, and in a 2 ft. diam. collar of stone, from which:

NEW BEARING OBJECTS:

A 5/8" X 15" iron pin bears North 56°06' East, a distance of 26.19 feet, with 1 1/2" aluminum cap marked NE RP "BGB SURVEY MARKER".

A 5/8" X 15" iron pin bears South 66°03' East, a distance of 26.82 feet, with 1 1/2" aluminum cap marked SE RP "BGB SURVEY MARKER".

A 5/8" X 15" iron pin bears South 29°28' West, a distance of 17.78 feet, with 1 1/2" aluminum cap marked SW RP "BGB SURVEY MARKER".

A 5/8" X 15" iron pin bears North 48°19' West, a distance of 14.97 feet, with 1 1/2" aluminum cap marked NW RP "BGB SURVEY MARKER".

Set steel fence post approx. 0.3 ft. West.

Fence corner to North/East/Southwesterly running fence lines bears approx. 18 ft. North.

Witness: Kyle Tucker

I hereby certify that the corner was monumented on March 19, 2024.

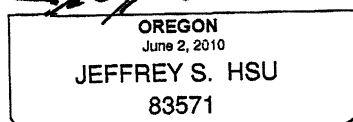
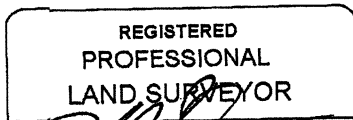
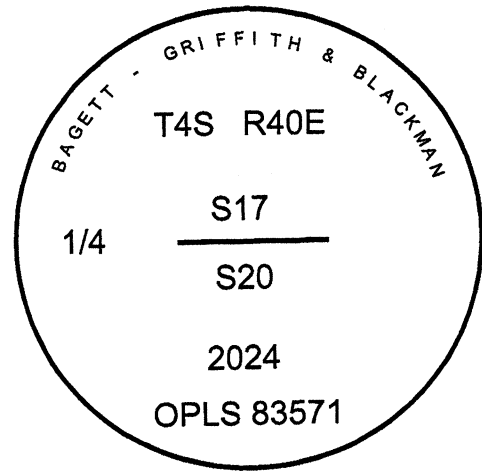

Renewal Date: June 30, 2025

I used a Leica GS-18 RTK in the establishment of the accessories. Basis of Bearing is as per Union County Survey 014-2024

UNION COUNTY SURVEYOR	
Date Received	<u>3/26/24</u>
Date Filed	<u>3/26/24</u>
Filed By	<u>[Signature]</u>
File Number	<u>001-2024R</u>

N-07