

CERTIFIED RECORD OF LAND CORNER MONUMENTATION

HISTORY OF ORIGINAL CORNER ESTABLISHMENT:

Corner originally established by David P. Thompson. GLO contract number 103, dated September 3, 1882. Surveyor General Record states:
Set a wooden post and raised mound of earth.

No subsequent monumentation found in Union County survey records.

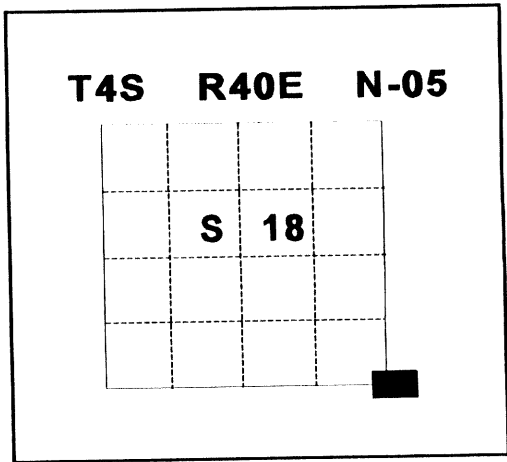

DESCRIPTION OF CORNER EVIDENCE FOUND:
None

See Union County Survey Number 017-1997.

DESCRIPTION OF MONUMENT AND ACCESSORIES I ESTABLISHED TO PERPETUATE THE ORIGINAL LOCATION OF THIS CORNER:

At position determined by survey I set a 2½"x30" aluminum pipe with 2½" aluminum cap, marked as shown, 44" in ground (corner falls in cultivated field), from which:

NEW BEARING OBJECTS:

- A 5/8" x 30" rebar bears S41°54'W, 7.69 feet, with 1½" aluminum cap marked UNION COUNTY SURVEYOR SW RP, buried 12".
- A 5/8" x 30" rebar bears S74°35'E, 230.72 feet, with 1½" aluminum cap marked UNION COUNTY SURVEYOR SE RP, in SE-NW fence line.
- A 5/8" x 30" rebar bears N36°59'E, 156.54 feet, with 1½" aluminum cap marked UNION COUNTY SURVEYOR NE RP, in SE-NW fence line.
- A 5/8" x 30" rebar bears N82°58'W, 7.26 feet, with 1½" aluminum cap marked UNION COUNTY SURVEYOR NW RP, buried 12".

I hereby certify that the corner was monumented on June 19, 1997
Witness: Jeff Madsen, Gregory T. Blackman Jr., Jeff Petersen

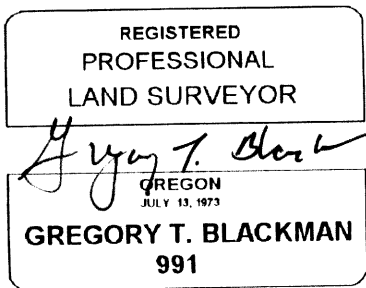

Renewal Date: December, 31 1997

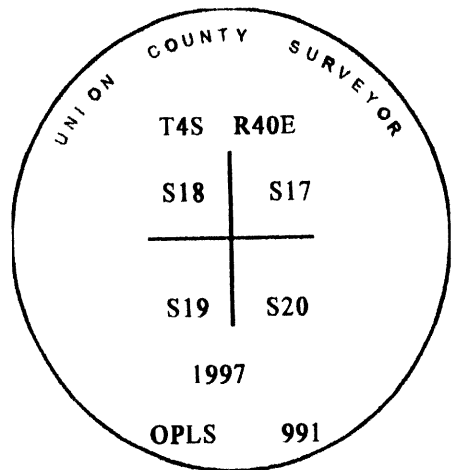

UNION COUNTY SURVEYOR

Date Surveyed 7-10-97

Date of Survey 7-10-97

J. Petersen

File No. 008-1997 R

I used a total station theodolite in the establishment of the new accessories. Basis of bearing is survey 017-1997. The distances are to the center of the aluminum caps.

**HORIZONTAL CONTROL DATA
UNION COUNTY, OREGON
OREGON STATE PLANE, NORTH ZONE (3601)**

STA NAME: 200118

CORNER COMMON TO: 17,18,19,& 20

TWP. 4 S. RGE. 40 E.

GEODETIC COORD: NAD 83(91)

DATE TIED: 15 FEB. 2001

LAT: 45 ° 12 ' 34.82620 " N

SURVEYOR: GREGORY T. BLACKMAN
OPLS 991

LONG: 117 ° 51 ' 0.07149 " W

FIRM: BAGETT, GRIFFITH, & BLACKMAN
2006 ADAMS AVENUE
LAGRANDE, OR 97850
(541) 963-6092

SP. COOR: NAD 83(91)

N: 573735.505 INT FT.

E: 8884907.701 INT FT.

TYPE: GPS

THETA: 1 ° 52 ' 45.5838986 "

ORDER: SECOND CLASS: 1

SCALE FACTOR: 0.9998948371

ELEV: 2821.77 US FT.

ELEV: DATUM: NGVD 29

COMMENTS:

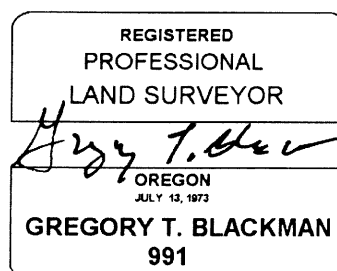

Renewal Date: Dec. 31, 2001

1 METER = 3.280833333... US FEET = 39.37 INCHES

1 METER = 3.280839895 INT'L FEET OR 1 INCH = 2.54 CM

TO CALCULATE ELEVATION FACTOR (IN THE NORTH AMERICAN CONTINENT)

DIVIDE 20,906,000 BY (20,906,000 + ELLIPSOID ELEV. IN FEET)