

CERTIFIED RECORD OF LAND CORNER MONUMENTATION

HISTORY OF ORIGINAL CORNER ESTABLISHED:

Corner originally established by John H. Stone under GLO contract number 235, dated July 6, 1875. Surveyor General record states:

Set a stone 16x14x9 for Cor to Secs 11, 12, 13 & 14 as per instructions.

In Union County Highway Department survey of Union-High Valley Market Road No. 3, executed by S.B. Morgan, dated October 1938, the alignment of High Valley Road is tied to corner. Monument is not described.

DESCRIPTION OF CORNER MONUMENT FOUND:

No original corner or evidence found. Position established by retracement of High Valley Road.

T 4 S R 40 E J-21

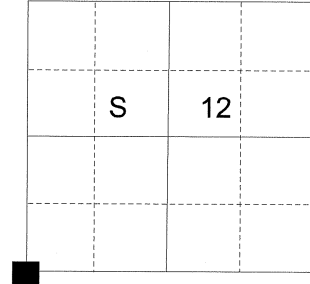

SEE SURVEY NUMBER 030-2014

DESCRIPTION OF MONUMENT AND ACCESSORIES I ESTABLISHED

TO PERPETUATE THE ORIGINAL LOCATION OF THIS CORNER:

At position determined by retracement of High-Valley Road, I set a 5/8" x 15" iron rod with a 2 1/2" aluminum cap marked as shown below, 15" in the ground, to bedrock, from which:

- A 5/8" x 15" iron pin bears N 51° E, a distance of 28.00 feet, with a 1 1/2" aluminum cap marked BGB SURVEY MARKER NE RP.
- A 5/8" x 15" iron pin bears S 26° E, a distance of 42.15 feet, with a 1 1/2" aluminum cap marked BGB SURVEY MARKER SE RP.
- A 5/8" x 15" iron pin bears S 14° W, a distance of 41.30 feet, with a 1 1/2" aluminum cap marked BGB SURVEY MARKER SW RP.
- A 5/8" x 15" iron pin bears N 48° W, a distance of 29.20 feet, with a 1 1/2" aluminum cap marked BGB SURVEY MARKER NW RP.

Corner monument falls North of gravel road approximately 70 feet East of gate.

Set a steel fencepost +/- 1 feet North of corner monument.

I hereby certify that the corner was monumented on October 29, 2014.

Witness: Thomas J. Kopp

REGISTERED
PROFESSIONAL
LAND SURVEYOR



OREGON
June 2, 2010
JEFFREY S. HSU
83571

Renewal Date: June 30, 2015

BAGETT - GRIFFITH & BLACKMAN

T4S R40E

S11	S12
S14	S13

2014
OPLS 83571

UNION COUNTY
SURVEYOR

Date Received 10/30/14

Date Filed 10/30/14

Filed By Neil G. Klein

File Number 061-201412

I use a Leica GS15 RTK GPS in the establishment of the new accessories. Basis of bearing is as per survey number 030-2014.

HORIZONTAL CONTROL DATA

UNION COUNTY, OREGON

OREGON STATE PLANE, NORTH ZONE (3601)

STA NAME: 201424

SECTION CORNER COMMON TO SECTIONS 11, 12, 13 AND 14

TWP. 4 S. RGE. 40 E.

GEODETIC COORD: NAD 83(91)

DATE TIED: October 30, 2014

LAT: 45 ° 13 ' 24.21224 " N

SURVEYOR: RICK G. ROBINSON
OPLS 2219

LONG: 117 ° 46 ' 3.63502 " W

FIRM: BAGETT, GRIFFITH, & BLACKMAN
2006 ADAMS AVENUE
LAGRANDE, OR 97850
(541) 963-6092

SP. COOR: NAD 83(91)

N: 579440.832 INT FT.

E: 8905947.673 INT FT.

TYPE: GPS

THETA: 1 ° 56 ' 15.812502 "

ORDER: SECOND CLASS: 1

SCALE FACTOR: 0.9998950363

ELEV: 3490.57 US FT.

ELEV: DATUM: NGVD 29

COMMENTS:

2 1/2" aluminum cap on 5/8" iron pin
North of road 70 ft.+/- East of gate

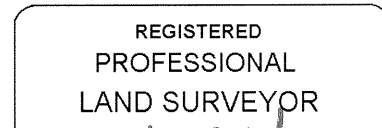
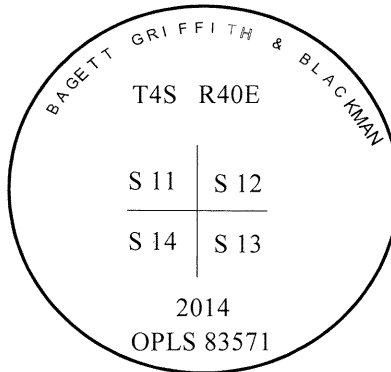

Rick G. Robinson
OREGON
July 17, 1986
RICK G. ROBINSON
2219

Renewal Date: December 31, 2014

1 METER = 3.2808333333... US FEET = 39.37 INCHES

1 METER = 3.280839895 INT'L FEET OR 1 INCH = 2.54 CM

TO CALCULATE ELEVATION FACTOR (IN THE NORTH AMERICAN CONTINENT)

DIVIDE 20,906,000 BY (20,906,000 + ELLIPSOID ELEV. IN FEET)