

**CERTIFIED RECORD OF LAND CORNER MONUMENTATION**

**History of original corner establishment:**

Corner originally established by Timothy W. Davenport under GLO contract number 102, dated July 20, 1863. Surveyor General record states:

Set post corner to secs 7, 18, 12 & 13. Made mound of earth and drove charred stake as per instructions.

Corner remonumented by Union County Surveyor J.W. Kimbrell on survey number 35, done in 1888, recorded in the old book of surveys on page 64. His record states:

Set a stone marked for cor to sec 7=18=12=13

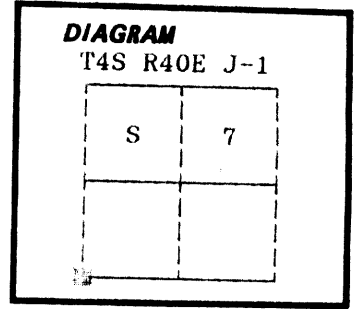

Survey number 14-71 by Harvey Barber, OPLS 679, did not find this stone and established the corner position in an existing East-West fenceline and 9.5 feet East of the fence corner.

Corner stone was found by Gregory T. Blackman, OPLS 991, on survey number 31-87, but not monumented at that time.

No record of subsequent monumentation found in Union County survey records.

**Description of corner evidence found:**

Found a stone 7x14x24 inches marked with a chiseled 1 inch cross on top, with a mound of stone 1 ft. below the ground.

Corner falls in an existing East-West fenceline and approximately 9 feet West of the fence corner.

**Description of monument and accessories I established to perpetuate the**

**original location of this corner:** In place of the found Kimbrell corner stone, I set a 2½" x 30" aluminum pipe with aluminum cap marked as shown, 29 inches in the ground.

Buried the original corner stone South and alongside of monument, with the top downward.

I hereby certify that the above corner point was perpetuated as hereon described on January 26, 1988.

Witness: Rick Robinson

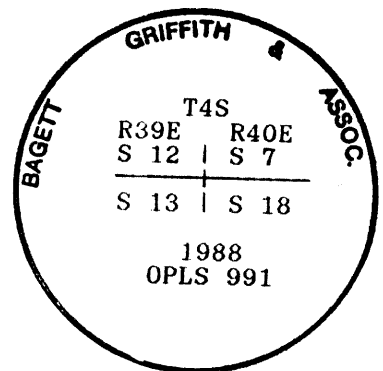

**REGISTERED  
PROFESSIONAL  
LAND SURVEYOR**

*Gregory T. Blackman*

**OREGON**  
JULY 13, 1973  
**GREGORY T. BLACKMAN**  
991

**UNION COUNTY  
SURVEYOR**

---

Date Received 3-14-88

Filed 3-16-88

G. LANGLITZ DEPUTY

File No. 62-88 R

Office of..... County of.....  
State of....., I hereby certify that the within instrument was filed in this office  
for record on the..... day of....., 19.....  
..... by .....  
(COUNTY OFFICIAL) (DEPUTY)

**GEODETTIC CONTROL DATA**

**OREGON STATE PLANE, NORTH ZONE (3601)  
UNION COUNTY, OREGON**

\*\*\*\*\*

STA. NAME: 9922

SECTION CORNER:

T4S SEC 12 | 7 T4S  
R39E SEC.13 | 18 R40E  
UNION COUNTY, OREGON  
DATE TIED: JULY, 1999

GEODETTIC COOR: NAD 83(91)

LAT: 45:13'27.24335" N

LONG: 117:52'14.03051" W

SURVEYOR: WALTER L. CASWELL  
PLS 737

SP. COOR: NAD 83(91)

N: 578868.155 INT.FT

FIRM: EAGLE GPS SURVEY CORP  
6110 SW LOMBARD AVE.  
BEAVERTON, OR. 97008-4736  
(503) 643-1073

E: 8879443.319 INT.FT.

THETA: 1:51'53.133"

TYPE: GPS

SCALE FACTOR: 0.999895050

ORDER: SECOND CLASS: 1

ELEV: 2764.85 U.S.FT.

ELEV. DATUM: NGVD 1929(1947)

\*\*\*\*\*

DIRECTIONS "TO REACH":

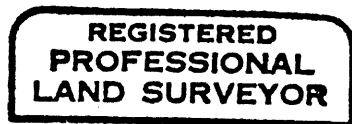

*Albert Hertel 10-14-99*



EXPIRES: 06/30/01

1 METER = 3.280833... U.S. FEET = 39.37 INCHES EXACTLY  
1 METER = 3.280839895 INTL. FEET OR 1 INCH = 2.54CM. EXACTLY  
TO CALCULATE ELEVATION FACTOR (IN THE NORTH AMERICAN CONTINENT)  
DIVIDE 20,906,000 BY (20,906,000 + ELLIPSOID ELEV. IN FEET)

JOB 99-005  
SHEET 40 OF 63