

CERTIFIED RECORD OF LAND CORNER MONUMENTATION

HISTORY OF ORIGINAL CORNER ESTABLISHMENT:

Corner originally established by Timothy W. Davenport under GLO contract Number 102, dated July 20, 1863. Surveyor General record states: Set post in mound of earth for sec.cor. dug pits.

Corner remonumented by Harvey L. Barber in 1971, Map of Survey No. 14-71, (014-1971). Barber states "set a 1-1/2" X 15" iron shaft in center of road 3 feet south of a concrete culvert."

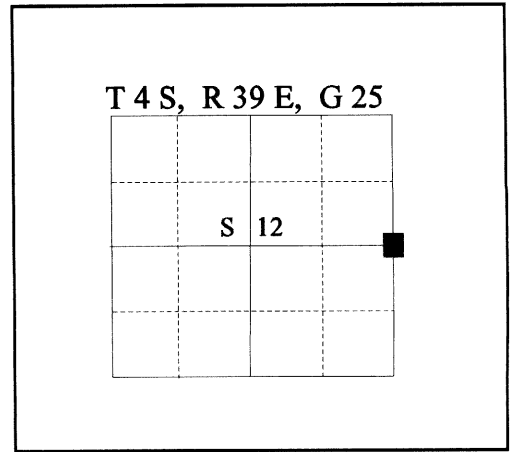

No record of subsequent monumentation found in Union County survey records
DESCRIPTION OF CORNER EVIDENCE FOUND:

Found steel pipe, 1-1/2" X 12" in the center of the road.

DESCRIPTION OF MONUMENT AND ACCESSORIES I ESTABLISHED TO PERPETUATE THE ORIGINAL LOCATION OF THIS CORNER:

In place of pipe I set a 2 1/2" x 30" aluminum pipe with aluminum cap marked as shown, 36 inches in the ground, 6" below the road surface, from which;

BEARING OBJECTS:

- A Concrete culvert corner, north of ditch, bears N66°E, 18.70 ft, marked X
- A 5/8" X 30" rebar with aluminum cap bears S31°E, 38.65 ft. marked SE RP
- A 11" telephone pole bears S20°E, 59.21 ft. to a 60d spike on the NW face.
- A Concrete culvert corner, north of ditch, bears N77°W, 32.45 ft, marked X

Buried pipe inside monument.

Witnesses: Jim Bennett Pete Crabtree

Corner remonumented 6-25-1993.

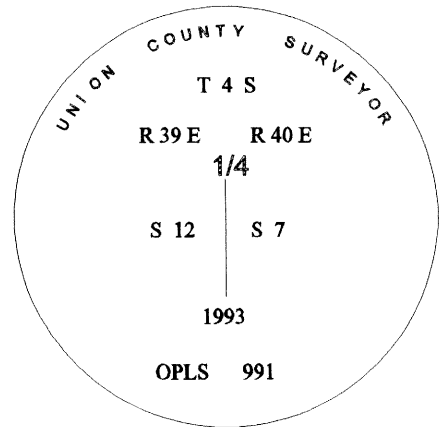

REGISTERED
 PROFESSIONAL
 LAND SURVEYOR

Gregory T. Blackman
 OREGON
 JULY 13, 1973
GREGORY T. BLACKMAN
 991

Renewal Date: December, 31 1997

I used a steel tape and magnetic compass in the establishment of the new accessories. I used 20° East declination, the distances are to a to the center of the aluminum cap, (on rebars), to the X, or as noted.

UNION COUNTY
 SURVEYOR

Date Received 4-18-96
 Date Filed 4-18-96
 By R. ROBINSON, DEPUTY
 File No. 041-1996R

G-1
 G-25

HORIZONTAL CONTROL DATA

UNION COUNTY, OREGON
OREGON STATE PLANE, NORTH ZONE (3601)

STA. NAME: 9309

QUARTER CORNER: 12 / 7

TWP. 4 S. RGE.39 & 40 E.

DATE SET: OCT. 1993

SURVEYOR: WALTER L. CASWELL
PLS 737

FIRM: EAGLE GPS SURVEY CORP
13545 NW SCIENCE PARK DR
PORTLAND, OR. 97229
(503) 643-1073

TYPE: GPS

ORDER: SECOND CLASS: 1

GEODETIC COOR: NAD 83(91)

LAT: 45°13'53.40733" N

LONG: 117°52'13.94973" W

SP. COOR: NAD 83(91)

N: 581516.638 INT.FT.

E: 8879362.874 INT.FT.

THETA: 1°51'53.190"

SCALE FACTOR: 0.999895181

ELEV: 2752.33 US.FT.

ELEV. DATUM: NGVD 29

DIRECTIONS "TO REACH": FROM THE INTERSECTION OF HWY 203 AND NORTH
1ST STREET (WEAVER ROAD), GO NORTH ON WEAVER ROAD, 0.65 MILES.
WEAVER ROAD WILL TURN AND GO WEST FOR 0.2 MILES, AND THEN TURN
NORTH AGAIN. AFTER TURNING BACK TO THE NORTH, GO 0.3 MILES AND
STOP. YOU SHOULD SEE A COUPLE OF TREES ON YOUR RIGHT, SOME CLOSE
TO AND SOME IN A FENCE LINE WHICH RUNS TO THE
EAST AND THE WEST. THE CORNER IS IN THE MIDDLE
OF THE ROAD, VERY CLOSE TO BEING ON LINE WITH
THE EAST WEST FENCE LINE. THE MONUMENT IS A
5/8" IRON REBAR WITH A 2 1/2" ALUMINUM CAP 10
INCHES BENEATH THE SURFACE OF THE GRAVEL ROAD.

REGISTERED
PROFESSIONAL
LAND SURVEYOR

Walter Caswell

OREGON
JULY 8, 1966
WALTER L. CASWELL
737

EXPIRES 12/31/95

1 METER = 3.280833333333... U.S. FEET = 39.37 INCHES
1 METER = 3.280839895 INT'L FEET OR 1 INCH = 2.54 CM.
TO CALCULATE ELEVATION FACTOR (IN THE NORTH AMERICAN CONTINENT)
DIVIDE 20,906,000 BY (20,906,000 + ELLIPSOID ELEV. IN FEET)
SHEET 10 OF 37

GEODETTIC CONTROL DATA

**OREGON STATE PLANE, NORTH ZONE (3601)
UNION COUNTY, OREGON**

STA. NAME: 9309

QUARTER CORNER

GEODETTIC COOR: NAD 83(91)

SEC. 12 | 7

LAT: 45:13'53.40733" N

T4S,R39E | T4S,R40E

UNION COUNTY, OREGON

LONG: 117:52'13.94973" W

DATE TIED: JULY, 1999

SURVEYOR: WALTER L. CASWELL
PLS 737

SP. COOR: NAD 83(91)

N: 581516.638 INT.FT

FIRM: EAGLE GPS SURVEY CORP
6110 SW LOMBARD AVE.
BEAVERTON, OR. 97008-4736
(503) 643-1073

E: 8879362.874 INT.FT.

THETA: 1:51'53.190"

TYPE: GPS

SCALE FACTOR: 0.999895181

ORDER: SECOND CLASS: 1

ELEV: 2752.33 U.S.FT.

ELEV. DATUM: NGVD 1929(1947)

DIRECTIONS "TO REACH":



Albert Hertel 10-14-99



EXPIRES: 06/30/01

1 METER = 3.280833... U.S. FEET = 39.37 INCHES EXACTLY
1 METER = 3.280839895 INTL. FEET OR 1 INCH = 2.54CM. EXACTLY
TO CALCULATE ELEVATION FACTOR (IN THE NORTH AMERICAN CONTINENT)
DIVIDE 20,906,000 BY (20,906,000 + ELLIPSOID ELEV. IN FEET)