

CERTIFIED RECORD OF LAND CORNER MONUMENTATION

HISTORY OF ORIGINAL CORNER ESTABLISHED:

Corner not previously established

T 4 S R 40 E B-23

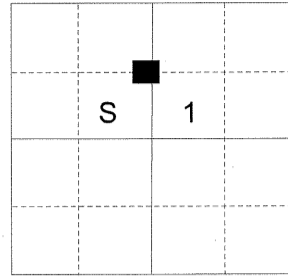

DESCRIPTION OF CORNER EVIDENCE FOUND:

None

See Survey Number 022-2015

DESCRIPTION OF MONUMENT AND ACCESSORIES I ESTABLISHED TO PERPETUATE THE ORIGINAL LOCATION OF THIS CORNER:

At a position determined by survey, I set a 5/8" x 30" iron rod with a 2 1/2" aluminum cap marked as shown below, 30" in the ground. From which:

NEW BEARING OBJECTS:

A 16" Ponderosa Pine bears South 26° West, a distance of 35.05 feet, marked CN 1/16 S1 BT.

A 23" Ponderosa Pine bears North 18° West, a distance of 17.95 feet, marked CN 1/16 S1 BT.

I set a steel fencepost approximately 1 foot North of corner monument.

I hereby certify that the corner was monumented on April 22, 2015.

Witness: Thomas J. Kopp



Renewal Date: June 30, 2017

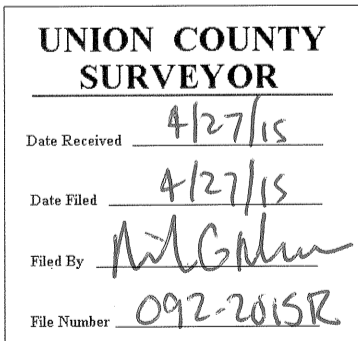
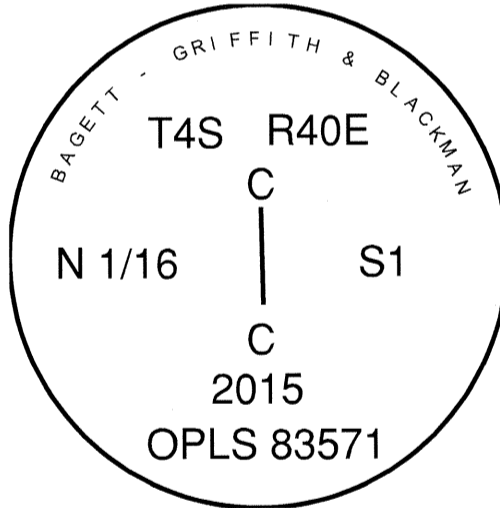

I used a steel tape and magnetic compass in the establishment of the new accessories. I used 16° East declination, the distances are to a 60d spike driven into the right side of the root crown of the bearing trees. A brass washer marked OPLS 83571 is attached to the BT blaze of the new bearing trees.