

CERTIFIED RECORD OF LAND CORNER MONUMENTATION

HISTORY OF ORIGINAL CORNER ESTABLISHMENT:

Corner originally established by David P. Thompson under GLO contract Number 103, dated 1863. Surveyor General record states:

Set a post for corner to Secs 23, 24, 25, and 26 in a mound of earth with charcoal stakes, pits, and trenches as per instructions.

DESCRIPTION OF CORNER EVIDENCE FOUND:

Existing fence corner

See Survey No. 032-1999

DESCRIPTION OF MONUMENT AND ACCESSORIES I ESTABLISHED TO PERPETUATE THE ORIGINAL LOCATION OF THIS CORNER:

At the fence corner I set a 2½" x 30" aluminum monument with aluminum cap marked as shown, 27 inches in the ground from which:

BEARING OBJECTS:

- A 5/8" x 30" Iron rebar with aluminum cap bears N35°E, 8.29 feet marked NE RP.
- A 5/8" x 30" Iron rebar with aluminum cap bears S 48°E, 4.74 feet marked SE RP.
- A 5/8" x 30" Iron rebar with aluminum cap bears S 37°W, 4.77 feet marked SW RP.
- A 5/8" x 30" Iron rebar with aluminum cap bears N 39°W, 7.95 feet marked NW RP.

I hereby certify that the corner was monumented on June 9, 1999.
Witnesses: Greg Blackman Jr. Norb Volny

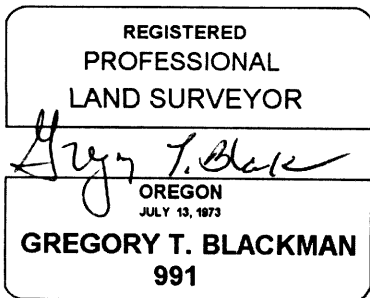
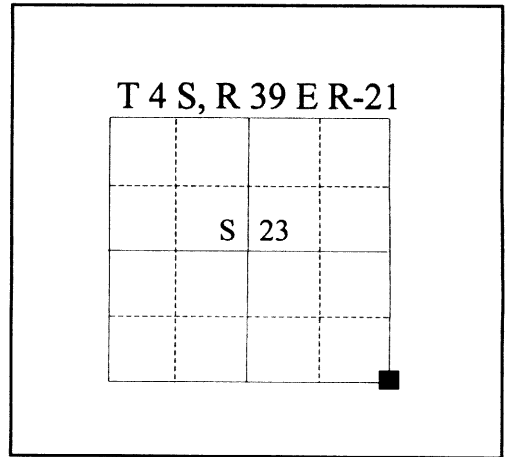

Renewal Date: December, 31 1997

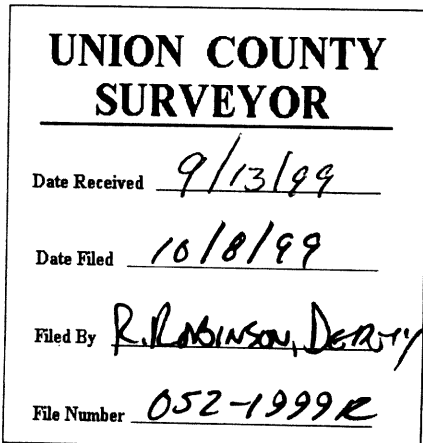
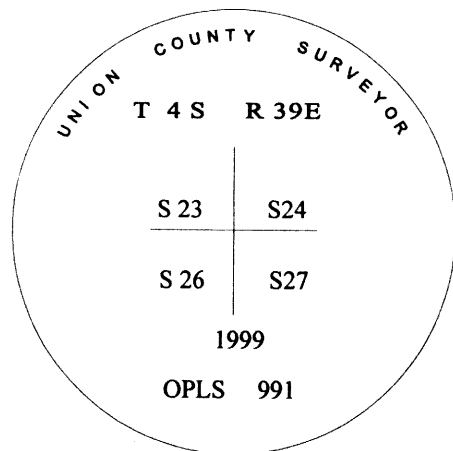

I used a Leica TCA-1100 Total Station and circular prism in the establishment of the new accessories. The Basis of Bearings is the same as Survey No. 032-1999, the distances are to the center of each bearing object, unless otherwise noted.

GEODETTIC CONTROL DATA

**OREGON STATE PLANE, NORTH ZONE (3601)
UNION COUNTY, OREGON**

STA. NAME: 9940

SECTION CORNER:

SEC 23 | 24

SEC.26 | 25 T.4 S. R.39 E

UNION COUNTY, OREGON

DATE TIED: JULY, 1999

GEODETTIC COOR: NAD 83(91)

LAT: 45:11'42.26545" N

LONG: 117:53'28.77853" W

SURVEYOR: WALTER L. CASWELL
PLS 737

SP. COOR: NAD 83(91)

N: 568068.941 INT.FT

FIRM: EAGLE GPS SURVEY CORP
6110 SW LOMBARD AVE.
BEAVERTON, OR. 97008-4736
(503) 643-1073

E: 8874439.760 INT.FT.

THETA: 1:51'00.122"

TYPE: GPS

SCALE FACTOR: 0.999894688

ORDER: SECOND CLASS: 1

ELEV: 2728.47 U.S.FT.

ELEV. DATUM: NGVD 1929(1947)

DIRECTIONS "TO REACH":

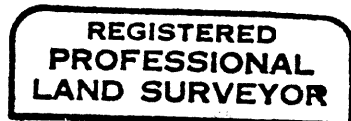

EXPIRES: 06/30/01

1 METER = 3.280833... U.S. FEET = 39.37 INCHES EXACTLY
1 METER = 3.280839895 INTL. FEET OR 1 INCH = 2.54CM. EXACTLY
TO CALCULATE ELEVATION FACTOR (IN THE NORTH AMERICAN CONTINENT)
DIVIDE 20,906,000 BY (20,906,000 + ELLIPSOID ELEV. IN FEET)

JOB 99-005
SHEET 57 OF 63