

**CERTIFIED RECORD OF LAND CORNER MONUMENTATION**

**HISTORY OF ORIGINAL CORNER ESTABLISHMENT:**

Corner originally established by David P. Thompson under GLO contract Number 103, dated 1863. Surveyor General record states:

Set post for corner to Secs 22, 23, 26, and 27 in a mound of earth with charcoal stakes, pits, and trenches as per instructions.

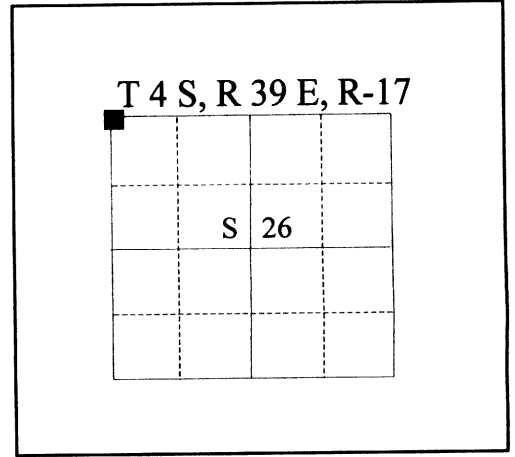

**DESCRIPTION OF CORNER EVIDENCE FOUND:**

Existing fence corner and a topographic call spring as called in original GLO notes.

See Survey No. 032-1999

**DESCRIPTION OF MONUMENT AND ACCESSORIES I ESTABLISHED**

**TO PERPETUATE THE ORIGINAL LOCATION OF THIS CORNER:**

At existing fence corner, I set a 2½" x 30" aluminum monument with aluminum cap marked as shown, 26 inches in the ground, raised 1 ft. diameter rock mound from which:

**BEARING OBJECTS:**

A 5/8" x 30" Iron rebar with aluminum cap bears N 28°E, 11.30 feet marked NE RP.

A 5/8" x 30" Iron rebar with aluminum cap bears S 47°E, 23.77 feet marked SE RP.

A 5/8" x 30" Iron rebar with aluminum cap bears S 37°W, 19.12 feet marked SW RP.

A 5/8" x 30" Iron rebar with aluminum cap bears N 54°W, 9.26 feet marked NW RP.

Witnesses: Greg Blackman Jr. Norb Volny, June 9, 1999.

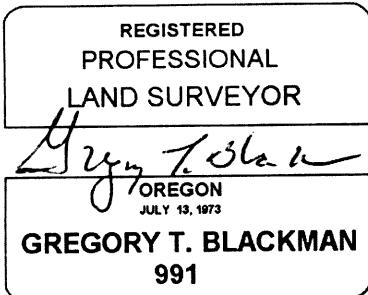

Renewal Date: December, 31 1997

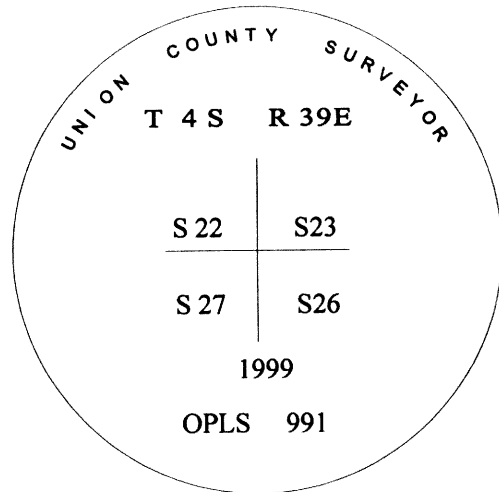

**UNION COUNTY SURVEYOR**

Date Received 9/13/99

Date Filed 10/8/99

Filed By R. Robinson Deputy

File Number 050-1999R

I used a steel tape and magnetic compass in the establishment of the new accessories. I used 17½° East declination, the distances are to the center of each bearing object, unless otherwise noted.

**GEODETTIC CONTROL DATA**

**OREGON STATE PLANE, NORTH ZONE (3601)  
UNION COUNTY, OREGON**

\*\*\*\*\*  
STA. NAME: 9938

SECTION CORNER:  
SEC 22 | 23  
SEC.27 | 26 TWP.4 S. RGE.39 E  
UNION COUNTY, OREGON  
DATE TIED: JULY, 1999

GEODETTIC COOR: NAD 83(91)  
LAT: 45:11'41.69041" N  
LONG: 117:54'43.51209" W

SURVEYOR: WALTER L. CASWELL  
PLS 737

SP. COOR: NAD 83(91)

FIRM: EAGLE GPS SURVEY CORP  
6110 SW LOMBARD AVE.  
BEAVERTON, OR. 97008-4736  
(503) 643-1073

N: 567838.664 INT.FT  
E: 8869093.109 INT.FT.  
THETA: 1:50'07.122"

TYPE: GPS

SCALE FACTOR: 0.999894687

ORDER: SECOND CLASS: 1

ELEV: 3113.72 U.S.FT.

ELEV. DATUM: NGVD 1929(1947)

\*\*\*\*\*  
DIRECTIONS "TO REACH":

REGISTERED  
PROFESSIONAL  
LAND SURVEYOR

*Albert Hertel* / 10-14-99  
OREGON  
JULY 18, 1980  
ALBERT HERTEL  
1896

EXPIRES: 06/30/01  
1 METER = 3.280833... U.S. FEET = 39.37 INCHES EXACTLY  
1 METER = 3.280839895 INTL. FEET OR 1 INCH = 2.54CM. EXACTLY  
TO CALCULATE ELEVATION FACTOR (IN THE NORTH AMERICAN CONTINENT)  
DIVIDE 20,906,000 BY (20,906,000 + ELLIPSOID ELEV. IN FEET)

JOB 99-005  
SHEET 55 OF 63