

CERTIFIED RECORD OF LAND CORNER MONUMENTATION

HISTORY OF ORIGINAL CORNER ESTABLISHMENT:

Corner originally established by David P. Thompson under GLO contract Number 103, dated 1863. Surveyor General record states:

Set post for 1/4 corner in mound of earth, with charred stake, pits, trenches, as per instructions

DESCRIPTION OF CORNER EVIDENCE FOUND:

NONE

See Survey No. 032-1999

DESCRIPTION OF MONUMENT AND ACCESSORIES I ESTABLISHED TO PERPETUATE THE ORIGINAL LOCATION OF THIS CORNER:

At proportionate position determined by survey, I set a 2 1/2" x 30" aluminum monument with aluminum cap marked as shown, 42" in the ground, from which:

NEW BEARING OBJECTS:

A 5/8" x 30" Iron rebar with aluminum cap marked NE RP bears N 62°E, a distance of 9.32 feet.

A 5/8" x 30" Iron rebar with aluminum cap marked SE RP bears S 27°E, a distance of 11.43 feet.

A 5/8" x 30" Iron rebar with aluminum cap marked SW RP bears S 17°W, a distance of 28.38 feet.

A 5/8" x 30" Iron rebar with aluminum cap marked NW RP bears N 51°W, a distance of 8.34 feet.

I hereby certify that the corner was monumented on June 15, 1999
Witness: Gregory T. Blackman Jr. and Norb Volny

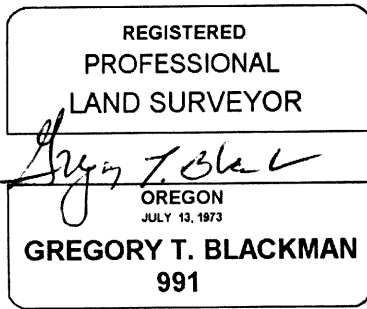
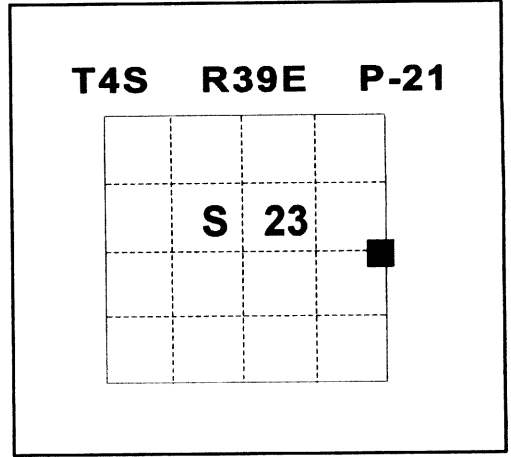

Renewal Date: December, 31 1999

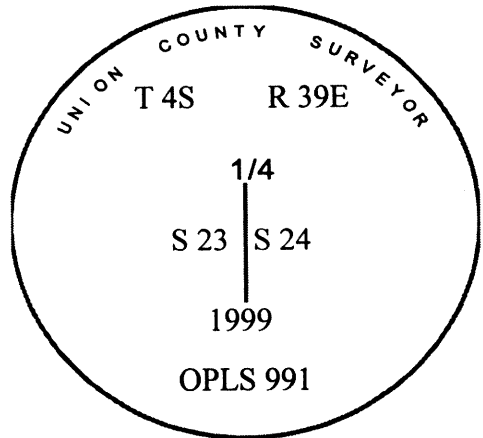

UNION COUNTY SURVEYOR

Date Received 9/13/99

Date Filed 10/8/99

Filed By R. Robinson, Deputy

File Number 047-1999R

I used a Leica TCA-1100 Total Station and circular prism in the establishment of the new accessories. The basis of bearings is the same as Survey No. 032-1999. The distances are the center of each bearing object, unless otherwise noted above.

GEODETTIC CONTROL DATA

**OREGON STATE PLANE, NORTH ZONE (3601)
UNION COUNTY, OREGON**

STA. NAME: 9934

QUARTER CORNER:

SEC 23 | 24

TWP.4 S. RGE.39 E

UNION COUNTY, OREGON

DATE TIED: JULY, 1999

SURVEYOR: WALTER L. CASWELL
PLS 737

FIRM: EAGLE GPS SURVEY CORP
6110 SW LOMBARD AVE.
BEAVERTON, OR. 97008-4736
(503) 643-1073

TYPE: GPS

ORDER: SECOND CLASS: 1

GEODETTIC COOR: NAD 83(91)

LAT: 45:12'08.39930" N

LONG: 117:53'28.68206" W

SP. COOR: NAD 83(91)

N: 570714.417 INT.FT

E: 8874361.221 INT.FT.

THETA: 1:51'00.191"

SCALE FACTOR: 0.999894754

ELEV: 2736.31 U.S.FT.

ELEV. DATUM: NGVD 1929(1947)

DIRECTIONS "TO REACH":

**REGISTERED
PROFESSIONAL
LAND SURVEYOR**

Albert Hertel 10-14-99

**OREGON
JULY 18, 1980
ALBERT HERTEL
1896**

EXPIRES: 06/30/01

1 METER = 3.280833... U.S. FEET = 39.37 INCHES EXACTLY
1 METER = 3.280839895 INTL. FEET OR 1 INCH = 2.54CM. EXACTLY
TO CALCULATE ELEVATION FACTOR (IN THE NORTH AMERICAN CONTINENT)
DIVIDE 20,906,000 BY (20,906,000 + ELLIPSOID ELEV. IN FEET)

JOB 99-005
SHEET 51 OF 63