

CERTIFIED RECORD OF LAND CORNER MONUMENTATION

HISTORY OF ORIGINAL CORNER ESTABLISHMENT:

Corner originally established by David P. Thompson under GLO contract Number 103, dated 3 September 1863. Surveyor General record states:

Set post in mound of earth for sec cor with stakes, pits and trenches as per instructions

Book of Old Surveys Page 14: commenced at 1/4 sec corner bet Sec 22 & 23 which is a post in mound of stone

DESCRIPTION OF CORNER EVIDENCE FOUND:

Found ancient rock fence running east and west within acceptable tolerances of Book of Old Surveys Page 14 record measurement.

See Survey No. 032-1999

DESCRIPTION OF MONUMENT AND ACCESSORIES I ESTABLISHED TO PERPETUATE THE ORIGINAL LOCATION OF THIS CORNER:

At intersection of ancient rock fence and the west line of Section 23, I set a 2½"x 30" aluminum monument with aluminum cap marked as shown, 25" in the ground with 1' mound of stone surrounding the cap, from which:

NEW BEARING OBJECTS:

A 5/8" x 30" Iron rebar with aluminum cap marked NE RP bears N 31°E a distance of 7.15 feet.

A 5/8" x 30" Iron rebar with aluminum cap marked SE RP bears S 41°E a distance of 8.43 feet.

A 5/8" x 30" Iron rebar with aluminum cap marked SW RP bears S 37°W a distance of 7.22 feet.

A 5/8" x 30" Iron rebar with aluminum cap marked NW RP bears N 42°W a distance of 7.50 feet.

I hereby certify that the corner was monumented on June 9, 1999
Witness: Gregory T. Blackman Jr. and Norb Volny

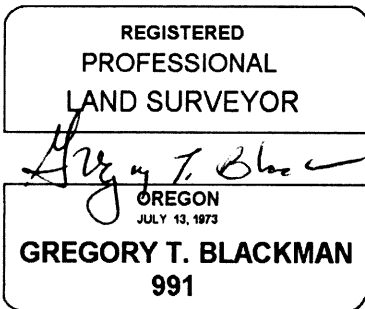
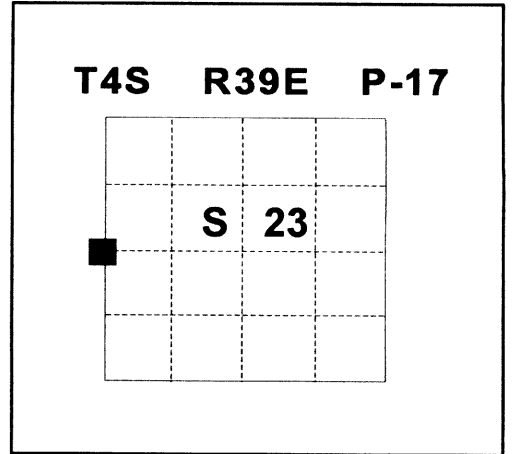

Renewal Date: December, 31 1999

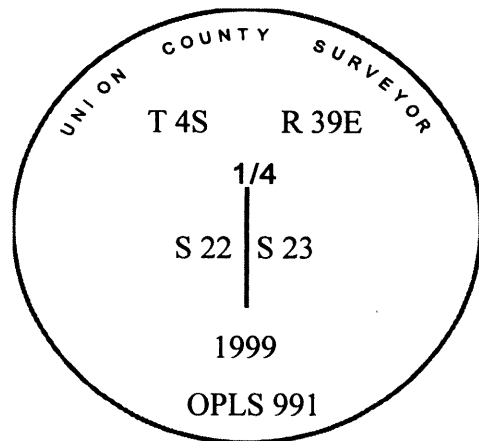

UNION COUNTY SURVEYOR

Date Received 9/13/99

Date Filed 10/8/99

Filed By R. Robinson, Deputy

File Number 046-1999R

I used a steel tape and a magnetic compass in the establishment of the new accessories. I used 17½° East declination. The distances are the center of each bearing object, unless otherwise noted above.

GEODETTIC CONTROL DATA

**OREGON STATE PLANE, NORTH ZONE (3601)
UNION COUNTY, OREGON**

STA. NAME: 9933

QUARTER CORNER:

SEC 22 | 23

TWP.4 S. RGE. 39 E

UNION COUNTY, OREGON

DATE TIED: JULY, 1999

SURVEYOR: WALTER L. CASWELL
PLS 737

FIRM: EAGLE GPS SURVEY CORP
6110 SW LOMBARD AVE.
BEAVERTON, OR. 97008-4736
(503) 643-1073

TYPE: GPS

ORDER: SECOND CLASS: 1

DIRECTIONS "TO REACH":

GEODETTIC COOR: NAD 83(91)

LAT: 45:12'07.72426" N

LONG: 117:54'43.31291" W

SP. COOR: NAD 83(91)

N: 570474.273 INT.FT

E: 8869022.923 INT.FT.

THETA: 1:50'07.264"

SCALE FACTOR: 0.999894752

ELEV: 2889.32 U.S.FT.

ELEV. DATUM: NGVD 1929(1947)

REGISTERED
PROFESSIONAL
LAND SURVEYOR

Albert Hertel 10-14-99

OREGON
JULY 18, 1980
ALBERT HERTEL
1896

EXPIRES: 06/30/01

1 METER = 3.280833... U.S. FEET = 39.37 INCHES EXACTLY
1 METER = 3.280839895 INTL. FEET OR 1 INCH = 2.54CM. EXACTLY
TO CALCULATE ELEVATION FACTOR (IN THE NORTH AMERICAN CONTINENT)
DIVIDE 20,906,000 BY (20,906,000 + ELLIPSOID ELEV. IN FEET)