

CERTIFIED RECORD OF LAND CORNER MONUMENTATION

HISTORY OF ORIGINAL CORNER ESTABLISHMENT:

Corner originally established by David P. Thompson under GLO contract Number 103, dated 1863. Surveyor General record states:

Set post for 1/4 Sec corner in mound of earth with charred stakes, pits, trench as per instructions

DESCRIPTION OF CORNER EVIDENCE FOUND:

NONE

Survey No. 032-1999

DESCRIPTION OF MONUMENT AND ACCESSORIES I ESTABLISHED

TO PERPETUATE THE ORIGINAL LOCATION OF THIS CORNER:

At proportionate position determined by survey. I set a 2 1/2" diameter x 30" aluminum monument with aluminum cap marked as shown, 43" in the ground from which:

NEW BEARING OBJECTS:

A 5/8" x 30" iron rebar with aluminum cap marked NE RP in a North South fence bears N53° E, a distance of 246.82 feet.

A 5/8" x 30" iron rebar with aluminum cap marked SE RP in a North South fence bears S34° E, a distance of 355.34 feet.

A 5/8" x 30" iron rebar with aluminum cap marked SW RP buried 12" below ground bears S46° W, a distance of 15.66 feet.

A 5/8" x 30" iron rebar with aluminum cap marked NW RP buried 12" below ground bears N41° W, a distance of 12.23 feet.

I hereby certify that the corner was monumented on June 15, 1999

Witnesses: Gregory T. Blackman Jr., Norbert W. Volny

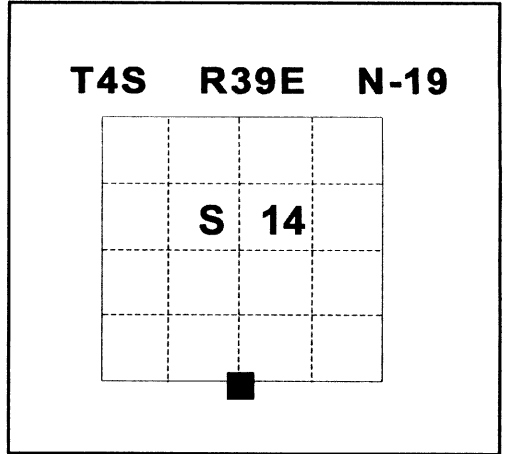

REGISTERED
PROFESSIONAL
LAND SURVEYOR

Gregory T. Blackman

OREGON
JULY 13, 1973

GREGORY T. BLACKMAN
991

Renewal Date: December, 31 1999

UNION COUNTY SURVEYOR

T4S R39E

S 14

1/4 —————

S 23

1999

OPLS 991

**UNION COUNTY
SURVEYOR**

Date Received 9/13/99

Date Filed 10/8/99

Filed By R. ROBINSON, DEPUTY

File Number 042-1999R

I used a Leica TCA-1100 Total Station and circular prism in the establishment of the new accessories. The Basis of Bearings is the same as Survey No. 032-1999. The distances are to the center of each bearing object, unless otherwise noted above.

GEODETTIC CONTROL DATA

**OREGON STATE PLANE, NORTH ZONE (3601)
UNION COUNTY, OREGON**

STA. NAME: 9928

QUARTER CORNER:

SEC 14

23 TWP.4 S. RGE.39 E
UNION COUNTY, OREGON

DATE TIED: JULY, 1999

SURVEYOR: WALTER L. CASWELL
PLS 737

FIRM: EAGLE GPS SURVEY CORP
6110 SW LOMBARD AVE.
BEAVERTON, OR. 97008-4736
(503) 643-1073

TYPE: GPS

ORDER: SECOND CLASS: 1

DIRECTIONS "TO REACH":

GEODETTIC COOR: NAD 83(91)

LAT: 45:12'34.25378" N

LONG: 117:54'05.85047" W

SP. COOR: NAD 83(91)

N: 573245.666 INT.FT

E: 8871617.307 INT.FT.

THETA: 1:50'33.832"

SCALE FACTOR: 0.999894835

ELEV: 2720.10 U.S.FT.

ELEV. DATUM: NGVD 1929(1947)

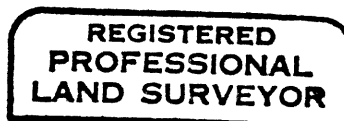

Albert Hertel 10-14-99

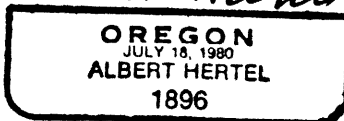

EXPIRES: 06/30/01

1 METER = 3.280833... U.S. FEET = 39.37 INCHES EXACTLY
1 METER = 3.280839895 INTL. FEET OR 1 INCH = 2.54CM. EXACTLY
TO CALCULATE ELEVATION FACTOR (IN THE NORTH AMERICAN CONTINENT)
DIVIDE 20,906,000 BY (20,906,000 + ELLIPSOID ELEV. IN FEET)