

CERTIFIED RECORD OF LAND CORNER MONUMENTATION

Adams & Clark, Inc.
1720 W. Fourth Ave.
Spokane, WA 99204-1702

Corner Code D-7
Township 4 South, Range 39 East

History of original corner establishment:

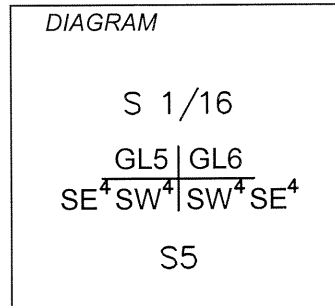

Description of corner evidence found:

Nothing found.

Description of monument and accessories I established to perpetuate the original location of this corner.

Set 5/8"x30" rebar with yellow plastic cap marked "LS 1503"

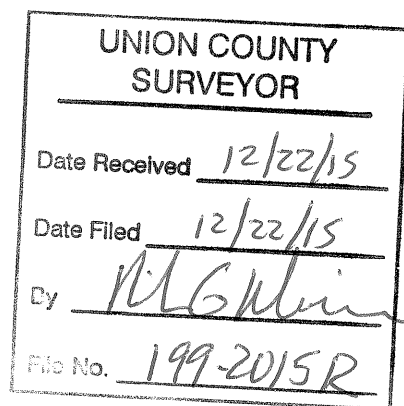
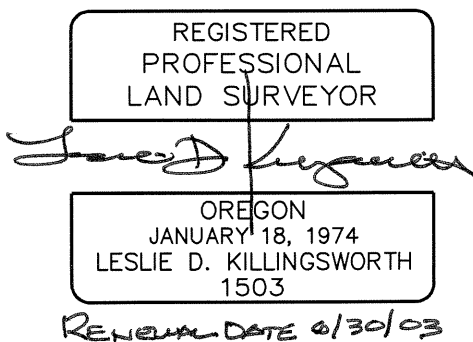

Leslie D. Killingsworth, P.L.S. 1503

11/01/2002

Date

UNION COUNTY SURVEYOR

CERTIFIED RECORD OF LAND CORNER MONUMENTATION

HISTORY OF ORIGINAL CORNER ESTABLISHMENT:

Old Book 1 Page 84 states set stone for center S1/2 Sec 5
Survey No. 040-2002 set 5/8" iron pin with plastic cap marked LS 1503 at proportionate position

No record of subsequent monumentation found in the Union County monumentation records

DESCRIPTION OF CORNER EVIDENCE FOUND:

Found 5/8" iron pin with plastic cap marked LS 1503 did not accept as 1/16 corner see Survey No. 044-2002

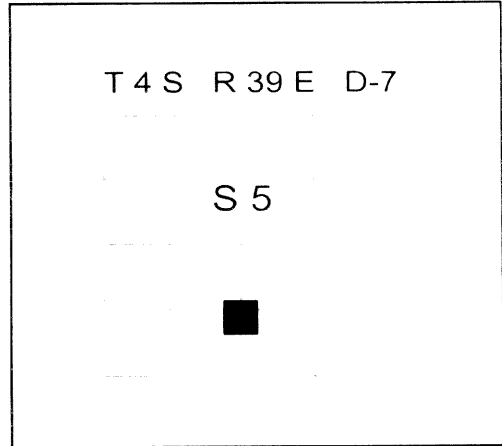

See Survey Number 044-2002

DESCRIPTION OF MONUMENT AND ACCESSORIES I ESTABLISHED TO PERPETUATE THE ORIGINAL LOCATION OF THIS CORNER:

At the proportionate position of Old Book 1 Page 84, I set a 5/8"x30" iron pin with 2 1/2" aluminum cap, marked as shown, 22 inches in the ground, from which

BEARING OBJECTS:

A 5/8" iron pin with plastic cap, bears North 74° West, a distance of 44.35 feet, marked LS 1503.

NEW BEARING OBJECTS:

A 5/8"x30" iron pin with aluminum cap, bears South 74° West, a distance of 10.34 feet, marked BGB SURVEY MARKER.

A 5/8"x30" iron pin with aluminum cap, bears South 1° West, a distance of 12.40 feet, marked BGB SURVEY MARKER.

Set steel fencepost 1 ft. South of monument.

I hereby certify that the corner was monumented on November 26, 2002
Witness: Norbert W. Volny, Gregory T. Blackman Jr.

REGISTERED
PROFESSIONAL
LAND SURVEYOR
Gregory T. Blackman
OREGON
JULY 13, 1973
GREGORY T. BLACKMAN
991

Renewal Date: December 31, 2003

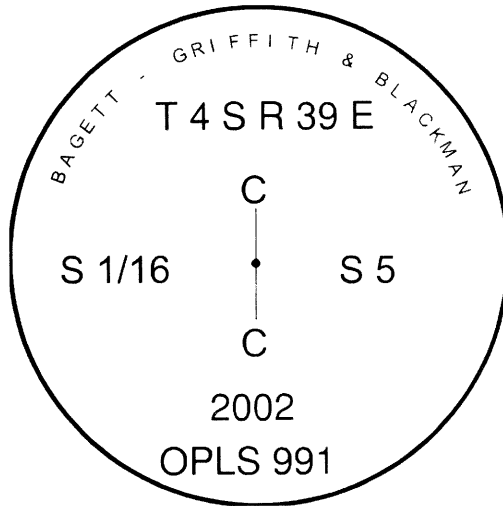

UNION COUNTY SURVEYOR
Date Received 12/2/02
Date Filed 12/31/02
Filed By R. ROBINSON, DEPUTY
File Number 046-2002R

I used a Leica 530 GPS system in the establishment of the new accessories. The basis of bearing is the same as shown on Survey No. 044-2002, the distances are to center of the cap.