

CERTIFIED RECORD OF LAND CORNER MONUMENTATION

HISTORY OF ORIGINAL CORNER ESTABLISHMENT:

Corner originally established by Timothy W. Davenport contract No. 102, dated July 20, 1863. Surveyor general record states: Made mound of earth and drove charred stake as per instructions.

T 3 S R 39 E A-15

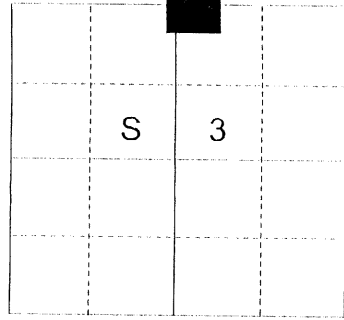

No subsequent monumentation found in Union county survey records.

DESCRIPTION OF CORNER EVIDENCE FOUND:

No evidence of the original corner was found.

See Survey Number 024-2004

DESCRIPTION OF MONUMENT AND ACCESSORIES I ESTABLISHED TO PERPETUATE THE ORIGINAL LOCATION OF THIS CORNER:

At the proportioned position determined by the survey I set a 2 1/2" x 30" aluminum pipe with cap as shown, in gravel road 6" below surface.

NEW BEARING OBJECTS AND TREES:

A 2" stem of water gate valve bears N 43° 55'E a distance of 48.74 feet

A cotton gin gear in a power pole 2' above ground level bears S 39° 43'E a distance of 36.17 feet.

A cotton gin gear in a power pole 1 1/2' above ground level bears S 49° 24'W a distance of 42.43 feet

A cotton gin gear in a R.R. tie fence corner bears N 25° 1/2'W a distance of 58.18 feet

I hereby certify that the corner was monumented on August 5, 2004.
Witness: Mike Spicer.

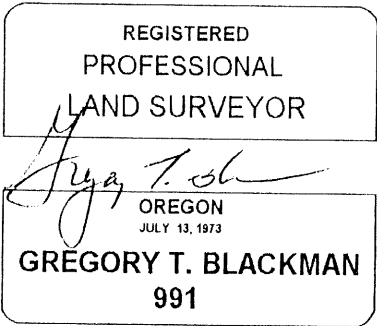

Renewal Date: December 31, 2005

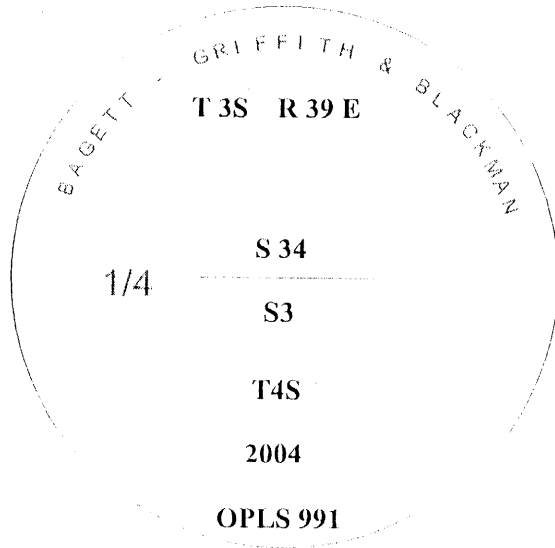

The bearing and distance to the reference points was determined by a GPS observation using a Leica 500 base and receiver. The basis of bearing is that of survey No. 024-2004.

A-15

UNION COUNTY SURVEYOR

Date Received 12/30/04

Date Filed 12/30/04

Filed By R. Robinson, Deputy

File Number 095-2004e

HORIZONTAL CONTROL DATA
UNION COUNTY, OREGON
OREGON STATE PLANE, NORTH ZONE (3601)

STA NAME: 201015

QUARTER CORNER COMMON TO SECTION 34, T 3 S AND SECTION 3, T 4 S

TWP. 3/4 S. RGE. 39 E.

GEODETIC COORD: NAD 83(91)

DATE TIED: JULY 15, 2010

LAT: 45 ° 15 ' 11.80999 " N

SURVEYOR: RICK G. ROBINSON
OPLS 2219

LONG: 117 ° 55 ' 19.09822 " W

FIRM: BAGETT, GRIFFITH, & BLACKMAN
2006 ADAMS AVENUE
LAGRANDE, OR 97850
(541) 963-6092

SP. COOR: NAD 83(91)

N: 589025.753 INT FT.

E: 8865867.358 INT FT.

TYPE: GPS

THETA: 1 ° 49 ' 41.9 "

ORDER: SECOND CLASS: 1

SCALE FACTOR: 0.9998956683

ELEV: 2699.90 US FT.

ELEV: DATUM: NGVD 29

COMMENTS:

Corner is 2 1/2" aluminum cap on pipe set
6" below gravel road surface.

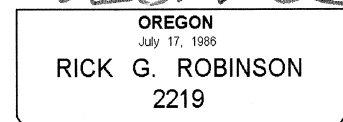
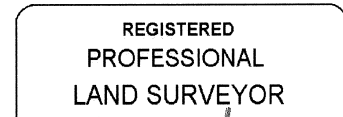
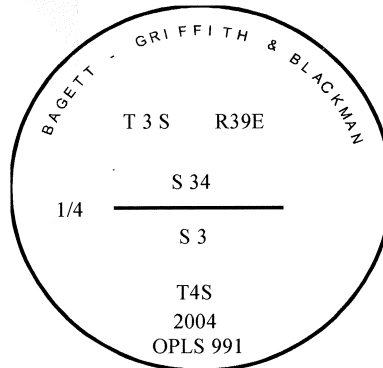

Renewal Date: December 31, 2010

1 METER = 3.280833333... US FEET = 39.37 INCHES

1 METER = 3.280839895 INT'L FEET OR 1 INCH = 2.54 CM

TO CALCULATE ELEVATION FACTOR (IN THE NORTH AMERICAN CONTINENT)

DIVIDE 20,906,000 BY (20,906,000 + ELLIPSOID ELEV. IN FEET)