

UNION COUNTY SURVEYOR

CERTIFIED RECORD OF LAND CORNER MONUMENTATION

HISTORY OF ORIGINAL CORNER ESTABLISHMENT:

Corner originally established by W.B. Barr under GLO Contract Number 388, dated May 7, 1881. Surveyor General record states:

T 4 S R 38 E X-09

Set stake for 1/4 Sec Cor. from which;
Fir 8 in diam bears S 6°E, 17 lks dist
Fir 10 in diam bears S 55°W, 32 lks

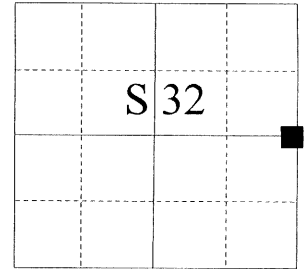

No record of subsequent monumentation found in Union County survey records.

DESCRIPTION OF CORNER EVIDENCE FOUND:

Found 19" diameter Douglas Fir S 6°E 11.2 ft. (17 lks), blaze evident, live and vigorous (did not open)
Found 28" diameter White Fir S 55°W 21.1 ft. (32 lks) dead and down with blaze evident. Opened and found scribing.

DESCRIPTION OF MONUMENT AND ACCESSORIES I ESTABLISHED TO PERPETUATE THE ORIGINAL LOCATION OF THIS CORNER:

At record bearing and distance from the found bearing trees, I set a 2 1/2" x 30" aluminum pipe with aluminum cap marked as shown below, 24" in the ground, from which:

New Bearing Trees:

A 10 inch diameter Douglas Fir bears S 82°E, a distance of 95.35 feet, marked 1/4 S33 BT
An 8 inch diameter White Fir bears S 27°W, a distance of 51.14 feet, marked 1/4 S32 BT
A 5 inch diameter Lodgepole Pine bears N 2°W, a distance of 46.13 feet, marked X BT

I hereby certify that the corner was monumented on July 3, 2003.

UNION COUNTY SURVEYOR
Date Received 7/18/03
Date Filed 9/12/03
Filed By [Signature]
File Number 033-2003R

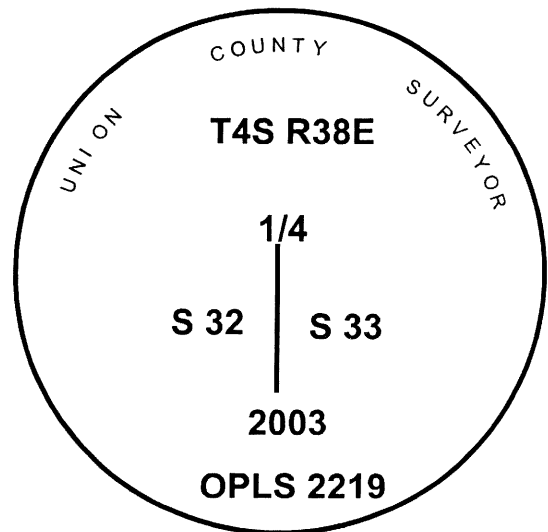

REGISTERED PROFESSIONAL LAND SURVEYOR

[Signature]
OREGON
July 17, 1986
RICK G. ROBINSON
2219

Renewal Date December 31, 2004

I used a steel tape and magnetic compass in the establishment of these accessories. I used a magnetic declination of 18° East. The distances are to a 50d spike driven on the right side of the root crown. I attached a brass washer marked OPLS 2219 to the BT blaze.

HORIZONTAL CONTROL DATA
UNION COUNTY, OREGON
OREGON STATE PLANE, NORTH ZONE (3601)

STA NAME: 200307

QUARTER CORNER COMMON TO: SECTIONS 32 & 33

TWP. 4 S. RGE. 38 E.

GEODETIC COORD: NAD 83(91)

DATE TIED: JULY 2003

LAT: 45 ° 10 ' 24.30661 " N

SURVEYOR: RICK G. ROBINSON
OPLS 2219

LONG: 118 ° 4 ' 33.08340 " W

FIRM: BAGETT, GRIFFITH, & BLACKMAN
2006 ADAMS AVENUE
LAGRANDE, OR 97850
(541) 963-6092

SP. COOR: NAD 83(91)

N: 558696.101 INT FT.

E: 8827132.258 INT FT.

TYPE: GPS

THETA: 1 ° 43 ' 9.00721186 "

ORDER: SECOND CLASS: 1

SCALE FACTOR: 0.9998946042

ELEV: 4827.10 US FT.

ELEV: DATUM: NGVD 29

COMMENTS:

Corner is 2 ½" aluminum monument
Approximately 500 feet West of Ladd Creek Rd.

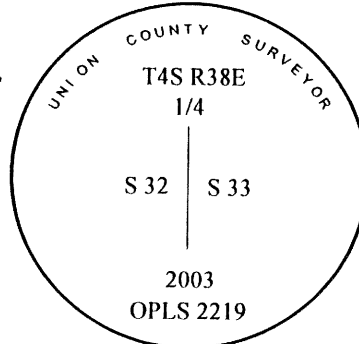

Renewal Date December 31, 2004

1 METER = 3.2808333333... US FEET = 39.37 INCHES

1 METER = 3.280839895 INT'L FEET OR 1 INCH = 2.54 CM

TO CALCULATE ELEVATION FACTOR (IN THE NORTH AMERICAN CONTINENT)

DIVIDE 20,906,000 BY (20,906,000 + ELLIPSOID ELEV. IN FEET)