

CERTIFIED RECORD OF LAND CORNER MONUMENTATION

HISTORY OF ORIGINAL CORNER ESTABLISHED:

Corner not previously established

T 4 S R 38 E U-05

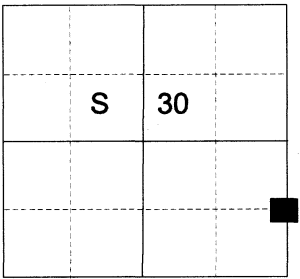

DESCRIPTION OF CORNER EVIDENCE FOUND:

None.

SEE SURVEY NUMBER 028-2025

DESCRIPTION OF MONUMENT AND ACCESSORIES I ESTABLISHED TO MONUMENT THE ORIGINAL LOCATION OF THIS CORNER:

At position by survey, I set a 5/8" x 30" iron pin, 28" in the ground, with a 2 1/2" aluminum cap marked as shown below, from which:

NEW BEARING OBJECTS:

A 5" diam. Lodgepole Pine bears North 88° East, a distance of 10.85 feet, marked S 1/16 S29 BT.

A 5" diam. Lodgepole Pine bears North 13° West, a distance of 6.50 feet, marked S 1/16 S30 BT.

Set steel fencepost 0.5 feet East

An East/West fence line bears approx. 6 ft. North

I hereby certify that the corner was monumented on August 1, 2025

Witness: Kyle Tucker

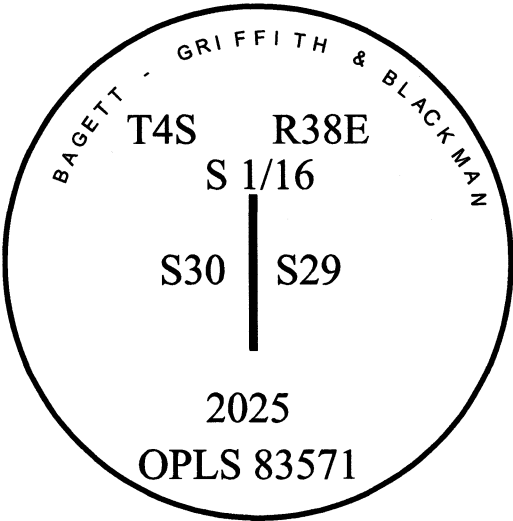

Renewal Date: June 30, 2027

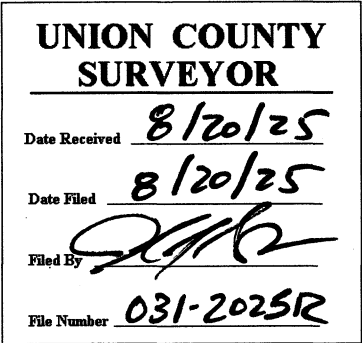

I use a tape and compass in the establishment of the new bearing objects. 14° East was used for declination and measured to a brass washer labeled "OPLS 83571" in the BT blaze at the base of the tree. Distances are to a 60D nail in the right wide of the base of the center of the tree.

U-05