

CERTIFIED RECORD OF LAND CORNER MONUMENTATION

HISTORY OF ORIGINAL CORNER ESTABLISHED:

Corner not previously established.

T 4 S R38S E T-08

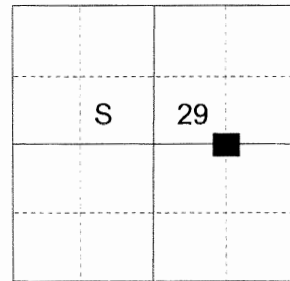

DESCRIPTION OF CORNER EVIDENCE FOUND:

None.

SEE SURVEY NUMBER 018-2016

DESCRIPTION OF MONUMENT AND ACCESSORIES I ESTABLISHED

TO PERPETUATE THE ORIGINAL LOCATION OF THIS CORNER:

At position determined by survey, I set a 5/8" x 30" iron pin with 2 1/2" aluminum cap, marked as shown below, 25 inches in the ground, from which:

NEW BEARING OBJECTS:

A 12" Ponderosa Pine bears North 73° East, a distance of 26.90 feet, marked CE 1/16 S29 BT.

A 7" Lodgepole Pine bears South 52° West, a distance of 4.90 feet, marked CE 1/16 S29 BT.

Set a steel fencepost approximately 1 foot North of the corner monument.
I hereby certify that this monument was set June 23, 2016.

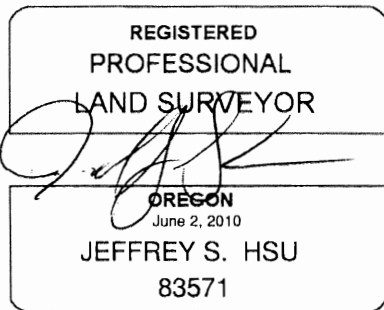

Renewal Date: June 30, 2017

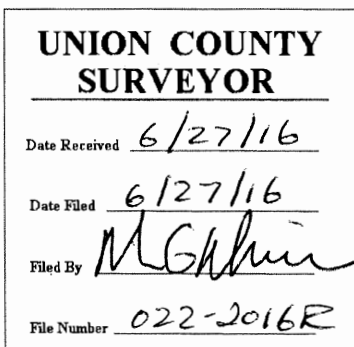
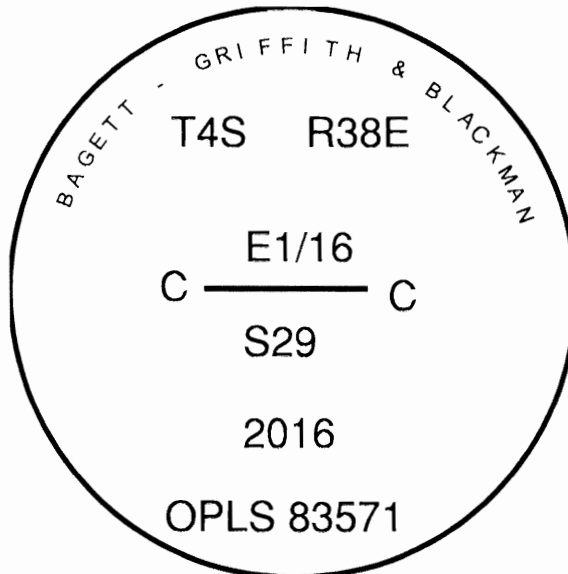

I use a steel tape and magnetic compass in the establishment of the bearing trees. Magnetic declination used was 15° East. Distances to the new trees are to a spike in the root crown of the trees. Bearings are to a brass washer in the lower blaze marked OPLS 83571.