

CERTIFIED RECORD OF LAND CORNER MONUMENTATION

HISTORY OF ORIGINAL CORNER ESTABLISHED:
Corner not previously established.

T 4 S R 38 E T-06

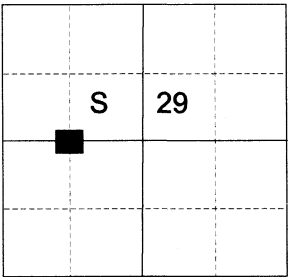

DESCRIPTION OF CORNER EVIDENCE FOUND:
None

SEE SURVEY NUMBER 028-2025
DESCRIPTION OF MONUMENT AND ACCESSORIES I ESTABLISHED TO MONUMENT THE ORIGINAL LOCATION OF THIS CORNER:
At position determined by survey, I set a 5/8" x 30" iron pin with a 2 1/2" aluminum cap, marked as shown below, 28" in the ground, from which:

NEW BEARING OBJECTS:

A 10" diam. Douglas Fir bears North 5° East, a distance of 46.95 feet, marked CW 1/16 S29 BT.
A 7" diam. Douglas Fir bears South 56° East, a distance of 15.80 feet, marked CW 1/16 S29 BT.

Set steel fencepost 0.3 ft South.

Fence corner falls approx. 90 ft. NE.

I hereby certify that the corner was monumented on July 1, 2025

Witness: Kyle Tucker, Adam Gordon

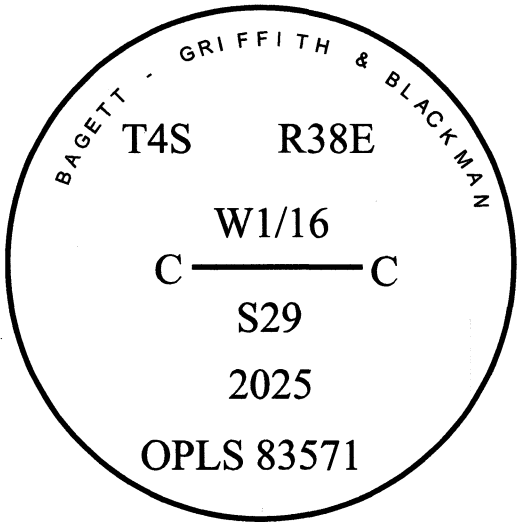

Renewal Date: June 30, 2027

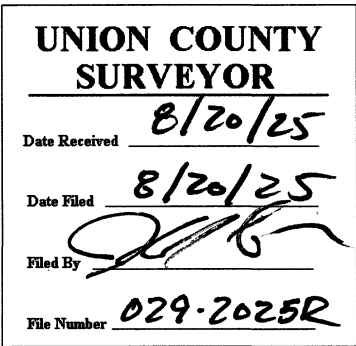

I used a tape and compass in the establishment of the bearing trees. 14° East was used for declination and measured to a brass washer marked "OPLS 83571" and tacked to the opened BT blaze. Distance was to a 60-D spike in the root crown on the right side of the tree.

T-06