

**CERTIFIED RECORD OF LAND CORNER MONUMENTATION**

**HISTORY OF ORIGINAL CORNER ESTABLISHED:**

Corner originally established by W.B. Barr under GLO contract 388, dated May 7, 1881. Surveyor General field notes state:

Marked granite rock 12x12x6 for corner to secs. 20, 21, 28 and 29, from which:  
 Pine 24 in. diam. bears S64 1/2°W, 20 lks. dist.  
 Tamarack 24 in. diam. bears S23°E, 31 lks. dist.  
 Fir 24 in. diam. bears N20°W, 40 lks. dist.  
 Pine 28 in. diam. bears N58°E, 61 lks. dist.

**T 4 S R38E R-09**

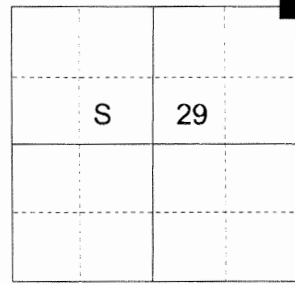

**DESCRIPTION OF CORNER EVIDENCE FOUND:**

Found 42" decaying fir snag with scribe marks 'BT' visible on an opened blaze for Northwest bearing tree. Original stone or other bearing trees were not found.

SEE SURVEY NUMBER 018-2016

**DESCRIPTION OF MONUMENT AND ACCESSORIES I ESTABLISHED**

**TO PERPETUATE THE ORIGINAL LOCATION OF THIS CORNER:**

At a point South 20° East, a distance of 40 lks. from the found bearing tree (distance measured from the face of the scribe), I set a 2 1/2" x 30" aluminum pipe with 2 1/2" aluminum cap, marked as shown below, 26 inches in the ground, in a collar of stone 1 1/2 ft. diam., from which:

**NEW BEARING OBJECTS:**

- A 7" Ponderosa Pine bears North, a distance of 37.60 feet, marked T4SR38ES21 BT.
- A 6" Ponderosa Pine bears South 12° East, a distance of 4.95 feet, marked T4SR38ES28 BT.
- A 7" Ponderosa Pine bears South 78° West, a distance of 27.60 feet, marked T4SR38ES29 BT.
- A 5" Ponderosa Pine bears North 35° West, a distance of 40.45 feet, marked T4SR38ES20 BT

Set a steel fencepost approximately 1 foot North of the corner monument. Corner falls approximately 60 feet Southeast of an Northeast/Southwest running logging road. I hereby certify that this monument was perpetuated June 15, 2016.

**REGISTERED  
PROFESSIONAL  
LAND SURVEYOR**

**OREGON**  
June 2, 2010

**JEFFREY S. HSU**  
83571

Renewal Date: June 30, 2017

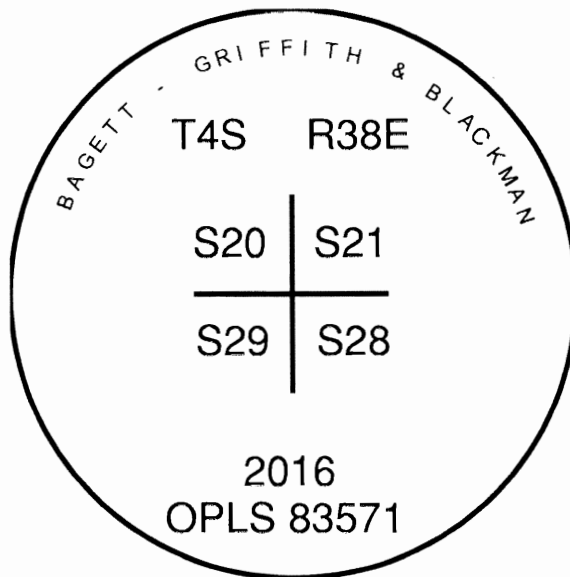

**UNION COUNTY  
SURVEYOR**

Date Received 6/27/16

Date Filed 6/27/16

Filed By *M. G. Hsu*

File Number 020-2016

I use a steel tape and magnetic compass in the establishment of the bearing trees. Magnetic declination used was 15° East. Distances to the new trees are to a spike in the root crown of the trees. Bearings are to a brass washer in the lower blaze marked OPLS 83571.

# HORIZONTAL CONTROL DATA

## UNION COUNTY, OREGON

### OREGON STATE PLANE, NORTH ZONE (3601)

STA NAME: 2018001

SECTION CORNER COMMON TO SECTIONS 20, 21, 28 AND 29

TWP. 4 S RGE. 38 E.

GEODETIC COORD: NAD 83(91)

DATE TIED: January 3, 2018

LAT: 45 ° 11 ' 42.33971 " N

SURVEYOR: RICK G. ROBINSON  
OPLS 2219

LONG: 118 ° 4 ' 32.09467 " W

FIRM: BAGETT, GRIFFITH, & BLACKMAN  
2006 ADAMS AVENUE  
LAGRANDE, OR 97850  
(541) 963-6092

SP. COOR: NAD 83(91)

N: 566597.231 INT FT.

E: 8826965.942 INT FT.

TYPE: GPS

THETA: 1 ° 43 ' 9.70841919 "

ORDER: SECOND CLASS: 1

SCALE FACTOR: 0.9998946881

ELEV: 4991.18 US FT.

ELEV: DATUM: NGVD 29

**COMMENTS:**

2 1/2" aluminum pipe with 2 1/2" aluminum cap marked as shown, set in mound of stone.

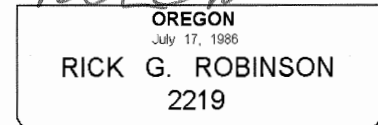
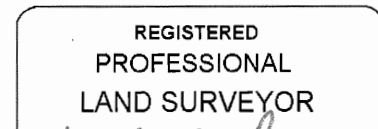
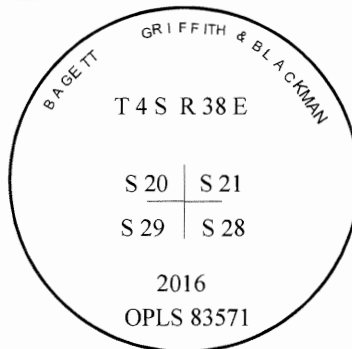

Renewal Date: December 31, 2018

1 METER = 3.2808333333... US FEET = 39.37 INCHES

1 METER = 3.280839895 INT'L FEET OR 1 INCH = 2.54 CM

TO CALCULATE ELEVATION FACTOR ( IN THE NORTH AMERICAN CONTINENT)

DIVIDE 20,906,000 BY (20,906,000 + ELLIPSOID ELEV. IN FEET)