

CERTIFIED RECORD OF LAND CORNER MONUMENTATION

INDEX FILE NO. P-21

History of original corner establishment:

Original Survey by W. Barr, 1881, states:

Marked basalt rock 12x10x8 for 1/4 Sec. Corner.

Raised mound of rock as per instructions.

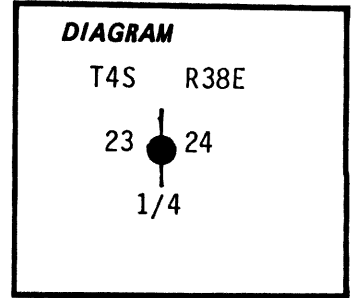

Description of corner evidence found:

Original corner stone not found.

Corner location determined in existing mound of rock, 5 ft. diameter and 1 ft. high as shown on O.S.H.D. right-of-way maps and by measurement to other related evidence. (See survey map filed concurrently with this record).

Description of monument and accessories I established to perpetuate the original location of this corner:

At the corner point in the mound of stone, we set a 2"x30" Galvanized Iron Pipe, 16" in the ground on a SW facing grassy slope, with brass cap attached, marked:

From which we mark new bearing objects:

An "+B0" chiseled on N. side of an exposed horizontal bedrock face, (6'x5') at ground level bears N55°E 5.8 feet.

An "+B0" chiseled on east side of a horizontal exposed rock surface (9'x14'), bears N 63°W 41.5 ft.

Placed steel fencepost alongside corner monument.

Compass declination: 20° East

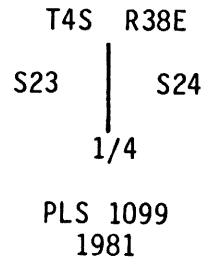

Witnesses: Gary L. Langlitz PLS 1099  
David Allen

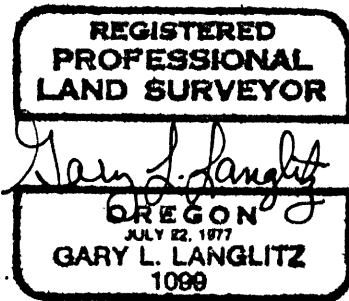

Office of.....Surveyor..... County of..... Union.....  
 State of..... Oregon....., I hereby certify that the within instrument was filed in this office  
 for record on the 29 day of OCTOBER, 1981  
 ..... Howard L. Perry ..... by ..... Gary Langlitz .....  
 (COUNTY OFFICIAL) (DEPUTY)

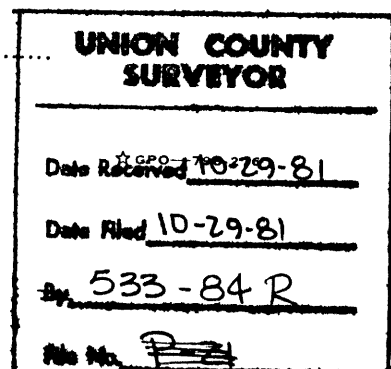

**CERTIFIED RECORD OF LAND CORNER MONUMENTATION**

**HISTORY OF ORIGINAL CORNER ESTABLISHMENT:**

Corner established by W.B. Barr, under GLO  
Contract number 388, dated May 7, 1881.  
Surveyor General record states:

Marked basalt rock 12x10x8 for 1/4 sec corner.  
Raised mound of rock as per instructions.

Gary Langlitz in Survey Number 76-81 places the  
corner based on O.S.H.D. right of way maps and  
measurements to related evidence. Union County  
monumentation record 533-84R states:

Set 2"x30" galvanized iron pipe, 16" in the ground  
on a SW facing grassy slope, with brass cap  
attached, from which we mark new bearing objects:

An "+BO" chiseled on N. Side of an exposed horizontal bedrock face, (6'x5') at  
ground level bears N55°E, 5.8 feet.  
An "+BO" chiseled on east side of a horizontal exposed rock surface (9'x14'), bears  
N63°W, 41.5 ft.

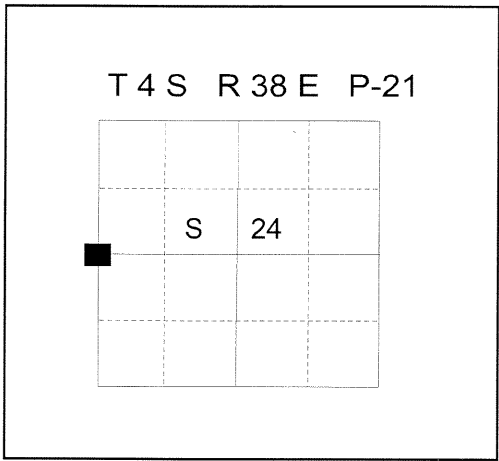

**DESCRIPTION OF CORNER EVIDENCE FOUND:**

Found 2" galvanized iron pipe with brass cap marked as shown below, 12 inches above  
ground, in mound of stone 4 ft. dia. 1 ft. high., from which:

An "+BO" chiseled on the North side of an exposed rock bears North 52° East, a  
distance of 6.15 feet.  
An "+BO" chiseled on the East side of an exposed rock bears North 57° West, a  
distance of 41.15 feet.

**DESCRIPTION OF MONUMENT AND ACCESSORIES I ESTABLISHED  
TO PERPETUATE THE ORIGINAL LOCATION OF THIS CORNER:**

At the position of the found pipe,

**NEW BEARING OBJECTS:**

A 5/8"X 30" rebar with 1 1/2" aluminum cap bears South 49° East, a distance of 7.80  
feet, marked "UNION COUNTY SURVEYOR SE RP".  
A 5/8"X 30" rebar with 1 1/2" aluminum cap bears South 27° West, a distance of 6.25  
feet, marked "UNION COUNTY SURVEYOR SW RP".

Corner falls on an open SW facing slope.

I hereby certify that the corner was perpetuated on January 31, 2012.  
Witness: Jeff Hsu

REGISTERED  
PROFESSIONAL  
LAND SURVEYOR

*Rick G. Robinson*  
OREGON  
July 17, 1986  
RICK G. ROBINSON  
2219

Renewal Date: December 31, 2012

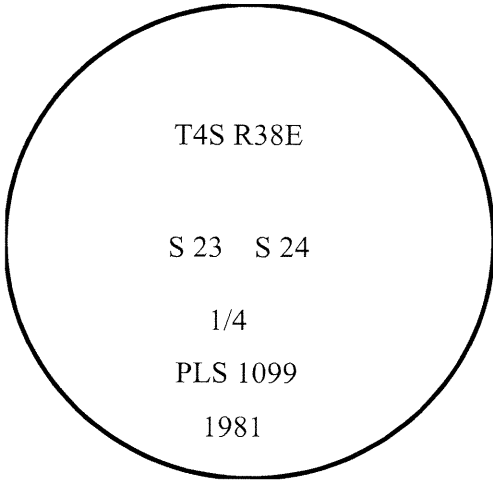

**UNION COUNTY  
SURVEYOR**  
Date Received 2/5/2012  
Date Filed 2/5/12  
Filed By *Gregory T. Blacker*  
File Number 009-2012R

I used a steel tape and magnetic compass to  
establish the accessories. Magnetic declination  
used was 16° East. The distances to the rebar  
accessories are to the center of the aluminum  
cap. The distances to the "+BO" are to the  
center of the cross.

# HORIZONTAL CONTROL DATA

## UNION COUNTY, OREGON

### OREGON STATE PLANE, NORTH ZONE (3601)

STA NAME: 201207

QUARTER CORNER COMMON TO SECTIONS 23 AND 24

TWP. 4 S. RGE. 38 E.

GEODETIC COORD: NAD 83(91)

DATE TIED: January 31, 2012

LAT: 45 ° 12 ' 8.30930 " N

SURVEYOR: RICK G. ROBINSON  
OPLS 2219

LONG: 118 ° 0 ' 51.77490 " W

FIRM: BAGETT, GRIFFITH, & BLACKMAN  
2006 ADAMS AVENUE  
LAGRANDE, OR 97850  
(541) 963-6092

SP. COOR: NAD 83(91)

N: 569705.299 INT FT.

E: 8842653.712 INT FT.

TYPE: GPS

THETA: 1 ° 45 ' 45.96 "

ORDER: SECOND CLASS: 1

SCALE FACTOR: 0.9998947538

ELEV: 3770.49 US FT.

ELEV: DATUM: NGVD 29

**COMMENTS:**

Corner falls on a open SW facing slope  
on South side of highway.

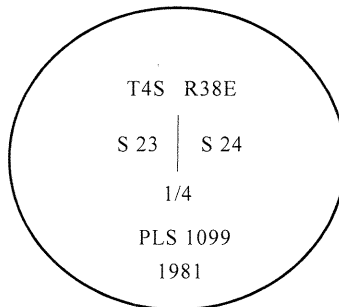

REGISTERED  
PROFESSIONAL  
LAND SURVEYOR

*Rick G. Robinson*  
OREGON  
July 17, 1986  
RICK G. ROBINSON  
2219

1 METER = 3.2808333333... US FEET = 39.37 INCHES

1 METER = 3.280839895 INT'L FEET OR 1 INCH = 2.54 CM

TO CALCULATE ELEVATION FACTOR ( IN THE NORTH AMERICAN CONTINENT)

DIVIDE 20,906,000 BY (20,906,000 + ELLIPSOID ELEV. IN FEET)

Renewal Date: December 31, 2012