

CERTIFIED RECORD OF LAND CORNER MONUMENTATION

HISTORY OF ORIGINAL CORNER ESTABLISHED:

Corner originally established by W.B. Barr under GLO contract number 388 dated May 7th, 1881. Surveyor General field notes state:

Marked basalt rock 16x16x6 for 1/4 sec. corner from which:

Pine 18 in. diam. bears S45°W 54 lks. dist.
Pine 6 in. diam. bears S16°E 42 lks. dist.

T 4 S R 38 E P-17

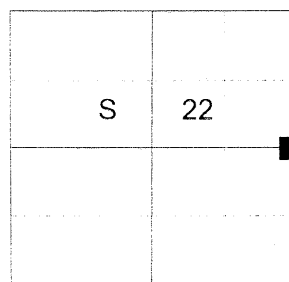

DESCRIPTION OF CORNER EVIDENCE FOUND:

Found a 16" x 16" x 6" stone marked 1/4, from which:
A 19" Ponderosa Pine bears South 16° East, a dist. of 27.70 ft., alive and vigorous with remnants of "BT" scribes visible upon opening healed blaze.
A 22" Ponderosa Pine, the base which bears South 45° West, a dist. of 35.65 ft., dead and down with faint "1/4S" scribes visible upon opening partially healed blaze.

DESCRIPTION OF MONUMENT AND ACCESSORIES I ESTABLISHED TO PERPETUATE THE ORIGINAL LOCATION OF THIS CORNER:

At position of found stone, I set a 2 1/2" x 30" aluminum pipe, 20" in the ground, with 3" aluminum cap marked as shown below, with 1' diam. collar of stone, from which:

NEW BEARING OBJECTS:

A 13" Douglas Fir bears North 23° East a dist. of 71.05 ft., marked 1/4 S23 BT.
A 10" Douglas Fir bears South 40° West a dist. of 19.00 ft., marked 1/4 S22 BT.
A 20" Douglas Fir bears North 12° West a dist. of 83.45 ft., marked 1/4 S22 BT.

Buried stone along the West side of monument.

Set steel fence post approx. 1 ft. West.

I hereby certify that the corner was monumented on August 1, 2019.
Witness: Kyle A. Tucker

Falls mid slope on steep West aspect.

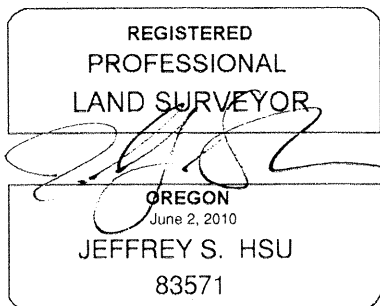

Renewal Date: June 30, 2021

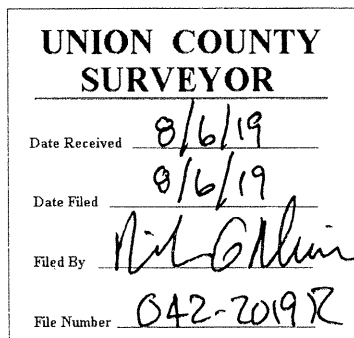
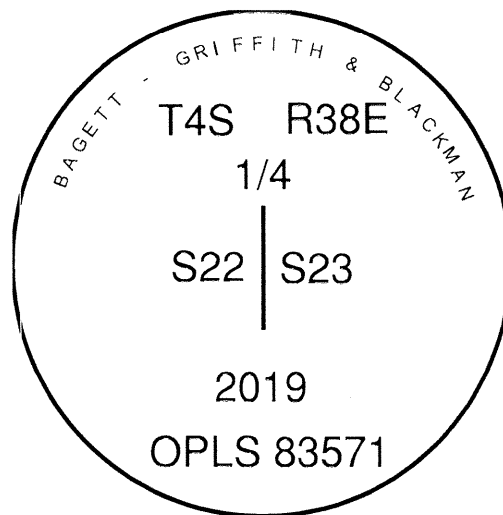

I used a steel tape and magnetic compass in the establishment of the new accessories. I used 13° East declination, the distances are to a 60d spike driven into the side of the root crown of the bearing trees. A brass washer marked OPLS 83571 is attached to the BT blaze of the new bearing trees.