

CERTIFIED RECORD OF LAND CORNER MONUMENTATION

History of original corner establishment:

Corner originally established by W. B. Barr under GLO Contract Number 388, dated May 7, 1881. Surveyor General record states: Set Rock 20x10x6 for corner.

FROM WHICH:

- A B. Pine 14 in. diameter bears N 70° E, 17 lks. dist.
- A Fir 15 in. diameter bears S 68° E, 38 lks. dist.
- A Fir 3 in. diameter bears S 27° W, 37 lks. dist.:
- A Fir 8 in. diameter bears N 32° E, 17 lks. dist.

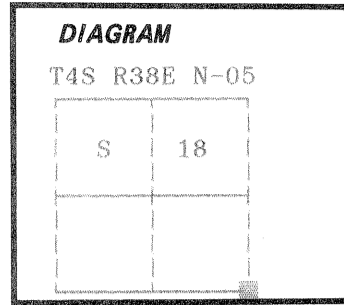

No record of subsequent monumentation found in Union County survey records.

Description of corner evidence found:

Found no evidence of the original corner monument.
Found an 8" D. bearing S 27° W, 37 lks distant, dead and down, rotted with scribes visible.

No other accessories found.

Description of monument and accessories | established to perpetuate the original location of this corner:

At record bearing and distance from the found bearing trees, I set a 2 1/2"x30" Aluminum pipe with aluminum cap marked as shown, 25 inches in the ground, for the corner position.

FROM WHICH:

- A 5/8" x 30 " rebar with a plastic cap marked BGA SURVEY MARKER bears N 49° E, 14.28 feet.
- An 18" D. Fir bears S 49° E, a distance of 42.72 feet, marked T4SR38E S20 BT
- An 11" D. Fir bears S 72° W, a distance of 30.06 feet, marked T4SR38E S 19 BT
- A 1/2 x 24 " Rebar with plastic cap marked BGA SURVEY MARKER bears N 38° W, a distance of 21.08 feet.

I hereby certify that the above corner point was perpetuated as hereon described on August 7, 1990.

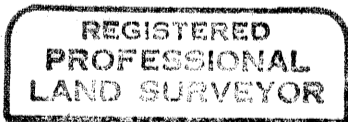
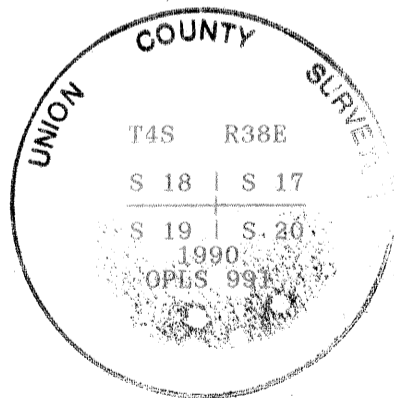

Gregory T. Blackman

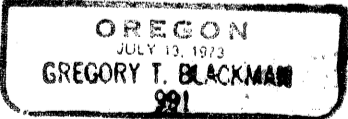

I used a steel tape and magnetic compass in the establishment of new accessories. I used 20° East magnetic declination and the distances are to a 50d spike driven in the right side of the root crown. I attached a brass washer marked OPLS 991 to the BT blaze.

Office of..... County of.....
State of....., I hereby certify that the within instrument was filed in this office for record on the..... day of....., 19.....

(COUNTY OFFICIAL)

UNION COUNTY SURVEYOR

By *Gregory T. Blackman* (DEPUTY)

Date Received 9-1-90

Date Filed 9-15-90

By *Gregory T. Blackman*

File No. 56-90R.

Form R6-7100-57 (9/71)

N-05

UNION COUNTY
CERTIFIED RECORD OF LAND CORNER MONUMENTATION

History of original corner establishment:

Corner originally established by W. B. Barr under GLO Contract Number 388, dated May 7, 1881. Surveyor General record states: Set Rock 20x10x6 for corner.

FROM WHICH:

- A B. Pine 14 in. diameter bears N 70° E, 17 lks. dist.
- A Fir 15 in. diameter bears S 68° E, 38 lks. dist.
- A Fir 3 in. diameter bears S 27° W, 37 lks. dist.:
- A Fir 8 in. diameter bears N 32° E, 17 lks. dist.

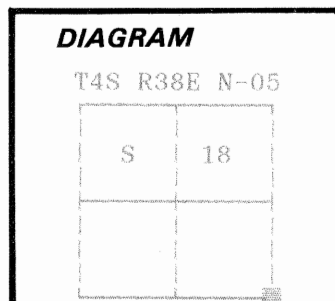

No record of subsequent monumentation found in Union County survey records.

Description of corner evidence found:

Found no evidence of the original corner monument.
Found an 8" Fir bearing S 27° W, 37 lks distant, dead and down, rotted with scribes visible.

No other accessories found.

Description of monument and accessories I established to perpetuate the original location of this corner:

At record bearing and distance from the found bearing trees, I set a 2 1/2"x30" Aluminum pipe with aluminum cap marked as shown, 25 inches in the ground, for the corner position.

FROM WHICH:

- A 5/8" x 30 " rebar with a plastic cap marked BGA SURVEY MARKER bears N 49° E, 14.28 feet.
- An 18" D. Fir bears S 49° E, a distance of 42.72 feet, marked T4SR38E S20 BT
- An 11" D. Fir bears S 72° W, a distance of 30.06 feet, marked T4SR38E S 19 BT
- A 1/2" x 24 " Rebar with plastic cap marked BGA SURVEY MARKER bears N 38° W, a distance of 21.08 feet.

I hereby certify that the above corner point was perpetuated as hereon described on August 7, 1990.

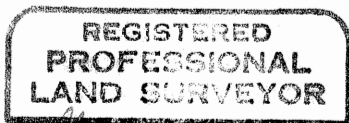
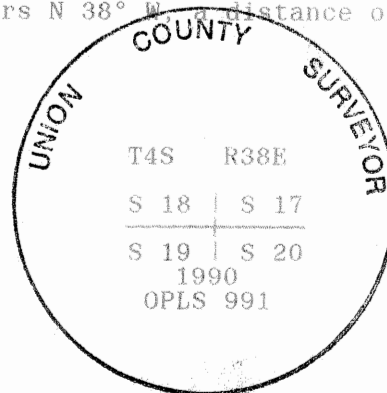

Gregory T. Blackman

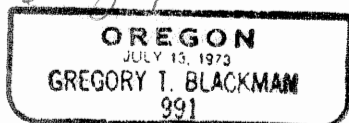

I used a steel tape and magnetic compass in the establishment of new accessories. I used 20° East magnetic declination and the distances are to a 50d spike driven in the right side of the root crown. I attached a brass washer marked OPLS 991 to the BT blaze.

UNION COUNTY SURVEYOR	
Date Received	<u>10/11/90</u>
Date Filed	<u>10/11/90</u>
By	<u>Gregory T. Blackman</u>
File No.	<u>61-90R</u>