

CERTIFIED RECORD OF LAND CORNER MONUMENTATION

HISTORY OF ORIGINAL CORNER ESTABLISHMENT:

Corner originally established by William B. Barr under GLO contract Number 388, dated May 7, 1881. Surveyor General record states:

Set basalt rock 18 x 7 x 5 ins. from which;
A 6in. Pine bears N 60°W, 176 lks.
A 30in. Pine bears S 1°E, 122 lks.

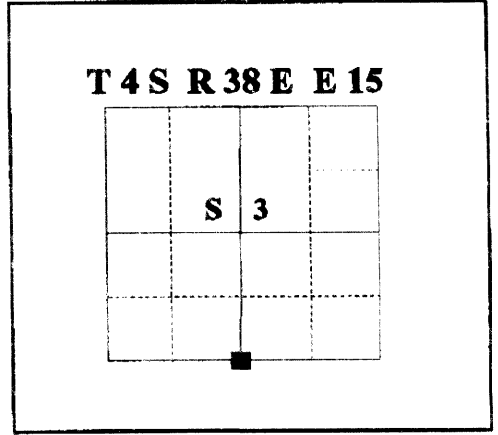

No record of subsequent monumentation found in Wallowa County survey records
DESCRIPTION OF CORNER EVIDENCE FOUND:

Found Basalt rock 18"x7"x5" in mound of stone, marked 1/4
Found 30"+ pine snag, dead and down, scribes visable.
Found 10"± pine stump, no marks.

DESCRIPTION OF MONUMENT AND ACCESSORIES I ESTABLISHED TO PERPETUATE THE ORIGINAL LOCATION OF THIS CORNER:

In place of stone I set a 2½" x 30" aluminum pipe with aluminum cap marked as shown, 24 inches in the ground, from which;

ORIGINAL BEARING TREES:

A 30" pine snag S 1°E 122 lks.
A 10" pine stump N 60°W, 176 lks. no marks

NEW BEARING TREES:

A 28" Ponderosa Pine bears N 38°E, 35.8 ft. marked 1/4 S4 BT
A 13" Ponderosa Pine bears S 50°E, 12.47ft. marked 1/4 S10 BT
A 13" Douglas Fir bears S 24°W, 15.48ft. marked 1/4 S10 BT
A 15" Ponderosa Pine bears N 53°W, 38.76 ft. marked X BT

Buried stone south and alongside pipe.
Raised mound of stone 4 ft. base to top cap.

Witness: Travis P. Foster

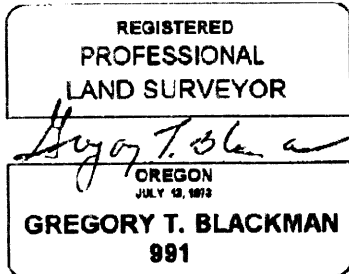
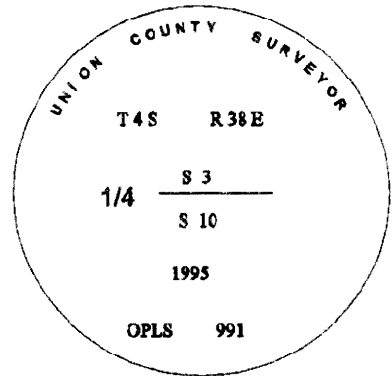

Renewal Date: December, 31 1995

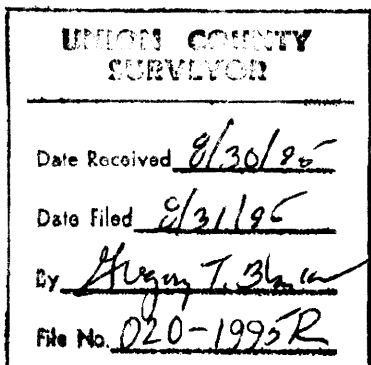

I used a steel tape and magnetic compass in the establishment of the new accessories. I used 17° East declination, the distances are to a 50d spike driven in the right side of the root crown. I attached a brass washer marked OPLS 644 the bearing tree blaze.

HORIZONTAL CONTROL DATA
UNION COUNTY, OREGON
OREGON STATE PLANE, NORTH ZONE (3601)

STA NAME: 2017018

1/4 SECTION CORNER COMMON TO SECTIONS 3 AND 10

TWP. 4 S. RGE. 38 E.

GEODETIC COORD: NAD 83(91)

DATE TIED: September 25, 2017

LAT: 45 ° 14 ' 18.44693 " N

SURVEYOR: RICK G. ROBINSON
OPLS 2219

LONG: 118 ° 2 ' 41.68729 " W

FIRM: BAGETT, GRIFFITH, & BLACKMAN
2006 ADAMS AVENUE
LAGRANDE, OR 97850
(541) 963-6092

SP. COOR: NAD 83(91)

N: 582638.011 INT FT.

E: 8834387.694 INT FT.

TYPE: GPS

THETA: 1 ° 44 ' 28.0077901 "

ORDER: SECOND CLASS: 1

SCALE FACTOR: 0.9998953209

ELEV: 3703.01 US FT.

ELEV: DATUM: NGVD 29

COMMENTS:

2 1/2" aluminum monument with cap marked
as shown.

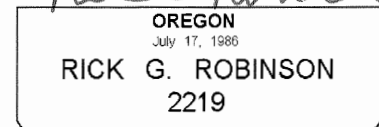
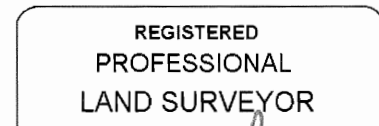
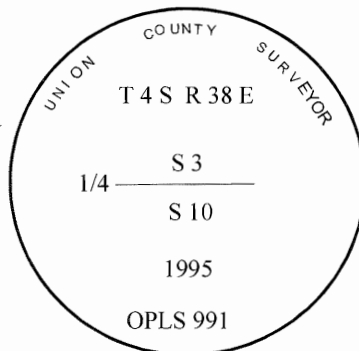

Renewal Date: December 31, 2018

1 METER = 3.2808333333... US FEET = 39.37 INCHES

1 METER = 3.280839895 INT'L FEET OR 1 INCH = 2.54 CM

TO CALCULATE ELEVATION FACTOR (IN THE NORTH AMERICAN CONTINENT)

DIVIDE 20,906,000 BY (20,906,000 + ELLIPSOID ELEV. IN FEET)