

CERTIFIED RECORD OF LAND CORNER MONUMENTATION

HISTORY OF ORIGINAL CORNER ESTABLISHMENT:

Corner originally established by Timothy W. Davenport, under GLO Contract Number 102, dated July 20, 1863. Surveyor General record states:

Set a Post in mound of earth with charred stakes, pits as per instructions;

No record of subsequent monumentation found in Union County Survey Records

DESCRIPTION OF CORNER EVIDENCE FOUND:

No original evidence found
See Survey No. 034-2002

DESCRIPTION OF MONUMENT AND ACCESSORIES I ESTABLISHED TO PERPETUATE THE ORIGINAL LOCATION OF THIS CORNER:

At the proportioned position, I set a 5/8"x 30" iron pin with 2 1/2" aluminum cap marked as shown, 24 inches in the ground, with a mound of stone 2 ft. from base to top of cap from which;

NEW BEARING OBJECTS:

A 5/8"x 30" inch iron pin with a 2" aluminum cap, bears North 47° East, a distance of 18.39 feet, marked E RP

A 5/8"x 30" inch iron pin with a 2" aluminum cap, bears North, a distance of 30.00 feet, marked N RP

A 5/8"x 30" inch iron pin with a 2" aluminum cap, bears South 48° West, a distance of 17.48 feet, marked S RP

A 5/8"x 30" inch iron pin with a 2" aluminum cap, bears West, a distance of 30.00 feet, marked W RP

I hereby certify that the corner was monumented on September 4, 2002

Witnesses:

Norbert Volny and Gregory T. Blackman Jr.

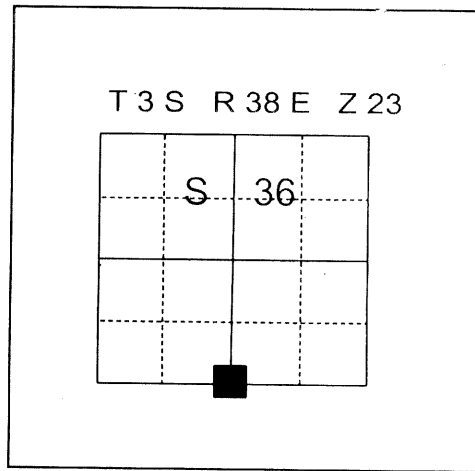

REGISTERED
PROFESSIONAL
LAND SURVEYOR

Rick G. Robinson

OREGON
July 17, 1986
RICK G. ROBINSON
2219

Renewal Date December 31, 2002

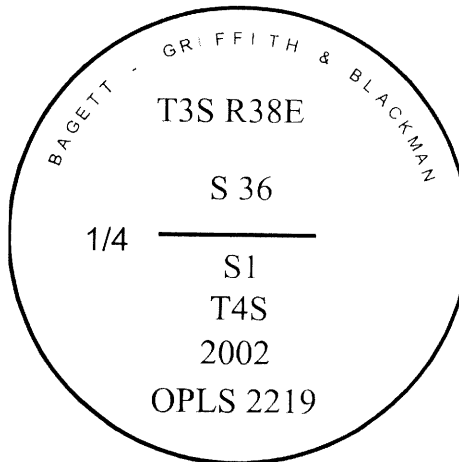

**UNION COUNTY
SURVEYOR**

Date Received 9/17/02

Date Filed 9/18/02

Filed By *Gregory T. Blackman Jr.*

File Number 029-2002R

I used a Leica 530 GPS in the establishment of the new accessories. The basis of bearing is the same as shown on Survey No. 034-2002, the distances are to the center of the aluminum cap.

HORIZONTAL CONTROL DATA
UNION COUNTY, OREGON
OREGON STATE PLANE, NORTH ZONE (3601)

STA NAME: 200607

1/4 SECTION CORNER COMMON TO SECTIONS 36 and 1

TWP. 3 S. RGE. 38 E.
& 4

GEODETIC COORD: NAD 83(91)

DATE TIED: October 3, 2006

LAT: 45 ° 15 ' 11.21200 " N

SURVEYOR: RICK G. ROBINSON
OPLS 2219

LONG: 118 ° 0 ' 14.58350 " W

FIRM: BAGETT, GRIFFITH, & BLACKMAN
2006 Adams Avenue
La Grande, OR 97850
(541) 963-6092

SP. COOR: NAD 83(91)

N: 588301.601 INT FT.

E: 8844743.034 INT FT.

TYPE: GPS

THETA: 1 ° 46 ' 12.3317363 "

ORDER: SECOND CLASS: 1

SCALE FACTOR: 0.999895664

ELEV: 2730.17 US FT.

ELEV: DATUM: NGVD 29

COMMENTS:

Corner is a 5/8"x30" iron pin
2 1/2" aluminum cap marked:

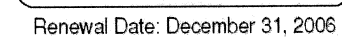
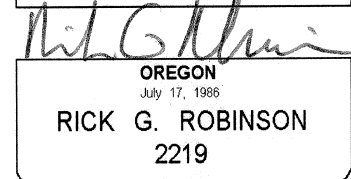
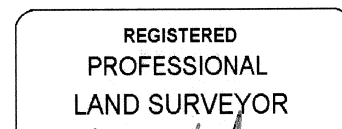
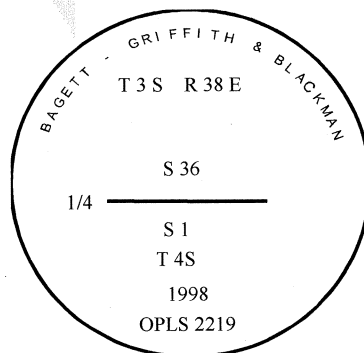

Renewal Date: December 31, 2006

1 METER = 3.280833333... US FEET = 39.37 INCHES

1 METER = 3.280839895 INT'L FEET OR 1 INCH = 2.54 CM

TO CALCULATE ELEVATION FACTOR (IN THE NORTH AMERICAN CONTINENT)

DIVIDE 20,906,000 BY (20,906,000 + ELLIPSOID ELEV. IN FEET)