

CERTIFIED RECORD OF LAND CORNER MONUMENTATION

HISTORY OF ORIGINAL CORNER ESTABLISHMENT:

Corner originally established by W.Barr under GLO contract number 388, dated May 7, 1863. Surveyor General records states:

Set post in mound of rock from which:

- A 20" Pine bears S25°E, 451ks.
 - A 24" Pine bears S62°W, 981ks.
 - A 30" Pine bears N75°W, 401ks.
 - A 20" Pine bears N25°E, 401ks.
- as per instructions.

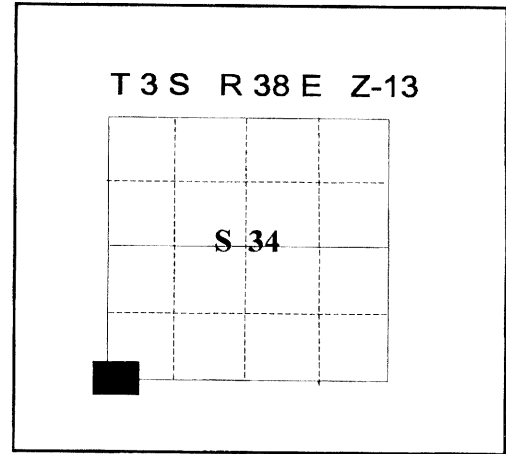

DESCRIPTION OF CORNER EVIDENCE FOUND:

Found dead and down rotted stump with partial tree left. Both blazes evident with visible scribes, found by Survey No. 045-1999.

DESCRIPTION OF MONUMENT AND ACCESSORIES I ESTABLISHED TO PERPETUATE THE ORIGINAL LOCATION OF THIS CORNER:

At the corner position, I set a 2 ½ x 30" aluminum monument with cap marked as shown below, 24" in the ground with three foot mound of stone from which;

NEW BEARING OBJECTS:

- A 16" Douglas fir bears N20°E, 60.44 feet, marked T3S R38E S34 BT.
- A 10" Douglas fir bears S81°E, 38.71 feet, marked T4S R38E S3 BT.
- A 15" Douglas fir bears S84°W, 34.20 feet, marked T4S R38E S4 BT.
- A 14" Douglas fir bears N56°W, 57.55 feet, marked T3S R38E S33 BT.

I hereby certify that the corner was monumented on May 1, 2000.

Witness: Gregory T. Blackman and Greg T. Blackman Jr.

REGISTERED
PROFESSIONAL
LAND SURVEYOR

Gregory T. Blackman
OREGON
JULY 13, 1973
GREGORY T. BLACKMAN
991

Renewal Date: Dec. 31, 2001

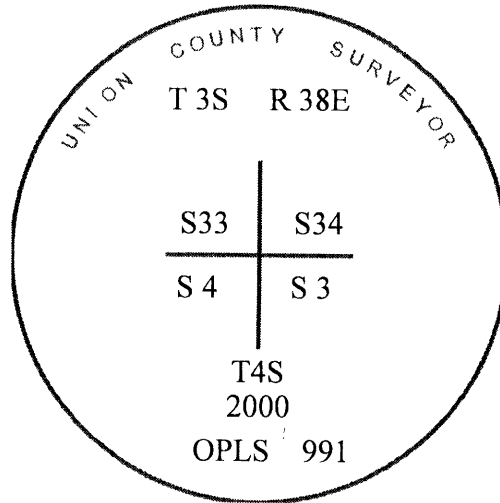

UNION COUNTY SURVEYOR

Date Received 7/13/00

Date Filed 7/15/00

Filed By R. ROBINSON DEPUTY

File Number 002-2000R

I used a steel tape and magnetic compass in the establishment of the new accessories. I used 18° East declination, the distances are to a 60d spike driven in the right side of the root crown.