

RTIFIED RECORD OF LAND CORNER MONUMEN .TION

HISTORY OF ORIGINAL CORNER ESTABLISHMENT:

Corner originally established by Herman D. Gradon under GLO contract Number 452, dated June 6, 1882. Surveyor General record states: Set a post 3 ft. long 3 ins square 24 ins in the ground for 1/4 sec cor. marked 1/4 S on W. face from which:

A pine 45 ins diam bears S 45° E 76 lks dist marked 1/4 SBT. A tamarack 22 ins diam bears N 88° W 36 lks dist marked 1/4 SBT.

No record of subsequent monumentation found in the Union County monumentation records.

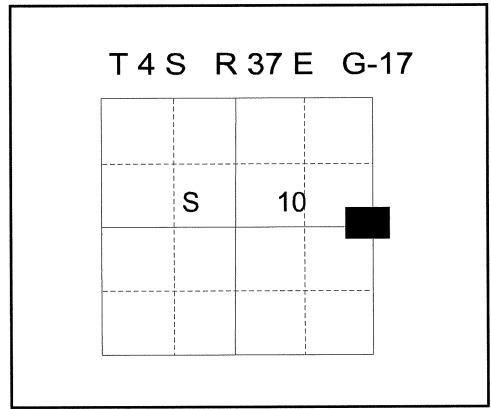

DESCRIPTION OF CORNER EVIDENCE FOUND:

Found no evidence of the original corner monument, or its' accessories

See Union County Survey Number 013-2009

DESCRIPTION OF MONUMENT AND ACCESSORIES I ESTABLISHED

TO PERPETUATE THE ORIGINAL LOCATION OF THIS CORNER:

At position determined by survey, I set a 2 1/2" x 30" Aluminum pipe, with aluminum cap marked as shown, 24" in the ground, from which:

A 10" Douglas Fir bears North 19° East, a distance of 42.04 feet, marked 1/4 S11 BT.

A 12" Ponderosa Pine bears South 88° East, a distance of 74.12 feet, marked 1/4 S11 BT.

A 6" White Fir bears South 88° West, a distance of 20.18 feet, marked X BT.

A 9" Ponderosa Pine bears North 41° West, a distance of 13.50 feet, marked 1/4 S10 BT.

I hereby certify that the corner was perpetuated on June 11, 2009

Witness: Gregory T. Blackman, Jr.

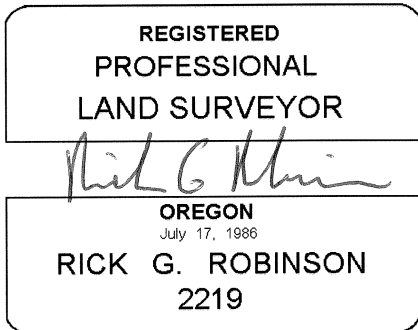

Renewal Date: December 31, 2010

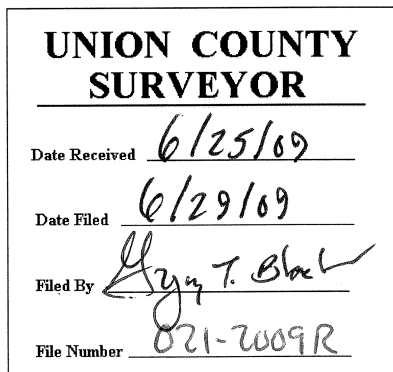
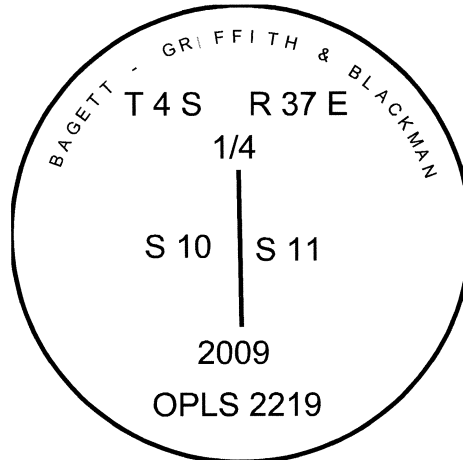

I used a steel tape and magnetic compass in the establishment of the bearing trees. I used 18° East declination. I attached a brass washer marked OPLS 2219 to the BT blaze. The distance is to a 60d spike driven into the root crown at the right side of the new bearing tree.