

CERTIFIED RECORD OF LAND CORNER MONUMENTATION

HISTORY OF ORIGINAL CORNER ESTABLISHMENT:

Corner originally established by Herman D. Gradon under GLO contract Number 452, dated June 16, 1882. Surveyor General record states:

Set a basalt stone 12x8x6 inches, 8 inches in the ground for 1/4 section corner, marked 1/4 on W. Face, From Which:

A Mahogany 14" in diameter bears N45°E, 70 lks. marked 1/4 S BT

A Pine 18" in diameter bears N10°W, 130 lks. marked 1/4 S BT

No record of subsequent monumentation found in Union County survey records

DESCRIPTION OF CORNER EVIDENCE FOUND:

Found 10 Mahogany dead and down, scribes visible.
Fount Stone 12x7x6 firmly set, marked 1/4 on West Face

DESCRIPTION OF MONUMENT AND ACCESSORIES I ESTABLISHED

TO PERPETUATE THE ORIGINAL LOCATION OF THIS CORNER:

At the stone position, I set a 2 1/2"x30" aluminum pipe with aluminum cap marked as shown below, 12" in the ground and raised a mound of stone with a 3 foot base to the top of the cap, from Which, New BT's:

A 60" boulder bears N 10°E, a distance of 24.20 feet, marked X BO

A 7" diameter double bole Mahogany bears N 71°E, a distance of 34.38 feet, marked 1/4 S8, BT

A 22" diameter Ponderosa Pine bears S 0°E, a distance of 20.72 feet, marked T4SR37E S8 BT

A 5" diameter Ponderosa Pine bears S 17 W, a distance of 108.35 feet, marked X BT

I hereby certify that the corner was monumented on August 8, 2004
Witness: Mike Spicer

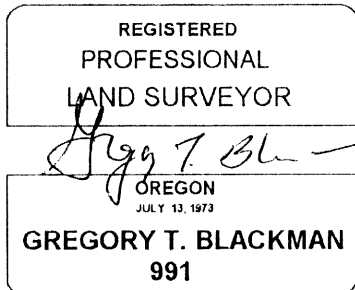
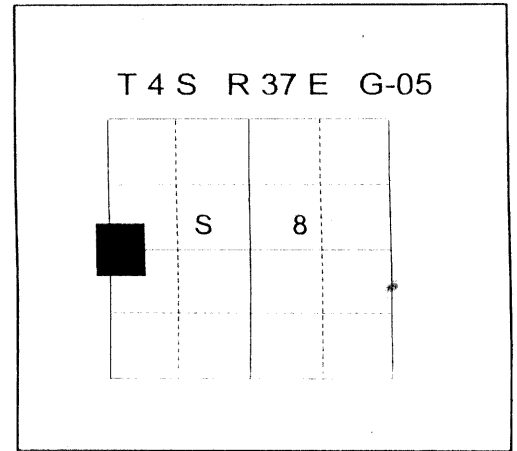

Renewal Date: December 31, 2005

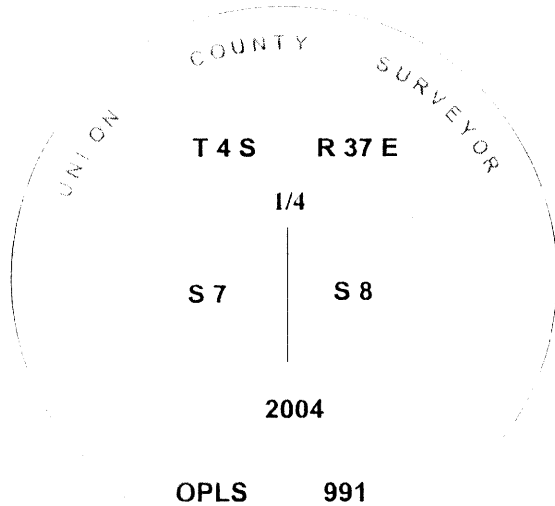

UNION COUNTY SURVEYOR

Date Received 12/1/04

Date Filed 12/30/04

Filed By Gregory T. Blackman

File Number 100-2004R

I used a steel tape and magnetic compass in the establishment of new accessories. The magnetic declination used was 18° East. The distance to the bearing trees are to a 50d spike driven on the right side of the tree at the root crown. I attached a brass washer marked OPLS 991 to the BT Blaze

G-05

CERTIFIED RECORD OF LAND CORNER MONUMENTATION

HISTORY OF ORIGINAL CORNER ESTABLISHMENT:

Corner originally established by Herman D. Gradon under GLO contract Number 452, dated June 16, 1882. Surveyor General record states:

Set a basalt stone 12x8x6 inches, 8 inches in the ground for 1/4 section corner, marked 1/4 on W. Face, From Which:

A Mahogany 14" in diameter bears N45°E, 70 lks. marked 1/4 S BT

A Pine 18" in diameter bears N10°W, 130 lks. marked 1/4 S BT

No record of subsequent monumentation found in Union County survey records

DESCRIPTION OF CORNER EVIDENCE FOUND:

Found 10 Mahogany dead and down, scribes visible. Found Stone 12x7x6 firmly set, marked 1/4 on West Face

DESCRIPTION OF MONUMENT AND ACCESSORIES I ESTABLISHED TO PERPETUATE THE ORIGINAL LOCATION OF THIS CORNER:

At the stone position, I set a 2 1/2"x30" aluminum pipe with aluminum cap marked as shown below, 12" in the ground and raised a mound of stone with a 3 foot base to the top of the cap, from Which, New BT's:

A 60" boulder bears N 10°E, a distance of 24.20 feet, marked X BO

A 7" diameter double bole Mahogany bears N 71°E, a distance of 34.38 feet, marked 1/4 S8, BT

A 22" diameter Ponderosa Pine bears S70°E, a distance of 20.72 feet, marked T4SR37E S8 BT

A 5" diameter Ponderosa Pine bears S 17 W, a distance of 108.35 feet, marked X BT

I hereby certify that the corner was monumented on August 8, 2004
Witness: Mike Spicer

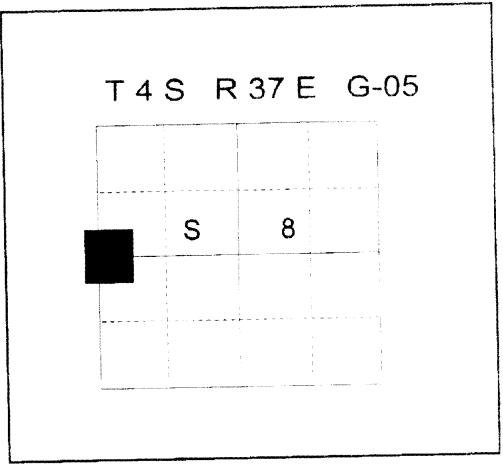

REGISTERED
PROFESSIONAL
LAND SURVEYOR

Greg T. Blackman

OREGON
JULY 13, 1973
GREGORY T. BLACKMAN
991

Renewal Date: December 31, 2005

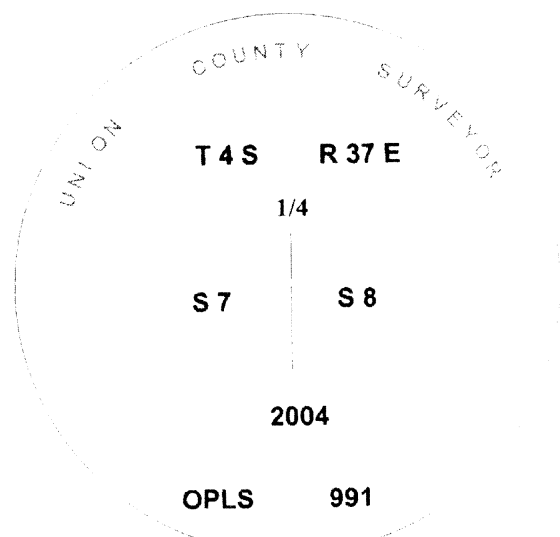

UNION COUNTY SURVEYOR

Date Received 12/16/04

Date Filed 12/30/04

Filed By *Greg T. Blackman*

File Number 100-2004R

I used a steel tape and magnetic compass in the establishment of new accessories. The magnetic declination used was 18° East. The distance to the bearing trees are to a 50d spike driven on the right side of the tree at the root crown. I attached a brass washer marked OPLS 991 to the BT Blaze

G-05