

CERTIFIED RECORD OF LAND CORNER MONUMENTATION

HISTORY OF ORIGINAL CORNER ESTABLISHMENT:

The corner was originally established by Herman D. Gradon under GLO contract No. 452 dated June 6, 1882. The Surveyor General Record states: Set a basalt stone 22x10x8 ins 16 ins in the ground, for 1/4 sec cor, marked 1/4 on N. Face, from which
 A pine 22 ins diam bears N30°E, 153 lks dist., marked 1/4 S.B.T.
 A pine 14 ins diam bears S65°W, 85 lks dist., marked 1/4 S.B.T.

U.S. Forest Service corner records indicate that this corner was searched for in September of 1986 with no monument or accessories found.

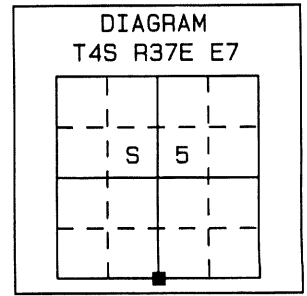

I found no subsequent record of monumentation in the Union County survey records.

DESCRIPTION OF CORNER EVIDENCE FOUND:

None.

DESCRIPTION OF MONUMENT AND ACCESSORIES I ESTABLISHED TO PERPETUATE THE ORIGINAL LOCATION OF THIS CORNER:

At the proportionate position I set a 2 1/4" Brass Cap on a 1 3/8" x 30" galvanized iron pipe 27" in the ground with a 24" collar of stone around it. I stamped the cap as shown below.

I marked four bearing trees. Each bearing tree has a 1 1/2" brass washer fastened between the letters B and T with a 2" PK nail. The washer is stamped WTS and 56295 LS. Measurements were taken to the dent in the head of the nail with a Trimble 5601 electronic total station. Bearings are based on the survey control for County Survey No. 032-2004.

- A 13" Ponderosa Pine bears N24°00'29"W, 22.31', scribed 1/4 S5 BT.
- A 14" Ponderosa Pine bears N40°03'52"E, 34.41', scribed 1/4 S5 BT
- A 12" Ponderosa Pine bears S09°34'15"W, 39.62', scribed 1/4 S8 BT
- A 12" Ponderosa Pine bears S35°19'50"W, 54.09', scribed 1/4 S8 BT

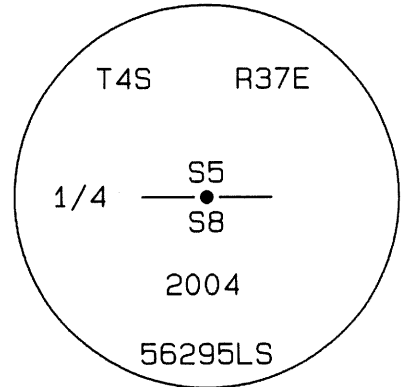

I hereby certify that the above corner point was reestablished as hereon described on September 2, 2004.

Witness: David Haddock.

**REGISTERED
PROFESSIONAL
LAND SURVEYOR**

Stephen K. Haddock

OREGON
JULY 9, 2001
STEPHEN K. HADDOCK
56295LS

RENEWAL DATE 6-30-05

**UNION COUNTY
SURVEYOR**

Date Received 12/8/04

Date Filed 12/10/04

By R. Robinson DEPUTY

File No. 080-2004R

CERTIFIED RECORD OF LAND CORNER MONUMENTATION

HISTORY OF ORIGINAL CORNER ESTABLISHMENT:

The corner was originally established by Herman D. Gradon under GLO contract No. 452 dated June 6, 1882. The Surveyor General Record states: Set a basalt stone 22x10x8 ins 16 ins in the ground, for 1/4 sec cor, marked 1/4 on N. Face, from which
 A pine 22 ins diam bears N30°E, 153 lks dist., marked 1/4 S.B.T.
 A pine 14 ins diam bears S65°W, 85 lks dist., marked 1/4 S.B.T.

U.S. Forest Service corner records indicate that this corner was searched for in September of 1986 with no monument or accessories found.

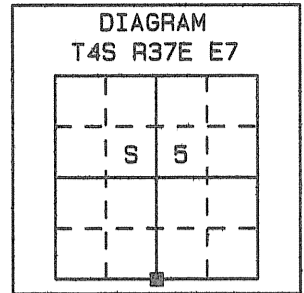

In survey 032-2004 I set a 2 1/4" Brass Cap on a 1 3/8" x 30" galvanized iron pipe at the proportionate point. I stamped the cap as shown under evidence found.

I marked four bearing trees. Each bearing tree has a 1 1/2" brass washer fastened between the letters B and T with a 2" PK nail. The washer is stamped WTS and 56295 LS.

- A 13" Ponderosa Pine bears N24°00'29"W, 22.31', scribed 1/4 S5 BT.
- A 14" Pondersa Pine bears N40°03'52"E, 34.41', scribed 1/4 S5 BT
- A 12" Pondersa Pine bears S09°34'15"W, 39.62', scribed 1/4 S8 BT
- A 12" Pondersa Pine bears S35°19'50"W, 54.09', scribed 1/4 S8 BT

I found no subsequent record of monumentation in the Union County survey records.

DESCRIPTION OF CORNER EVIDENCE FOUND:

At the proportionate point I found the brass cap and the bearing trees as described in good condition.
 At the true corner location I found the original basalt stone, 19" x 9" x 6", plainly marked 1/4 on its north face, tipped onto its east side. I found the rotted stump of the original northeast bearing tree, N30°E, 99.0'. There were no identifiable remains of the southwest bearing tree.

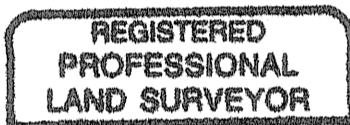

Stephen K. Haddock

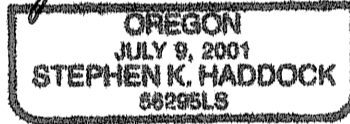

RENEWAL DATE 6-30-07

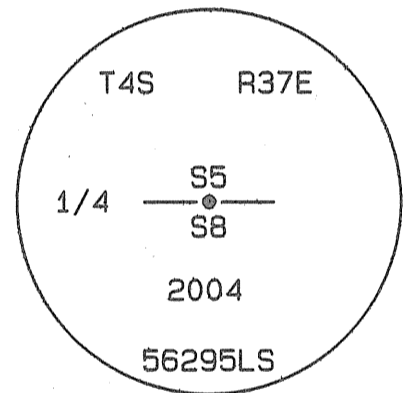

DESCRIPTION OF MONUMENT AND ACCESSORIES I ESTABLISHED TO PERPETUATE THE ORIGINAL LOCATION OF THIS CORNER:

I cut the brass cap off of the monument I set at the proportionate point but left that pipe in place. I obliterated the scribing from the blazes of the two bearing trees in Section 5 and I remarked those faces with an "X".

At the position of the original stone I set a 2 1/2" brass cap on a 1 3/8" x 30" galvanized iron pipe 24 inches into the ground to bedrock. I built a mound of earth and stone, 24" diameter to the top of the cap and marked the cap as shown below. I buried the original stone on the north side of the monument.

I marked two new bearing trees and held the two trees I previously set in Section 8. Each bearing tree has a 1 1/2" brass washer fastened between the letters B and T with a 2" PK nail. The washer is stamped WTS and 56295 LS. Measurements were taken to the dent in the head of the nail with a Trimble 5601 electronic total station. Bearings are based on the survey control for Union County Survey No. 032-2004. The correct bearing trees are now described as:

- A 14" Ponderosa Pine bears N12°06'28"W, 43.54', scribed 1/4 S5 BT.
 - A 15" Pondersa Pine bears N48°08'47"E, 11.41', scribed 1/4 S5 BT
 - A 12" Pondersa Pine bears S21°09'40"W, 96.54', scribed 1/4 S8 BT
 - A 12" Pondersa Pine bears S6°49'06"W, 85.58', scribed 1/4 S8 BT
- The pipe from the previous monument I set bears S4°27'00"W, 46.04'.

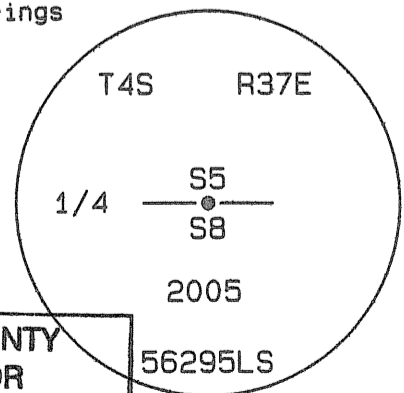

I hereby certify that the above corner point was reestablished as hereon described on September 24, 2005. *S.K.H.*

Witness: William R. Wells, PLS 1106.

UNION COUNTY SURVEYOR

Date Received 10/11/05

Date Filed 10/21/05

By *[Signature]*

File No. 050-2005R