

CERTIFIED RECORD OF LAND CORNER MONUMENTATION

C-9

History of original corner establishment:

Original subdivision survey of T4S R35E by Rufus S. Moore, under Contract No. 451, dated June 12, 1882.

Set a basalt stone 20"x15"x8", 15 ins. in the ground for 1/4 Sec. Cor. marked 1/4 on W. face. Raised mound of stone alongside, pits impracticable.

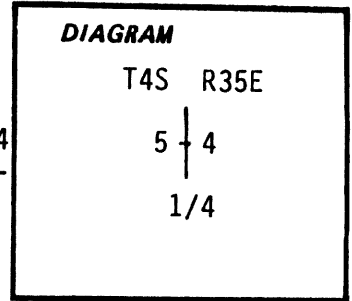

Description of corner evidence found:

Found the original corner monument, a basalt stone, 15"x13"x8" lying face down in a rock jack corner of fences running E, N and SW, marked with a distinctly chiseled "1/4" on a face.

Description of monument and accessories I established to perpetuate the original location of this corner:

We accept the position of the found stone as the best available evidence of the original corner position. We set a 2"x30" galvanized iron pipe, 10" in the ground to bedrock, with brass cap, marked:

Union Co. Surveyor

T4S R35E

S5 + S4

1/4

PLS 1099

1984

We place the original corner stone along the South side of the iron pipe and rebuild the stone mound around the iron pipe and fence corner.

Placed steel fence post with "ATTENTION" sign attached, approx. 5 ft. south of iron pipe.

November 7, 1984

Witnesses:

Gary Langlitz, Deputy Co. Surveyor
Dave Dahlstrom, U.S. Forest Service



UNION COUNTY SURVEYOR
Date Received <u>11-13-84</u>
Date Filed <u>11-13-84</u>
By <u>G. LANGLITZ, DEPUTY</u>
File No. <u>1037-84R</u>

Office of..... County of.....
State of....., I hereby certify that the within instrument was filed in this office
for record on the..... day of....., 19.....

..... by
(COUNTY OFFICIAL) (DEPUTY)

CERTIFIED RECORD OF LAND CORNER MONUMENTATION

HISTORY OF ORIGINAL CORNER ESTABLISHED:

Corner was established by Rufus S. Moore under GLO contract number 451 dated June 12, 1882. Surveyor General field notes state:
Set a basalt stone 20x15x8 ins. 15 ins. in ground for 1/4 sec. cor. marked 1/4 on W. face. Raised mound of stone alongside, pits impractical.

In 1984 Gary Langlitz, PLS 1099, found the stone. Union County Monumentation record 1037-84R states:
Found the original basalt stone, 15"x13"x8" lying face down in a rock jack corner of fences running E, N, and SW, marked with a distinctly chiseled 1/4 on a face. We Set a 2"x30" galvanized iron pipe, 10" in the ground to bedrock, with brass cap, marked as shown.
We place the original corner stone along the South side of the iron pipe and rebuild the stone mound around the iron pipe and fence corner.
Placed steel fence post with sign approx. 5 ft. South of iron pipe.

T 4 S R 35 E C-09

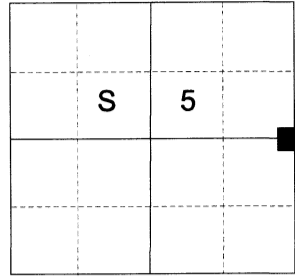

DESCRIPTION OF CORNER EVIDENCE FOUND:

Found a 2 1/2" iron pipe with 2 1/2" brass cap marked as shown below, 10" above ground and in a 3' diam. mound of stone.

DESCRIPTION OF MONUMENT AND ACCESSORIES I ESTABLISHED TO PERPETUATE THE ORIGINAL LOCATION OF THIS CORNER:

From the iron pipe monument:

NEW BEARING OBJECTS:

- A 5/8" x 15" iron pin bears North 5°19' East, a dist. of 23.27 ft., with 1 1/2" aluminum cap marked N RP
- A 5/8" x 15" iron pin bears South 85°27' East, a dist. of 33.16 ft., with 1 1/2" aluminum cap marked E RP
- A 5/8" x 15" iron pin bears South 00°14' West, a dist. of 34.02 ft., with 1 1/2" aluminum cap marked S RP
- A 5/8" x 15" iron pin bears South 88°46' West, a dist. of 37.37 ft., with 1 1/2" aluminum cap marked W RP

Steel fence post with sign bears approx. 1' West.

Monument falls approx. 1' Southwest of fence corner to North/South/East bearing fence lines.

I hereby certify that the corner was perpetuated on December 3, 2020.

Witness: Kyle A. Tucker

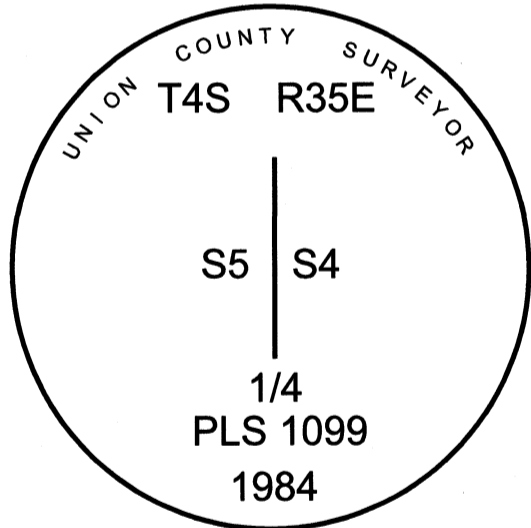

Renewal Date: June 30, 2021

UNION COUNTY SURVEYOR	
Date Received	12/9/2020
Date Filed	12/9/2020
Filed By	<i>Jeffrey S. HSU</i>
File Number	087-2020R

I used a Leica GS18 with RTK in the establishment of the new accessories. Basis of Bearing is derived from the Oregon Coordinate Reference System Pendleton-LaGrande. The distances and bearings are to the center of the aluminum caps.

HORIZONTAL CONTROL DATA

UNION COUNTY, OREGON

OREGON STATE PLANE, NORTH ZONE (3601)

STA NAME: 2026047

1/4 SECTION CORNER COMMON TO SECTIONS 4 AND 5

TWP. 4 S RGE. 35 E.

GEODETIC COORD: NAD 83(91)

DATE TIED: DECEMBER 3, 2020

LAT: 45 ° 14 ' 51.22567 " N

SURVEYOR: RICK G ROBINSON
OPLS 2219

LONG: 118 ° 26 ' 41.66723 " W

FIRM: BAGETT, GRIFFITH, & BLACKMAN
2006 ADAMS AVENUE
LAGRANDE, OR 97850
(541) 963-6092

SP. COOR: NAD 83(91)

N: 583081.040 INT FT.

E: 8731312.283 INT FT.

TYPE: GPS

THETA: 1 ° 27 ' 26.7941511 "

ORDER: SECOND CLASS: 1

SCALE FACTOR: 0.9998955264

ELEV: 3742.64 US FT.

ELEV: DATUM: NGVD 29

COMMENTS:

2" iron pipe with 2 1/2" brass cap marked as shown, set in mound of stone

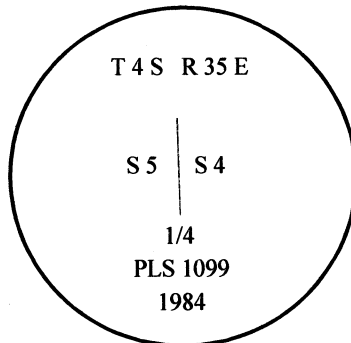

REGISTERED
PROFESSIONAL
LAND SURVEYOR

Rick G. Robinson

OREGON
July 17, 1986

RICK G. ROBINSON
2219

Renewal Date: December 31, 2020

1 METER = 3.2808333333... US FEET = 39.37 INCHES

1 METER = 3.280839895 INT'L FEET OR 1 INCH = 2.54 CM

TO CALCULATE ELEVATION FACTOR (IN THE NORTH AMERICAN CONTINENT)

DIVIDE 20,906,000 BY (20,906,000 + ELLIPSOID ELEV. IN FEET)