

CERTIFIED RECORD OF LAND CORNER MONUMENTATION

History of original corner establishment:

Original corner established by Rufus Moore in 1882.

Set post 4 ft long 5 ins square 18 ins in ground with mound of stone 2 ft high and 3 ft diam at base around post for closing cor. to Tps 4S. R.34 and 35E. marked C.C. T4S on S. R35E S6 on E and R34E S1 on W. faces in prairie sloping gently south 100 ft above creek.

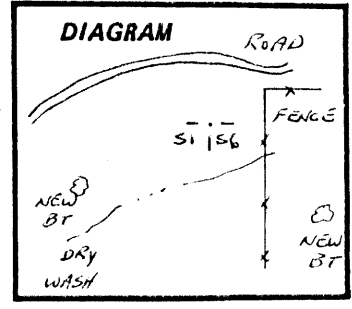

Description of corner evidence found:

None

UNION COUNTY SURVEYOR
Date Received 10-2-86
Date Filed 10-13-86
By G. LANGUITZ, DEPUTY
File No. 173-86 R

SEE SURVEY 35-86

Description of monument and accessories established to perpetuate the original location of this corner:

Set 2" x 30" galvanized iron pipe with 2 1/2" brass cap marked: Pipe is set in ground 26" with a collar of stone. A steel fence post is set 5' from the brass cap with a USFS Land Survey Monument sign attached.

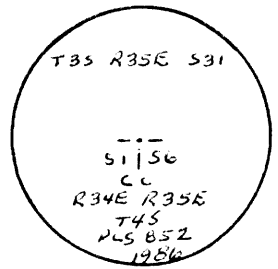

New Bearing Trees:

A 17" diameter Ponderosa Pine bears S66°30'W, 162.2' scribed T4S R34E S1 CC BT in a single blaze. A 24" diameter Ponderosa Pine bears S50°00'E, 264.0' scribed T4S R35E S6 CC BT in a single blaze. Each tree is painted with a 6" red band and has 3/4" aluminum washer stamped RLS 852 nailed between the letters B and T. A USFS Bearing Tree and Land Survey Monument sign is attached to each tree.

I hereby certify the above corner point was re-established as hereon described September 10, 1986.

REGISTERED PROFESSIONAL LAND SURVEYOR

David L. Haddock

OREGON JULY 12, 1968 DAVID L. HADDOCK 852

Office of..... County of.....
State of....., I hereby certify that the within instrument was filed in this office for record on the..... day of....., 19.....
(COUNTY OFFICIAL) by (DEPUTY)

Index File No. A-25 A-1
 CORNER RECORD (SEARCH) Tract or Survey No. _____ Cor. No. _____
 T 4 S R. 35 E R.D. La Grande County Union
 Merid. Will N.F. Wallow-Whitman State Oregon

CORNER DIAGRAM

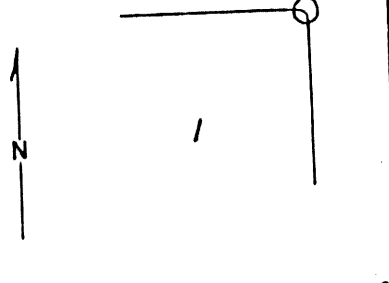

DESCRIBE CORNER MONUMENT FOUND

DESCRIBE BEARING TREES OR OTHER OFFICIAL ACCESSORIES FOUND

Forest Service location. posted 5" D.F. down & dead.
 Resdock, April 16, 1948 says corner is here.

PHOTO IDENTIFICATION DATA

Photo No. _____
 Filed At. _____
 Object Ident. _____
 Ident. By _____
 Signature _____

DESCRIBE CORNER LOCATION RELATIVE TO NEAR-BY FEATURES, ALSO HOW TO REACH CORNER

PLANE COORDINATE POSITION DATA

State _____ Zone _____
 X _____
 Y _____
 Estab. By _____
 Agency _____

Signature T. Williams Title _____ Division _____ Headquarters _____ Date 1-24-68 7100-52 REV. 65 5

UNION COUNTY SURVEYOR
 Date Received _____
 Date Filed 12-21-87
 By G. LANGLITZ, DEPUTY
 File No. 301-87R

A-25 A-1

CERTIFIED RECORD OF LAND CORNER MONUMENTATION

HISTORY OF ORIGINAL CORNER ESTABLISHED:

Corner was established by Rufus S. Moore under GLO contract number 451 dated June 12, 1882. Surveyor General field notes state:
 Set post 4 ft. long, 5 ins. square, 18 ins. in ground with mound of stone 2 ft. high and 3 ft. diam. at base around post for closing cor. to Tps. 4S. R.34 and 35 E. marked C.C. T4S on S. R35E S6 on E and R34E S1 on W. faces in prairie sloping gently South 100 ft. above creek.

In 1986 David Haddock, PLS 852, found no evidence of the original corner and re-established it by proportion from found corners. Union County Monumentation record 173-86R states: See Survey 35-86. Set a 2"x30" galvanized iron pipe with 2 1/2" brass cap. Pipe is set in ground 26" with a collar of stone from which:
 A 17" Ponderosa Pine bears S66°30'W, 162.2' scribed T4S R34E S31 CC BT
 A 24" Ponderosa Pine bears S50°00'E, 264.0' scribed T4S R35E S6 CC BT

T 4 S R 35 E A01

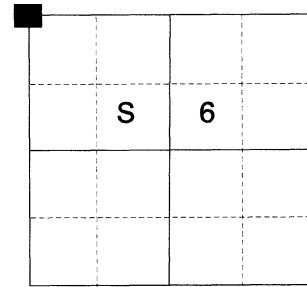

DESCRIPTION OF CORNER EVIDENCE FOUND:

Found a 2 1/2" iron pipe with 2 1/2" brass cap marked as shown below, 4" above ground, from which:
 A 30" Ponderosa Pine bears South 50° East, a dist. of 264.00 ft., alive and vigorous with healed blaze.
 A 22" Ponderosa Pine bears South 67° West, a dist. of 162.20 ft., alive and vigorous with healed blaze.

DESCRIPTION OF MONUMENT AND ACCESSORIES I ESTABLISHED TO PERPETUATE THE ORIGINAL LOCATION OF THIS CORNER:

From the iron pipe monument:

NEW BEARING OBJECTS:

A 5/8" x 30" iron pin bears South 44° East, a dist. of 13.50 ft., with 1 1/2" aluminum cap marked E RP
 A 5/8" x 30" iron pin bears South 36° West, a dist. of 11.60 ft., with 1 1/2" aluminum cap marked W RP

Monument falls approx. 10' West of a North/South bearing fence line.

The terminus of East bearing Baseline Road bears North approx. 75 ft.

A fencepost falls West approx. 5 ft.

I hereby certify that the corner was perpetuated on December 1, 2020.

Witness: Kyle A. Tucker

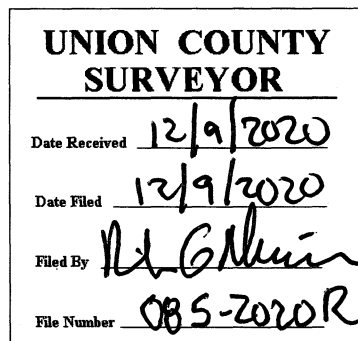
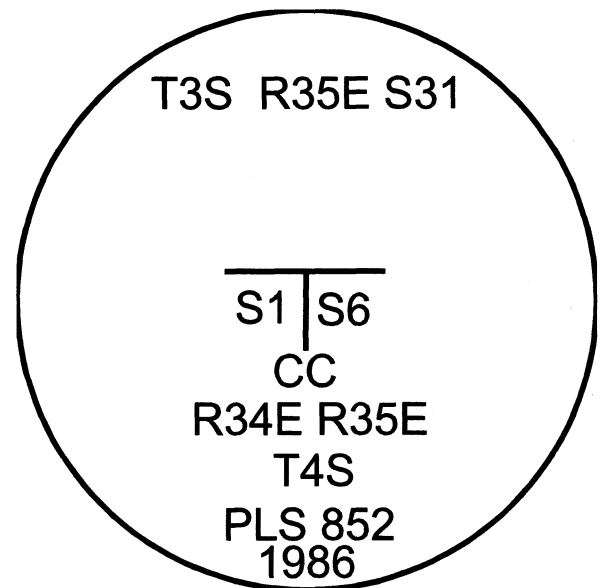

I used a steel tape and magnetic compass in the establishment of the new accessories. I used 14° East declination, the distances are to a 60d spike driven into the right side of the root crown of the bearing trees. A brass washer marked OPLS 83571 is attached to the BT blaze of the new bearing trees. Distances and bearings for the iron pins are to the center of the aluminum caps.

HORIZONTAL CONTROL DATA

UNION COUNTY, OREGON

OREGON STATE PLANE, NORTH ZONE (3601)

STA NAME: 2020042

SECTION CORNER COMMON TO SECTIONS 1 AND 6 ONLY

TWP. 4 S RGE. 34 & 35 E.

GEODETIC COORD: NAD 83(91)

DATE TIED: DECEMBER 1, 2020

LAT: 45 ° 15 ' 10.19467 " N

SURVEYOR: RICK G ROBINSON
OPLS 2219

LONG: 118 ° 29 ' 6.37566 " W

FIRM: BAGETT, GRIFFITH, & BLACKMAN
2006 ADAMS AVENUE
LAGRANDE, OR 97850
(541) 963-6092

SP. COOR: NAD 83(91)

N: 584740.763 INT FT.

E: 8720915.360 INT FT.

TYPE: GPS

THETA: 1 ° 25 ' 44.1689533 "

ORDER: SECOND CLASS: 1

SCALE FACTOR: 0.9998956568

ELEV: 3755.62 US FT.

ELEV: DATUM: NGVD 29

COMMENTS:

2" iron pipe with 2 1/2" brass cap marked as shown, set in mound of stone

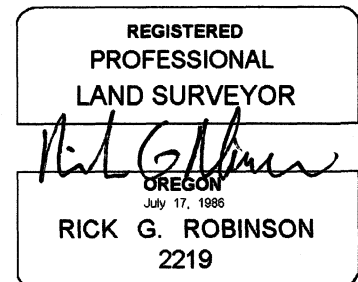
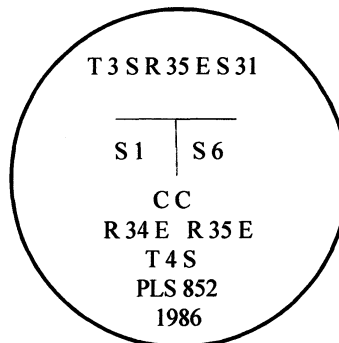

Renewal Date: December 31, 2020

1 METER = 3.2808333333... US FEET = 39.37 INCHES

1 METER = 3.280839895 INT'L FEET OR 1 INCH = 2.54 CM

TO CALCULATE ELEVATION FACTOR (IN THE NORTH AMERICAN CONTINENT)

DIVIDE 20,906,000 BY (20,906,000 + ELLIPSOID ELEV. IN FEET)