

CERTIFIED RECORD OF LAND CORNER MONUMENTATION

History of original corner establishment:

Not previously set.

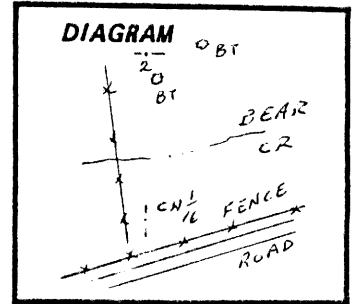

Description of corner evidence found:

Not previously set.

UNION COUNTY SURVEYOR

Date Received 10-2-86

Date Filed 10-13-86

By G. LANGLITZ DEPUTY

File No. 177-86 R

See Survey 35-86

Description of monument and accessories I established to perpetuate the original location of this corner:

Set a 2" x 30" galvanized iron pipe with 2 1/2" brass cap marked: Pipe is set 26" into the ground with a collar of stone. A steel fence post is set 5' from the brass cap with a USFS Land Survey Monument sign attached.

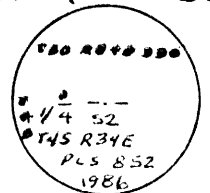

Bearing Trees:

A 10" Douglas Fir bears N 76°00'E, 22.7' scribed 1/4 S BT in a single blaze. A 16" Tamarack bears S30°00'E, 6.4" scribed 1/4 S BT in a single blaze. A 3/4" aluminum washer stamped RLS 852 is nailed between the letters B and T on each tree. A 6" red band is painted around each tree and USFS Bearing Tree and Land Survey Monument signs attached. The corner is immediately south of a 53" Tamarack not used as a bearing tree.

I certify the above corner point was established as hereon described on September 10, 1986.

**REGISTERED
PROFESSIONAL
LAND SURVEYOR**

David L. Haddock

**OREGON
JULY 12, 1988
DAVID L. HADDOCK
852**

Office of..... County of.....
 State of....., I hereby certify that the within instrument was filed in this office
 for record on the..... day of....., 19.....
 by
 (COUNTY OFFICIAL) (DEPUTY)