

CERTIFIED RECORD OF LAND CORNER MONUMENTATION

Index File No. V-3

History of original corner establishment:

Corner established by Frank W. Campbell under G.L.O. Contract #507 in August, 1884. Surveyor's General's notes state: "Set a Fir post 3 ft. long, 3 ins. square, 24 ins. in ground for 1/4 Sec. corner marked 1/4S. on N. face, from which: A Tamarac 24 ins. diam. bears N. 21° E. 16lks. dist. marked 1/4 S.B.T.. A Fir 6 ins. diam. bears S. 4° W. 2.5lks. dist. marked 1/4 S.B.T.."

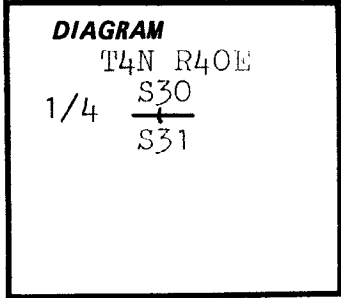

Description of corner evidence found:

No evidence of original corner could be found. A dilligent search was made before the survey and after the corner position was determined.

The surveyed position is about 200' West of track road and top of ridge.

Notes call for 3 chains from corner to top of ridge.

Description of monument and accessories | established to perpetuate the original location of this corner:

At single proportionate measurement between the SE and SW corner of section 30, set 2 1/2" x 30" galvanized pipe with brass cap marked: Set pipe 25" in the ground.

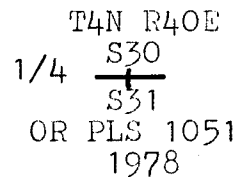

No rock in the area.

From which: A Fir 24" in dia. bears N15°E, 52.5 feet, scribed 1/4S30BT. A Fir 16" in dia. bears S79°W, 14.2 feet, scribed 1/4S31BT. Painted blazes red and 6" red band around. Placed 54-3s and 54-4s on BTs. Placed brass washer stamped PLS 1051 on foot blazes. Placed 54-4 on steel fence post 5' East of corner. Placed 54-5s on tree 5' West and on a tree 200' East and on West side of road.

I hereby certify that the above corner monument was reestablished as herein described.

Witnesses: David L. Landers
Dan T. Rowland

October 25, 1978

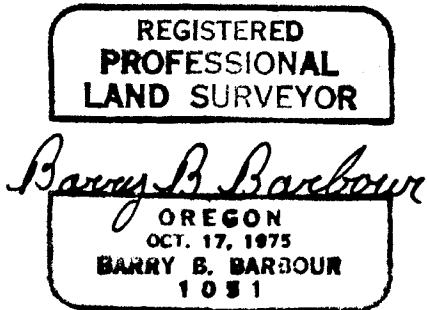

Office of _____ County Surveyor _____ County of _____ Union _____
State of _____ Oregon _____, I hereby certify that the within instrument was filed in this office
for record on the...20... day of...November....., 1978
_____ by _____
(COUNTY OFFICIAL) (DEPUTY)

UNION COUNTY SURVEYOR
Date Received _____
W. GPO 799-509
Date Filed _____
By _____
File No. 99-83R

CERTIFIED RECORD OF LAND CORNER MONUMENTATION

V-3

History of original corner establishment:

Corner was originally established by Deputy Frank W. Campbell in 1884 under contract #507.

Set: Fir post 3' long, 3" square, 24" in ground.

Marked: 24" Tamarack N21E, 16 lks.- 6" Fir S4W, 2.5 lks.

Corner was reestablished by OR PLS 1051 in 1978.

Found: No evidence of orig. corner could be found.

Set: At single proportionate measurement between the SE and SW corner of sec. 30, set 2 1/2"x30" gal. pipe with brass cap 25" in ground.

Marked: 24" Fir N15E, 52.5'- 16" Fir S79W, 14.2'.

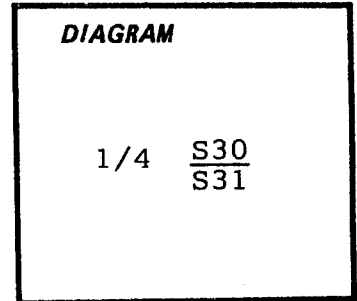

Description of corner evidence found:

2" gal. iron pipe with a 2 1/2" brass cap firmly set 6" above ground. Stamped:

T4N R40E

1/4 S30
S31

1978 24" Fir now 26" D-Fir N13E, 53.8'(record N15E, 52.5') Healed double blaze.

OR PLS 1051

1978 16" Fir now 14" Wh. Fir snag 15' tall S79W, 13.7'(record 14.2') Scribing visible on double blaze.

1978

Guard post East.

Description of monument and accessories established to perpetuate the original location of this corner:

Marked:

6" Spruce S84W, 87.8' Scribed 1/4 S31 BT.

20" Spruce S41 3/4W, 38.2' Scribed 1/4 S31 BT.

12" Wh. Fir S88E, 31.7' Scribed 1/4 S31 BT.

Nailed 54-9 and 54-3 signs to BT's, painted bands and blazes red and nailed a 1" brass disk stamped PLS 896 flush between the B and the T.

Reset East and set West guard post with 54-2 and 54-9 signs.

Dec. 20.

Witnesses: Norman Larson and Carole Bishop.

Work was done in June 1994.

REGISTERED PROFESSIONAL LAND SURVEYOR

Larry D. Bishop

OREGON JULY 11, 1983 LARRY D. BISHOP 828

EXPIRES 12/31/95

UNION COUNTY SURVEYOR Date Received 9/27/94 Date Filed 10/22/94 By Guyon T. Black File No. 070-1994R

County of..... State of..... I hereby certify that the within instrument was filed in this office for record on the..... day of....., 19..... by..... (COUNTY OFFICIAL) (DEPUTY)