

CERTIFIED RECORD OF LAND CORNER MONUMENTATION

HISTORY OF ORIGINAL CORNER ESTABLISHED:
Corner not previously established.

T 3 S R 41 E Y-01

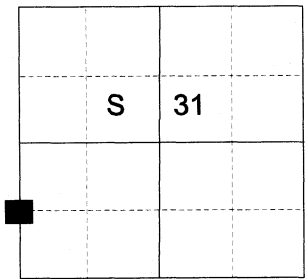

DESCRIPTION OF CORNER EVIDENCE FOUND:
None found.

DESCRIPTION OF MONUMENT AND ACCESSORIES I ESTABLISHED TO MONUMENT THE
ORIGINAL LOCATION OF THIS CORNER:

At position by survey I set a 5/8" x 30" iron pin, 26" in the ground, with 2 1/2" aluminum cap marked as shown below, from which:

NEW BEARING OBJECTS:

A 5/8" x 30" iron pin bears North 44° East, a dist. of 23.00 feet, with 1 1/2" aluminum cap marked BGB SURVEY MARKER.
A 12" Western Larch bears South 87° East, a dist. of 40.70 feet, marked Lot 10 S31 BT.

Set steel fence post approx. 0.5 ft. East

North/South bearing fence line falls approx. 3 ft. East

I hereby certify that the corner was monumented
December 3, 2025

Witness: Kyle Tucker

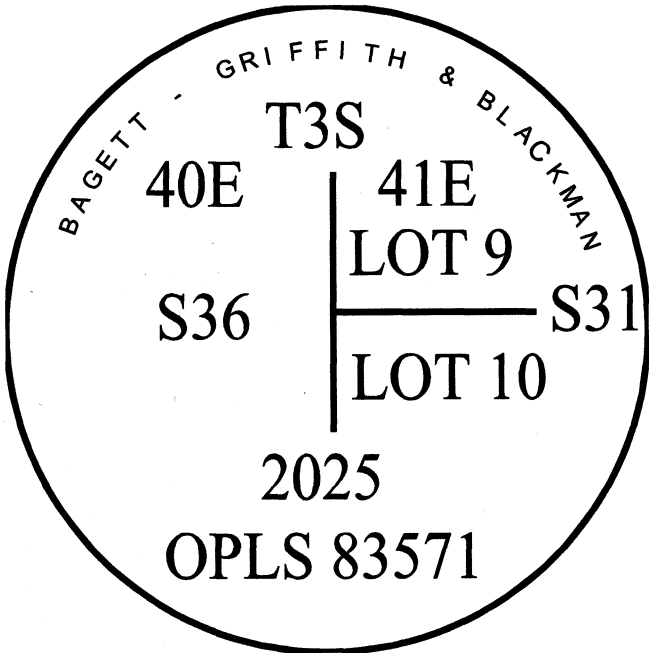

REGISTERED
PROFESSIONAL
LAND SURVEYOR



OREGON
June 2, 2010
JEFFREY S. HSU
83571

Renewal Date: June 30, 2027

UNION COUNTY
SURVEYOR

Date Received 12/19/25

Date Filed 12/19/25

Filed By 

File Number 064-2025R

I use a tape and compass in the establishment of the new bearing tree. Bearings are measured from the center of the aluminum cap to a brass washer marked "OPLS 83571" tacked to the BT blaze. Declination used was 14° East. Distances are measured from the center of the aluminum cap to a 60D spike in the center right base of the tree or the center of the aluminum cap.

Y-01