

CERTIFIED RECORD OF LAND CORNER MONUMENTATION

HISTORY OF ORIGINAL CORNER ESTABLISHMENT:

Corner originally established by James W. Kimbrell in Old Book Survey Page 7, dated April 8, 1887. Survey Notes state:

Set Stone 6x10x22" for 1/8 corner.

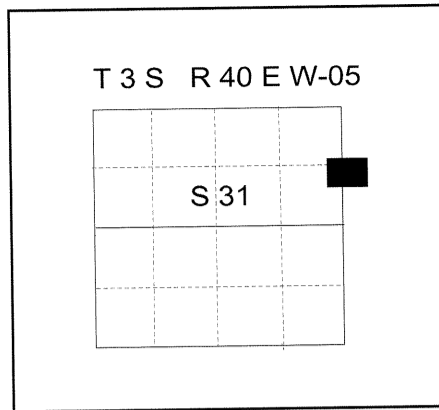

DESCRIPTION OF CORNER EVIDENCE FOUND:

No evidence of Kimbrell stone could be found. A prominent fence corner is harmonious with the bearing and distance as per Kimbrell Survey to the SE corner of Section 31. Fencelines run West and South.

SEE SURVEY NUMBER 003-2015

DESCRIPTION OF MONUMENT AND ACCESSORIES I ESTABLISHED

TO PERPETUATE THE ORIGINAL LOCATION OF THIS CORNER:

At fence corner position, I set a 5/8" x 30" iron pin, 26" in the ground, with a 2 1/2" aluminum cap, marked as shown below, from which:

A 5/8" x 30" iron pin bears North 89°40' West, a distance of 20.00 feet, with 1 1/2" aluminum cap marked BGB SURVEY MARKER W RP.

A 5/8" x 30" iron pin bears South 1°00" West, a distance of 20.10 feet, with 1 1/2" aluminum cap marked BGB SURVEY MARKER S RP.

Set a steel fencepost approximately 0.5 feet North of corner monument.
I hereby certify that the corner was monumented on January 26, 2015

REGISTERED
PROFESSIONAL
LAND SURVEYOR

OREGON
June 2, 2010
JEFFREY S. HSU
83571

Renewal Date: June 30, 2015

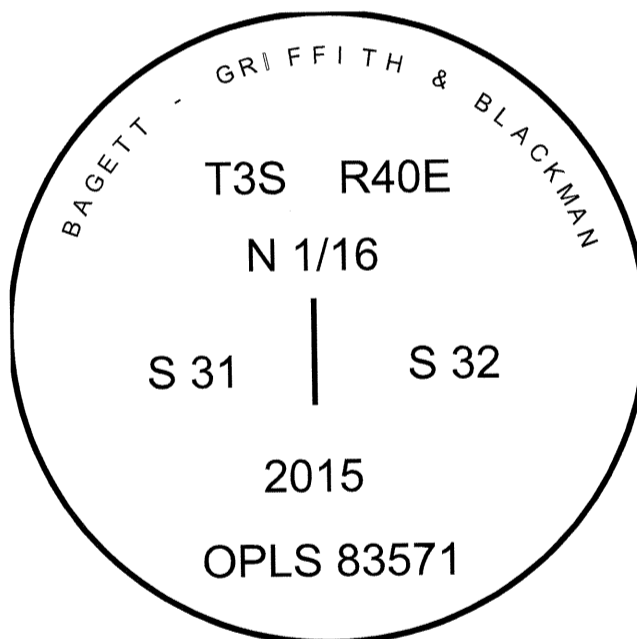

UNION COUNTY
SURVEYOR

Date Received 1/29/15

Date Filed 1/29/15

Filed By [Signature]

File Number 005-2015R

I used a Leica GS-15 RTK GPS in the establishment of the accessories. Bearings and distances are to the center of the aluminum caps. Basis of bearings is as per Survey Number 003-2015.