

GOVERNMENT CORNER RESTORATION FORM

TOWNSHIP 35, RANGE 40 E, SECTION(S) 22, 23, 26, 27

COUNTY UNION STATE OREGON DATE 3-27-84

CORNER DESIGNATION

SECTION CORNER

522	523
527	526

REFERENCES TO PRIOR RECORDS SURVEY No. 46-79,
SURVEY OF VISTA ACRES

MONUMENT(S) FOUND: (CONDITION AND SOURCE)

1 1/4" IRON PIPE WITH BRASS CAP MARKED AS
SHOWN, BURIED 1 FT. BELOW SURFACE IN OLD
ROAD BED, IN LINE WITH OLD ROCK FENCE RUNNING
SOUTHERLY FROM SOUTH SIDE OF ROAD.

THIS MONUMENT WAS SET BY BAGETT, GRIFFITH & ASSOCIATES
UNDER STAMP OF GREGORY T. BLACKMAN, IN JUNE,
1979, DURING SURVEY FOR DARRELL E. VALADE,
FILED BY SURVEY No. 46-79. CORNER WAS SET BY
TESTIMONY OF WENDELL GEKELER AND FRANK BROTHERS.

ACCESSORIES FOUND: (CONDITION AND SOURCE)

NONE (NONE OF RECORD)

CORNER NUMBER

R-17

UNION COUNTY SURVEYOR

Date Received 4-24-84

Date Filed 4-26-84

By G. LANGLITZ DEPUTY

File No. 852-84 R

REFER TO SURVEY NO. 15-84

CONDITION REPORT ONLY

NOT FOUND

RENEWED

SURVEYED IN

THIS SPACE RESERVED FOR
USE OF COUNTY SURVEYOR

MONUMENT DETAIL

735	R40E
522	523
527	526
1979	
PLS 991	

RENEWAL

MONUMENT SET (PROCEDURE AND DESCRIPTION)

MONUMENT DETAIL

NONE

NEW ACCESSORIES

NONE

SKETCH OF MONUMENT, ACCESSORIES AND GENERAL AREA
(IF NEEDED FOR CLARIFICATION)

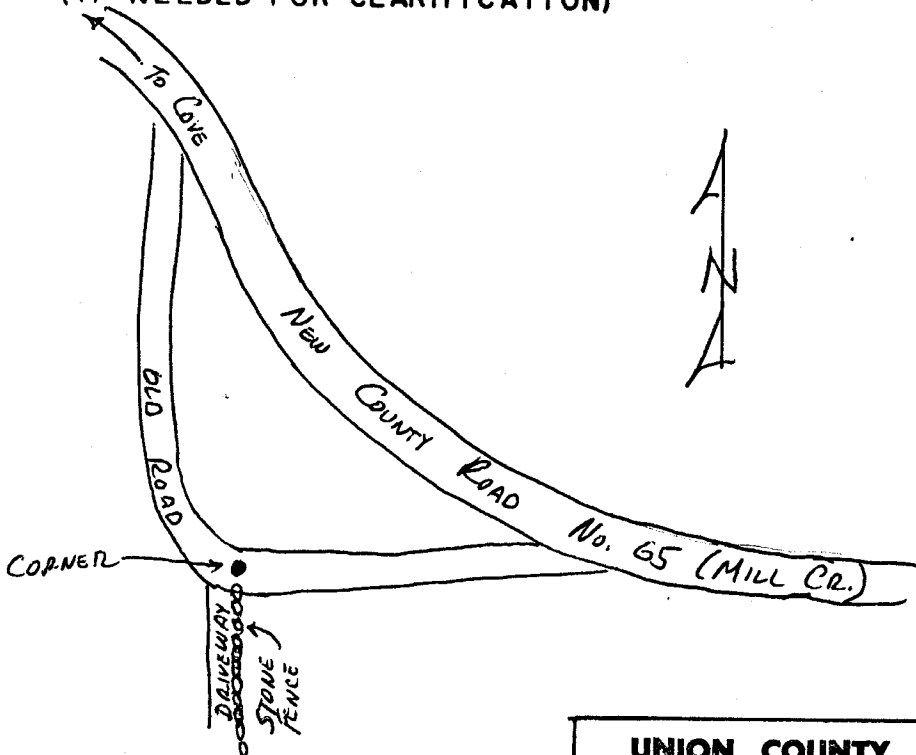

LOCATION & COMMENTS

COMPASS DECLIN. _____
FIRM/AGENCY _____
PARTY CHIEF _____
WITNESSES _____

**UNION COUNTY
SURVEYOR**

Date Received 4-24-84

Date Filed _____

By _____

File No. 852-84 R

SURVEYOR'S SEAL

**REGISTERED
PROFESSIONAL
LAND SURVEYOR**

Victor M. McLind

**OREGON
JULY 17, 1970
VICTOR M. McLIND
934**

HORIZONTAL CONTROL DATA

UNION COUNTY, OREGON
OREGON STATE PLANE, NORTH ZONE (3601)

STA. NAME: 9335

CORNER COMMON TO: 22,23,26 & 27 GEODETIC COOR: NAD 83(91)

TWP.3 S. RGE.40 E. LAT: 45°16'56.14974" N

DATE SET: OCT. 1993 LONG: 117°47'16.37188" W

SURVEYOR: WALTER L. CASWELL SP. COOR: NAD 83(91)

PLS 737

N: 600716.970 INT.FT.

FIRM: EAGLE GPS SURVEY CORP
13545 NW SCIENCE PARK DR
PORTLAND, OR. 97229
(503) 643-1073

E: 8900024.509 INT.FT.

THETA: 1°55'24.228"

TYPE: GPS

SCALE FACTOR: 0.999896541

ORDER: SECOND CLASS: 1

ELEV: 3221.31 US.FT.

ELEV. DATUM: NGVD 29

DIRECTIONS "TO REACH": FROM HIGHWAY 237 AND MILL CREEK LANE IN COVE, GO SOUTHEAST FOR 1.6 MILES, TO THE LOOP (GRAVEL) TO THE RIGHT. TAKE THE LOOP AND GO TO THE POINT WHERE THE ROAD ROUNDS ITS FINAL CORNER AND IS HEADING STRAIGHT BACK ONTO MILL CREEK LANE. SLIGHTLY PAST THIS TURN A LONGER DRIVEWAY TAKES OFF TO THE RIGHT. THERE IS A MAILBOX ON THE EAST SIDE OF THE ENTRANCE TO THIS DRIVEWAY. THE CORNER IS 5/8" IRON ROD WITH A 2 1/2" ALUMINUM CAP IN LINE WITH A ROCK FENCE AND IN THE MIDDLE OF THE ROAD.



EXPIRES 12/31/95

1 METER = 3.280833333333... U.S. FEET = 39.37 INCHES
1 METER = 3.280839895 INT'L FEET OR 1 INCH = 2.54 CM.
TO CALCULATE ELEVATION FACTOR (IN THE NORTH AMERICAN CONTINENT)
DIVIDE 20,906,000 BY (20,906,000 + ELLIPSOID ELEV. IN FEET)
SHEET 33 OF 37