

CERTIFIED RECORD OF LAND CORNER MONUMENTATION

P-13

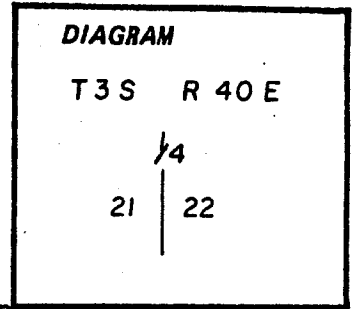

History of original corner establishment: Corner was originally set by David Thompson under GLO contract 103 in November of 1863; GLO Notes state; Set post for 1/4 section corner in mound of earth with charred stake, pits trench as per instructions; This line was retraced June 13th 1892 by J L. Curtis, Union County Surveyor, see page 290 of OLD book of surveys; Curtis states " Intersected the 1/4 corner between section 21 & 22." He does not indicate that he set a new corner. There is further evidence that Curtis broke section 22, (see page 363 of Old book of surveys) setting the center of section and the stone at the East 1/4 corner of section 22. Although there is no record of Curtis's survey except for Howland stating "From said corner I ran back 2657 feet to East 1/4 corner sect. 22, found stone set by Curtis". It is my professional opinion that Curtis broke section 22 resetting the East and West 1/4 section corners and placing the center of section, all stones, and did not record the survey. This survey occurred between June 13th 1892 and March 9th 1915, thus the reason for the stone at the West 1/4 corner of section 22.

Description of corner evidence found:

Found a well marked basalt stone, 30"x 13 "x 9" standing in place marked 1/4 on the East and West side. A small cross marked the top.

Description of monument and accessories I established to perpetuate the

original location of this corner: At the stone location I placed a galvanized pipe 1"x36" with a 2 1/2" brass cap marked as shown, 18" in the ground and raised a mound of stone. I buried the stone alongside and to the west of the pipe. A rock Jack stands East 1 foot. No other bearing objects were practical.

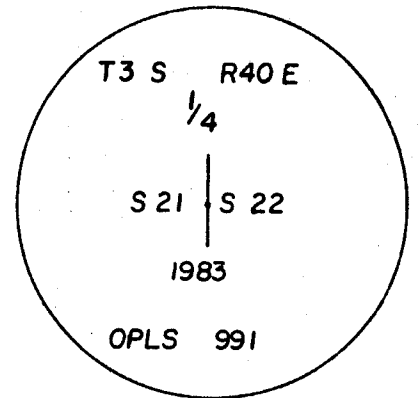

Corner set February 22, 1983
Witness present : Rick Robinson

REGISTERED
PROFESSIONAL
LAND SURVEYOR

Gregory T. Blackman

OREGON
JULY 13, 1973
GREGORY T. BLACKMAN
991

Office of SURVEYOR County of UNION
State of OREGON I hereby certify that the within instrument was filed in this office
for record on the 2 day of MARCH 1983
Howard L. Perry by Gary J. Knight
(COUNTY OFFICIAL) (DEPUTY)

**UNION COUNTY
SURVEYOR**

Date Received _____

Date Filed _____

By _____

File No. 462-84R

HORIZONTAL CONTROL DATA

**UNION COUNTY, OREGON
OREGON STATE PLANE, NORTH ZONE (3601)**

STA. NAME: 9212

QUARTER SECTION: E 1/4 COR

GEODETIC COOR: NAD 83(91)

SEC. 21 TWP 3 S RGE 40 E

LAT: 45 17'22.14965" N

DATE SURVEYED: MAY, 19, 1992

LONG: 117 48'30.29789" W

SURVEYOR: WALTER L. CASWELL
PLS 737

SP. COOR: NAD 83(91)

FIRM: EAGLE GPS SURVEY CORP
13545 NW SCIENCE PARK DR
PORTLAND, OR. 97229
(503) 643-1073

N: 603171.899 Int.Ft.

E: 8894654.377 Int.Ft.

THETA: 1 54'31.801"

TYPE: GPS

SCALE FACTOR: 0.999896798

ORDER: SECOND CLASS: 1

ELEV: 3105.50 US.Ft.

ELEV. DATUM: NGVD 29

DIRECTIONS "TO REACH"

From the Post Office on Main Street (Highway 237), travel East 0.10 miles, then take an easy right onto French Street. After travelling 0.10 miles on French Street the road makes about a 90 degree turn to the left and becomes Hill Street. Follow Hill Street about 0.20 miles and the road makes about a 90 degree turn to the right and becomes Mill Creek Road. Follow Mill Creek Road 0.20 miles (you will take one more sharp turn to your left) and you will discover a gravel road taking off to the right. There is a small sign which says "Cove Cemetery" pointing up the road. Take this road for .30 miles and you will cross a small stream and finally come to the entrance to the Cove Cemetery. Do Not go through the entrance. Instead take the road which goes around the entrance to the right and comes almost immediately to a fence. Stopping at the fence you will notice an intersection of two fences just off to your right. On the West side of the fence intersection you will find the corner.

CERTIFIED RECORD OF LAND CORNER MONUMENTATION

HISTORY OF ORIGINAL CORNER ESTABLISHMENT:

Corner originally established by David P. Thompson under GLO contract Number 103, dated September 3rd, 1863. Surveyor General record states: "Set post for 1/4 Sec corner in mound of earth with charred stake, pits trench as per instructions"

Retraced by J.L. Curtis, Union County Surveyor June 13, 1892, as recorded in page 290 of Old Book of Surveys. Curtis states "intersected the 1/4 corner between Section 21 and 22" and does not indicate setting monument.

In Union County Monumentation record 462-84R, Gregory T. Blackman describes finding a basalt stone, 30"x13"x9", marked 1/4 on East and West side with a small cross on top. Replaced with a galvanized pipe 1"x36" with a 2 1/2" Brass cap, 18" in the ground.

Galvanized pipe corner utilized by Minor Partition 1999-11, Minor Partition 2001-02, Minor Partition 20070025T and Rose Ridge Subdivision.

DESCRIPTION OF CORNER EVIDENCE FOUND:

Brass cap on iron pipe found lying on ground. Concrete base supporting a railroad iron fence corner occupies corner position. Used record position of 5/8" iron pins set by Minor Partition 2001-02, Minor Partition 20070025T and Rose Ridge Subdivision to determine corner position. From true corner position:

A 5/8" iron pin bears South 0°26'45" East, a distance of 60.00 feet, with yellow plastic cap marked BGB SURVEY MARKER, set by Minor Partition 2001-02.

A 5/8" iron pin bears South 53°00'41" West, 99.58 feet, with yellow plastic cap marked BGB SURVEY MARKER, set by Minor Partition 20070025T.

A 5/8" iron pin bears North 0°10'48" East, a distance of 165.00 feet, with yellow plastic cap marked BGB SURVEY MAKER, set by Rose Ridge Subdivision.

DESCRIPTION OF MONUMENT AND ACCESSORIES I ESTABLISHED TO PERPETUATE THE ORIGINAL LOCATION OF THIS CORNER:

At a record bearing and distance from 5/8" iron pins, I set a 3" brass plaque, cemented in concrete, marked as shown, from which:

NEW BEARING OBJECT:

A 5/8"x30" iron pin with 1 1/2" aluminum cap bears North 27°06'31" East, a distance of 15.14 feet, marked UNION COUNTY SURVEYOR NE RP

I hereby certify that the corner was monumented on July 31, 2009.
Witness: Jeff Hsu

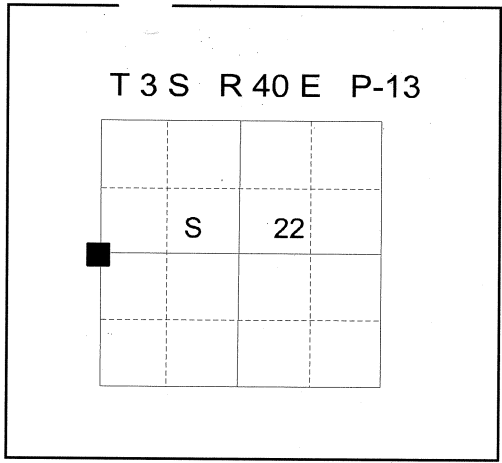

REGISTERED
PROFESSIONAL
LAND SURVEYOR

Rick G. Robinson
OREGON
July 17, 1986
RICK G. ROBINSON
2219

Renewal Date: December 31, 2010

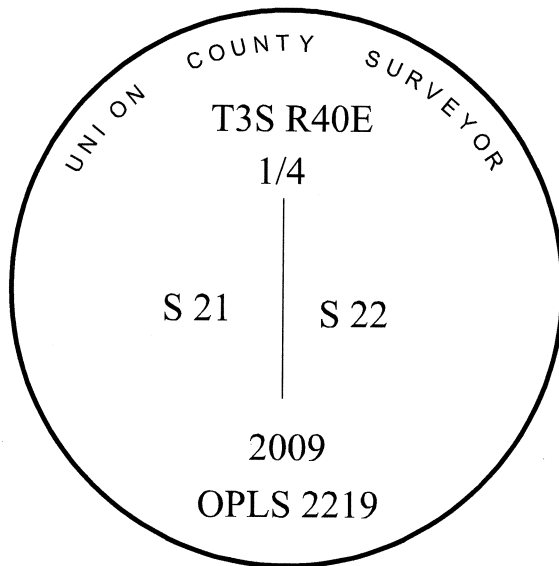

UNION COUNTY SURVEYOR

Date Received 10/27/09

Date Filed 10/27/09

Filed By J. T. B. [Signature]

File Number 036-2009R

I used a Leica 1200 GPS to measure to the bearing objects. Basis of bearings is as per plat of Rose Ridge Subdivision. The distances to the accessories are to the center of the caps.

HORIZONTAL CONTROL DATA

UNION COUNTY, OREGON

OREGON STATE PLANE, NORTH ZONE (3601)

STA NAME: 200926

QUARTER CORNER COMMON TO SECTIONS 21 AND 22

TWP. 3 S RGE. 40 E.

GEODETIC COORD: NAD 83(91)

DATE TIED: July 31, 2009

LAT: 45 ° 17 ' 22.15162 " N

SURVEYOR: RICK ROBINSON
OPLS 2219

LONG: 117 ° 48 ' 30.29934 " W

FIRM: BAGETT, GRIFFITH, & BLACKMAN
2006 ADAMS AVENUE
LAGRANDE, OR 97850
(541) 963-6092

SP. COOR: NAD 83(91)

N: 603172.095 INT FT.

E: 8894654.267 INT FT.

TYPE: GPS

THETA: 1 ° 54' 31.8 "

ORDER: SECOND CLASS: 1

SCALE FACTOR: 0.9998967977

ELEV: 3103.9148 US FT:

ELEV: DATUM: NGVD 29

COMMENTS:

Corner is a 3" brass cap monument set in concrete fence corner base. Cap is marked as shown.

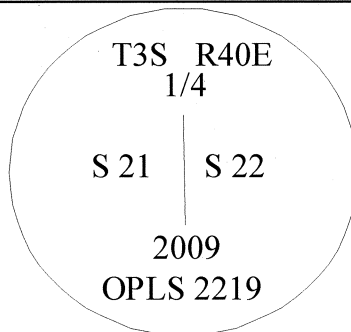

Renewal Date: December 31, 2010

1 METER = 3.2808333333... US FEET = 39.37 INCHES

1 METER = 3.280839895 INT'L FEET OR 1 INCH = 2.54 CM

TO CALCULATE ELEVATION FACTOR (IN THE NORTH AMERICAN CONTINENT)

DIVIDE 20,906,000 BY (20,906,000 + ELLIPSOID ELEV. IN FEET)