

**UNION COUNTY SURVEYOR**

**CERTIFIED RECORD OF LAND CORNER MONUMENTATION**

**HISTORY OF ORIGINAL CORNER ESTABLISHMENT:**

Corner originally established by David P. Thompson, contract No. 103, dated September 3, 1863. Surveyor General record states:

Set post for 1/4 Sec corner in mound of earth + stone with charred stakes, pits, trenches, as per instructions.

Survey No. 014-1997 establishes a proportionate position

T 3 S R 40 E N-19

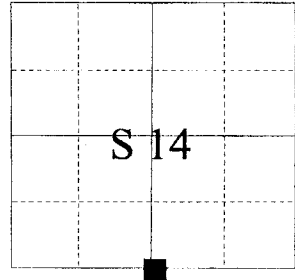

No record of subsequent monumentation found in Union County survey records.

**DESCRIPTION OF CORNER EVIDENCE FOUND:**

NONE

See Survey No. 010-2001

**DESCRIPTION OF MONUMENT AND ACCESSORIES I ESTABLISHED TO PERPETUATE THE ORIGINAL LOCATION OF THIS CORNER:**

At position established by Survey Nos. 010-2001 & 014-1997, I set a 2 1/2" x 30" aluminum monument, marked as shown below, 24" in the ground from which:

A 5/8" x 30" iron pin with plastic cap bears N88°E, a distance of 12.72 feet, marked BGB SURVEY MARKER

A 5/8" x 30" iron pin with 1 1/2" aluminum cap near a North & East fence corner bears S18°W, a distance of 7.16 feet, marked UNION COUNTY SURVEYOR SW RP.

A 5/8" x 30" iron pin with plastic cap bears S87°W, a distance of 19.87 feet, marked BGB SURVEY MARKER

A 5/8" x 30" iron pin with 1 1/2" aluminum cap bears N22°W, a distance of 8.85 feet, marked UNION COUNTY SURVEYOR NW RP.

I hereby certify that the corner was monumented on March 5, 2001. Witness: Norbert Volny and Gregory T. Blackman, Jr.

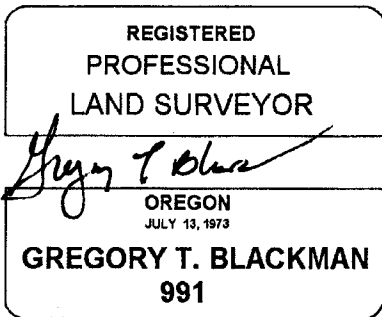

Renewal Date: Dec. 31, 2001

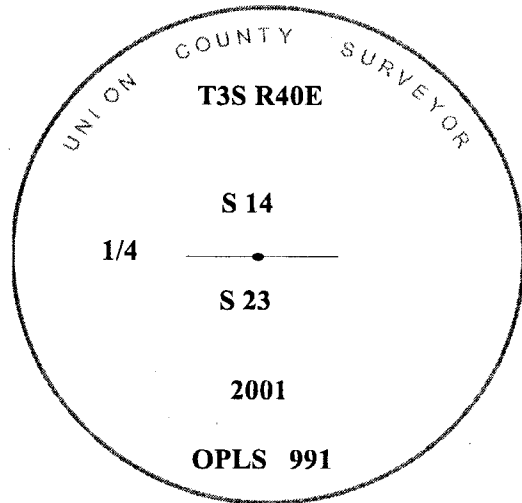

UNION COUNTY SURVEYOR
Date Received 3/27/01
Date Filed 3/31/01
Filed By R. ROBINSON, DEPUTY
File Number 021-2001R

I used a Leica 530 GPS unit in the establishment of the new accessories. The Basis of Bearings is the same as that shown on Survey No. 010-2001. The distances are to the center of a 5/8"x30" iron pin with cap as noted.

# HORIZONTAL CONTROL DATA

## UNION COUNTY, OREGON

### OREGON STATE PLANE, NORTH ZONE (3601)

STA NAME: 200133

QUARTER COMMON TO: 14 & 23

TWP. 3 S. RGE. 40 E.

GEODETIC COORD: NAD 83(91)

DATE TIED: 12 MARCH 2001

LAT: 45 ° 17 ' 48.87666 " N

SURVEYOR: GREGORY T. BLACKMAN  
OPLS 991

LONG: 117 ° 46 ' 39.37515 " W

FIRM: BAGETT, GRIFFITH, & BLACKMAN  
2006 ADAMS AVENUE  
LAGRANDE, OR 97850  
(541) 963-6092

SP. COOR: NAD 83(91)

N: 606142.753 INT FT.

E: 8902488.212 INT FT.

TYPE: GPS

THETA: 1 ° 55 ' 50.4661004 "

ORDER: SECOND CLASS: 1

SCALE FACTOR: 0.9998970785

ELEV: 3478.41 US FT.

ELEV: DATUM: NGVD 29

COMMENTS:

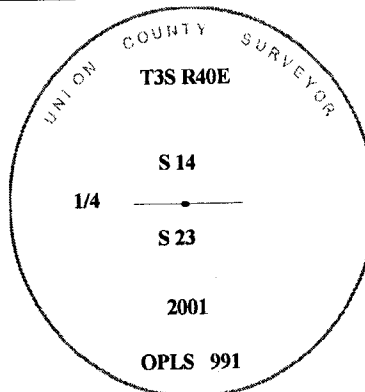

Renewal Date: Dec. 31, 2001

1 METER = 3.2808333333... US FEET = 39.37 INCHES

1 METER = 3.280839895 INT'L FEET OR 1 INCH = 2.54 CM

TO CALCULATE ELEVATION FACTOR ( IN THE NORTH AMERICAN CONTINENT)

DIVIDE 20,906,000 BY (20,906,000 + ELLIPSOID ELEV. IN FEET)