

**UNION COUNTY SURVEYOR**

**CERTIFIED RECORD OF LAND CORNER MONUMENTATION**

**HISTORY OF ORIGINAL CORNER ESTABLISHMENT:**

Corner originally established by David P. Thompson, contract No. 103, dated September 3, 1863. Surveyor General record states:

Set post for 1/4 Sec corner from which;  
a Willow 6 in diam bears S35°W 136 lks dist  
a Alder 5" " " N86°E 378 " "

Survey 051-1993 establishes proportionate position

T 3 S R 40 E N-11

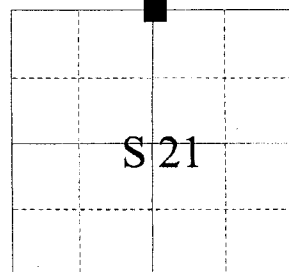

No record of subsequent monumentation found in Union County survey records.

**DESCRIPTION OF CORNER EVIDENCE FOUND:**

NONE

See Survey No. 010-2001

**DESCRIPTION OF MONUMENT AND ACCESSORIES I ESTABLISHED TO PERPETUATE THE ORIGINAL LOCATION OF THIS CORNER:**

At position established by Survey No. 010-2001 and Survey No. 051-1993, I set a 2 1/2" x 30" aluminum monument in a mound of stone 1 ft. base to top of cap, marked as shown below, 24" in the ground from which:

A 5/8" x 30" iron pin with 1 1/2" aluminum cap in a North-South fenceline bears N56°E, a distance of 16.50 feet, marked UNION COUNTY SURVEYOR NE RP.

A 5/8" x 30" iron pin with 1 1/2" aluminum cap in a North-South fenceline bears S37°E, a distance of 24.71 feet, marked UNION COUNTY SURVEYOR SE RP.

A 5/8" x 30" iron pin with 1 1/2" aluminum cap bears S49°W, a distance of 6.35 feet, marked UNION COUNTY SURVEYOR SW RP.

A 60d spike 3 ft. above ground in Power Pole #046214900, bears N42°W, a distance of 65.69 feet.

I hereby certify that the corner was monumented on March 6, 2001. Witness: Norbert Volny and Gregory T. Blackman, Jr.

REGISTERED  
PROFESSIONAL  
LAND SURVEYOR

OREGON  
JULY 13, 1973  
GREGORY T. BLACKMAN  
991

Renewal Date: Dec. 31, 2001

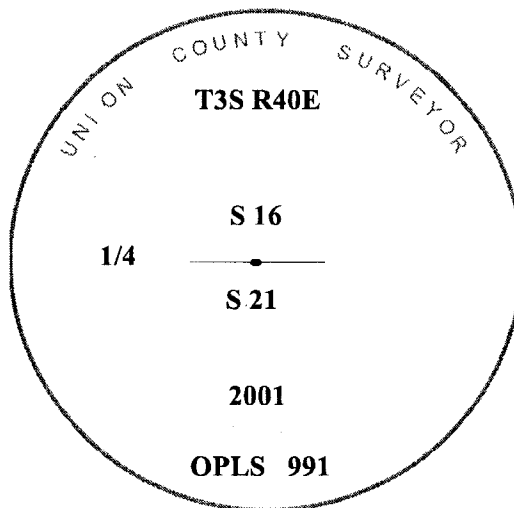

**UNION COUNTY SURVEYOR**

Date Received 3/27/01

Date Filed 3/31/01

Filed By R. ROBINSON, DEPUTY

File Number 018-2001R

I used a Leica 530 GPS unit in the establishment of the new accessories. The Basis of Bearings is the same as that shown on Survey No. 010-2001. The distances are to the center of a 5/8"x30" iron pin with 1 1/2" aluminum cap or as noted.

**HORIZONTAL CONTROL DATA  
UNION COUNTY, OREGON  
OREGON STATE PLANE, NORTH ZONE (3601)**

STA NAME: 200127

QUARTER COMMON TO: 16 & 21

TWP. 3 S. RGE. 40 E.

GEODETIC COORD: NAD 83(91)

DATE TIED: 12 MARCH 2001

LAT: 45 ° 17 ' 48.27557 " N

SURVEYOR: GREGORY T. BLACKMAN  
OPLS 991

LONG: 117 ° 49 ' 7.44547 " W

FIRM: BAGETT, GRIFFITH, & BLACKMAN  
2006 ADAMS AVENUE  
LAGRANDE, OR 97850  
(541) 963-6092

SP. COOR: NAD 83(91)

N: 605728.037 INT FT.

E: 8891912.501 INT FT.

TYPE: GPS

THETA: 1 ° 54 ' 5.45670142 "

ORDER: SECOND CLASS: 1

SCALE FACTOR: 0.999897072

ELEV: 2841.71 US FT.

ELEV: DATUM: NGVD 29

COMMENTS:

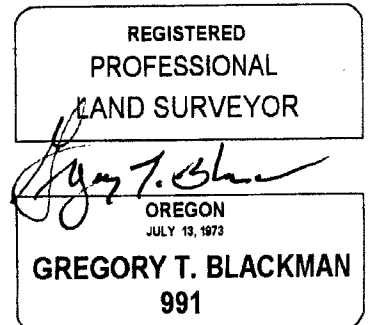
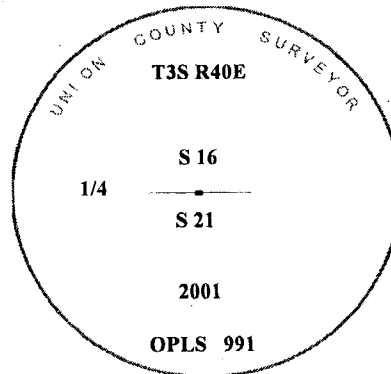

Renewal Date: Dec. 31, 2001

1 METER = 3.2808333333... US FEET = 39.37 INCHES

1 METER = 3.280839895 INT'L FEET OR 1 INCH = 2.54 CM

TO CALCULATE ELEVATION FACTOR ( IN THE NORTH AMERICAN CONTINENT)

DIVIDE 20,906,000 BY (20,906,000 + ELLIPSOID ELEV. IN FEET)