

CERTIFIED RECORD OF LAND CORNER MONUMENTATION

HISTORY OF ORIGINAL CORNER ESTABLISHMENT:

Corner originally established by David Thompson under GLO contract Number 103, dated September 3, 1863. Surveyor General record states:

Set post for 1/4 sec cor in mound of earth, with charred stake, pits, trench as per instructions

No record of subsequent monumentation found in Union County survey records

DESCRIPTION OF CORNER EVIDENCE FOUND:

Found no evidence of the original post or mound of earth as called for in the original notes. The proportionate position for this corner has been used on survey numbers 5-80, 21-83, 10-84, 31-84, 28-90, 035-1992, 025-1993, 051-1993, 029-1994, 004-1995, 026-1995, 044-1995, 050-1995, 008-1996, 018-1996, 048-1996, along with several partition plats and subdivision plats.

See Union County Survey Number 021-1999.

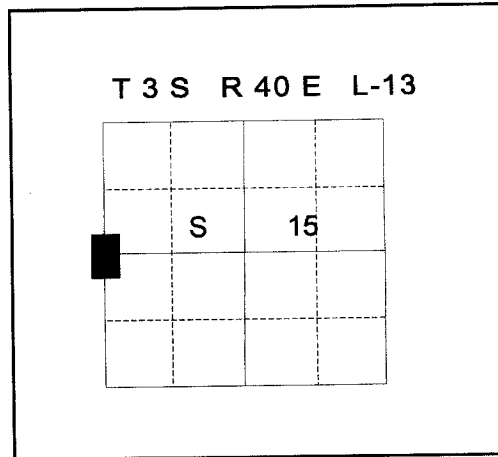

DESCRIPTION OF MONUMENT AND ACCESSORIES I ESTABLISHED TO PERPETUATE THE ORIGINAL LOCATION OF THIS CORNER:

At the proportionate position, I set a 2 1/2"x30" aluminum pipe with aluminum cap marked as shown, 29 inches in the ground, from which;

NEW BEARING OBJECTS:

A 5/8"x30" iron pin with plastic cap marked "BGB SURVEY MARKER" bears North 80°05'00" East, a distance of 30.43 feet, pin is set in an East-West fence.

A 5/8"x30" iron pin with aluminum cap marked "UNION COUNTY SURVEYOR SE RP" bears South 32°48'51" East, a distance of 8.94 feet.

A 5/8"x30" iron pin with aluminum cap marked "UNION COUNTY SURVEYOR SW RP" bears South 39°36'47" West, a distance of 9.87 feet, pin is set on the East side of the East curb of Oregon State Highway number 237.

A 5/8"x30" iron pin with aluminum cap marked "UNION COUNTY SURVEYOR NW RP" bears North 42°25'34" West, a distance of 8.69 feet, pin is set on the East side of the East curb of Oregon State Highway number 237.

I hereby certify that the corner was monumented on May 14, 1999.
Witness: Norbert Volny

REGISTERED
PROFESSIONAL
LAND SURVEYOR

OREGON
July 17, 1986
RICK G. ROBINSON
2219

Renewal Date December 31, 2000

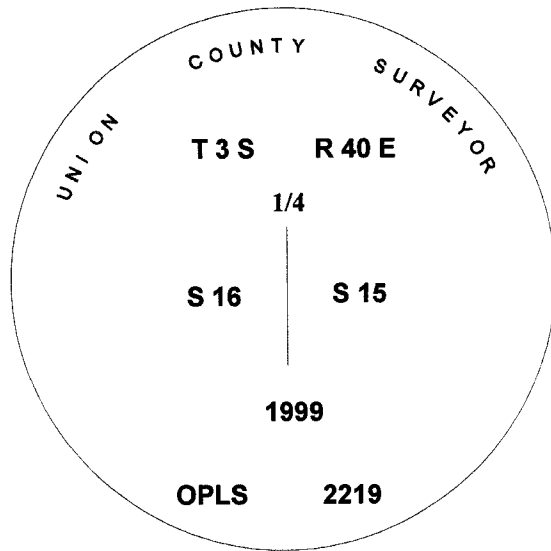

UNION COUNTY SURVEYOR

Date Received 5/18/99

Date Filed 7/17/99

Filed By [Signature]

File Number 014-1999R

I used a total station instrument in the establishment of the new accessories. I used the same basis of bearing as Union County Survey Number 021-1999. The distances are to the center of the cap of the bearing object.

HORIZONTAL CONTROL DATA

UNION COUNTY, OREGON

OREGON STATE PLANE, NORTH ZONE (3601)

STA NAME: 200111

QUARTER COMMON TO: 15 & 16

TWP. 3 S. RGE. 40 E.

GEODETIC COORD: NAD 83(91)

DATE TIED: 14 MARCH 2001

LAT: 45 ° 18 ' 14.48906 " N

SURVEYOR: GREGORY T. BLACKMAN
OPLS 991

LONG: 117 ° 48 ' 30.38711 " W

FIRM: BAGETT, GRIFFITH, & BLACKMAN
2006 ADAMS AVENUE
LAGRANDE, OR 97850
(541) 963-6092

SP. COOR: NAD 83(91)

N: 608469.377 INT FT.

E: 8894471.444 INT FT.

TYPE: GPS

THETA: 1 ° 54 ' 31.7379692 "

ORDER: SECOND CLASS: 1

SCALE FACTOR: 0.9998973633

ELEV: 2908.17 US FT.

ELEV: DATUM: NGVD 29

COMMENTS:

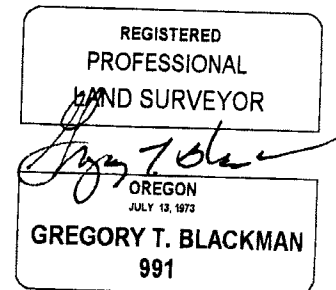
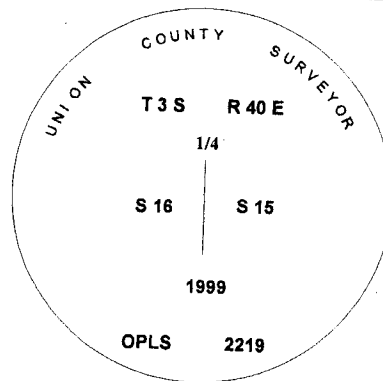

Renewal Date: Dec. 31, 2001

1 METER = 3.280833333... US FEET = 39.37 INCHES

1 METER = 3.280839895 INT'L FEET OR 1 INCH = 2.54 CM

TO CALCULATE ELEVATION FACTOR (IN THE NORTH AMERICAN CONTINENT)

DIVIDE 20,906,000 BY (20,906,000 + ELLIPSOID ELEV. IN FEET)