

**UNION COUNTY SURVEYOR**

**CERTIFIED RECORD OF LAND CORNER MONUMENTATION**

**HISTORY OF ORIGINAL CORNER ESTABLISHMENT:**

Corner originally established by David P. Thompson, contract No. 103, dated September 3, 1863. Surveyor General record states:

Set post for 1/4 Sec corner in mound of earth with charred stakes, pits, trenches, as per instructions.

Survey No. 40-79 establishes a proportionate position  
Survey No. 49-81 calls the same proportionate position

T 3 S R 40 E J-19

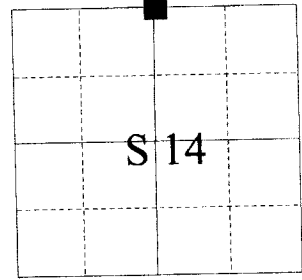

No record of subsequent monumentation found in Union County survey records.

**DESCRIPTION OF CORNER EVIDENCE FOUND:**

NONE

See Survey No. 010-2001

**DESCRIPTION OF MONUMENT AND ACCESSORIES I ESTABLISHED TO PERPETUATE THE ORIGINAL LOCATION OF THIS CORNER:**

At position established by Survey Nos. 010-2001, 40-79, and 49-81, I set a 2 1/2" x 30" copper clad monument, marked as shown below, 36" in the ground from which:

A 5/8" x 30" iron pin with 1 1/2" aluminum cap in a East-West fenceline bears N40°E, a distance of 26.01 feet, marked UNION COUNTY SURVEYOR NE RP.

A 5/8" x 30" iron pin with 1 1/2" aluminum cap in a East-West fenceline bears S39°E, a distance of 22.04 feet, marked UNION COUNTY SURVEYOR SE RP.

A 5/8" x 30" iron pin with 1 1/2" aluminum cap in a East-West fenceline bears S35°W, a distance of 22.04 feet, marked UNION COUNTY SURVEYOR SW RP.

A 5/8" x 30" iron pin with 1 1/2" aluminum cap in a East-West fenceline bears N41°W, a distance of 25.20 feet, marked UNION COUNTY SURVEYOR NW RP.

I hereby certify that the corner was monumented on March 5, 2001. Witness: Norbert Volny and Gregory T. Blackman, Jr.

REGISTERED  
PROFESSIONAL  
LAND SURVEYOR

*Gregory T. Blackman*  
OREGON  
JULY 13, 1973  
GREGORY T. BLACKMAN  
991

Renewal Date: Dec. 31, 2001

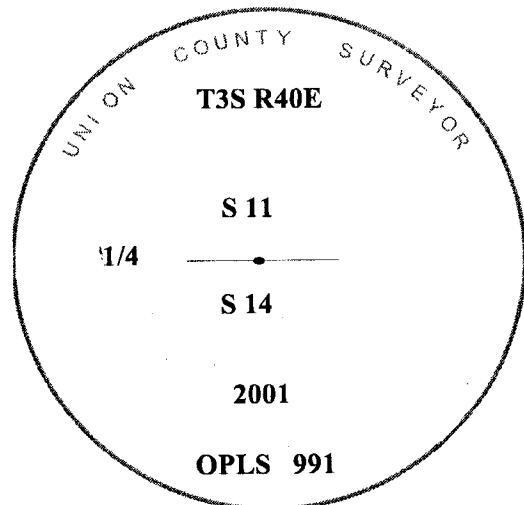

**UNION COUNTY SURVEYOR**

Date Received 3/27/01

Date Filed 3/31/01

Filed By R. ROBINSON, DEPUTY

File Number 020-2001R

I used a Leica 530 GPS unit in the establishment of the new accessories. The Basis of Bearings is the same as that shown on Survey No. 010-2001. The distances are to the center of a 5/8"x30" iron pin with 1 1/2" aluminum cap.

# HORIZONTAL CONTROL DATA

## UNION COUNTY, OREGON

### OREGON STATE PLANE, NORTH ZONE (3601)

STA NAME: 200131

QUARTER COMMON TO: 11 & 14

TWP. 3 S. RGE. 40 E.

GEODETIC COORD: NAD 83(91)

DATE TIED: 12 MARCH 2001

LAT: 45 ° 18 ' 41.30652 " N

SURVEYOR: GREGORY T. BLACKMAN  
OPLS 991

LONG: 117 ° 46 ' 39.41703 " W

FIRM: BAGETT, GRIFFITH, & BLACKMAN  
2006 ADAMS AVENUE  
LAGRANDE, OR 97850  
(541) 963-6092

SP. COOR: NAD 83(91)

N: 611449.437 INT FT.

E: 8902306.331 INT FT.

TYPE: GPS

THETA: 1 ° 55 ' 50.4363984 "

ORDER: SECOND CLASS: 1

SCALE FACTOR: 0.9998976781

ELEV: 3637.30 US FT.

ELEV: DATUM: NGVD 29

COMMENTS:

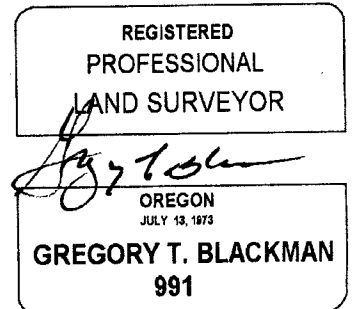
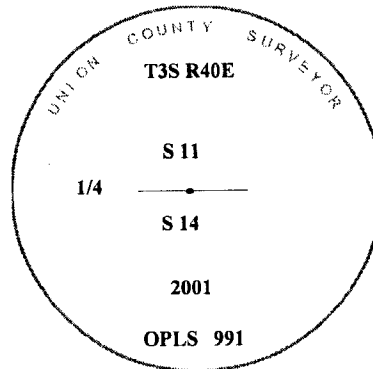

Renewal Date: Dec. 31, 2001

1 METER = 3.280833333... US FEET = 39.37 INCHES

1 METER = 3.280839895 INT'L FEET OR 1 INCH = 2.54 CM

TO CALCULATE ELEVATION FACTOR ( IN THE NORTH AMERICAN CONTINENT)

DIVIDE 20,906,000 BY (20,906,000 + ELLIPSOID ELEV. IN FEET)