

UNION COUNTY  
CERTIFIED RECORD OF LAND CORNER MONUMENTATION

History of original corner establishment:

Corner originally established by David T. Thompson under GLO contract number 103, dated September 3, 1863. Surveyor General record states:

Set post for  $\frac{1}{4}$  sec corner in a mound of stone.

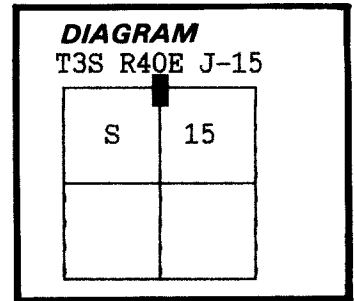

Proportionate position was originally used on Survey No. 5-80, with surveys 21-83, 10-84, 31-84, 22-88, 29-89, and 034-1991 using survey number 5-80 as a basis.

No record of subsequent monumentation found in Union County survey records.

Description of corner evidence found:

Found no evidence of the original corner monument.

Description of monument and accessories I established to perpetuate the

original location of this corner: At proportionate position, determined by survey, I set a  $2\frac{1}{2}$ " x 30" aluminum pipe with aluminum cap marked as shown, 28 inches in the ground, from which:

New Bearing Objects;

- A  $\frac{5}{8}$ "x30" iron pin with 2" aluminum cap marked NE RP bears N59°E, a distance of 18.31 feet
- A  $\frac{5}{8}$ "x30" iron pin with 2" aluminum cap marked SE RP bears S43°E, a distance of 23.95 feet
- A  $\frac{5}{8}$ "x30" iron pin with 2" aluminum cap marked SW RP bears S43°W, a distance of 25.74 feet
- A  $\frac{5}{8}$ "x30" iron pin with 2" aluminum cap marked NW RP bears N34°W, a distance of 11.55 feet

The Northwest and Northeast bearing objects are in an existing East-West fence line. The Southeast bearing object is on the North bank of Murphy Creek and the Southwest bearing object is on the South bank of Murphy Creek

Raised a small mound of stone around monument.

I hereby certify that the above corner point was perpetuated as hereon described on June 10, 1992.

Witnesses: Jeff Petersen and Pete Crabtree

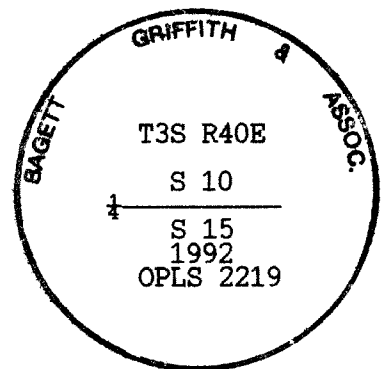

<b>UNION COUNTY SURVEYOR</b>
Date Received <u>6-11-92</u>
Date Filed <u>6/19/92</u>
By <u>[Signature]</u>
File No. <u>041-1992R</u>

I used a steel tape and magnetic compass in the establishment of new accessories. I used 20° East magnetic declination.

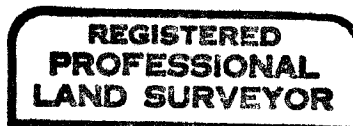

Rick G. Robinson

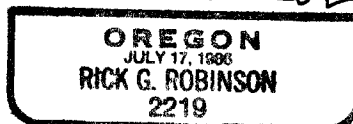

J-15

# HORIZONTAL CONTROL DATA

## UNION COUNTY, OREGON

### OREGON STATE PLANE, NORTH ZONE (3601)

STA NAME: 200130

QUARTER COMMON TO: 10 & 15

TWP. 3 S. RGE. 40 E.

GEODETIC COORD: NAD 83(91)

DATE TIED: 12 MARCH 2001

LAT: 45 ° 18 ' 40.99981 " N

SURVEYOR: GREGORY T. BLACKMAN  
OPLS 991

LONG: 117 ° 47 ' 53.43593 " W

FIRM: BAGETT, GRIFFITH, & BLACKMAN  
2006 ADAMS AVENUE  
LAGRANDE, OR 97850  
(541) 963-6092

SP. COOR: NAD 83(91)

N: 611240.867 INT FT.

E: 8897021.039 INT FT.

TYPE: GPS

THETA: 1 ° 54 ' 57.9432274 "

ORDER: SECOND CLASS: 1

SCALE FACTOR: 0.9998976744

ELEV: 3055.04 US FT.

ELEV: DATUM: NGVD 29

COMMENTS:

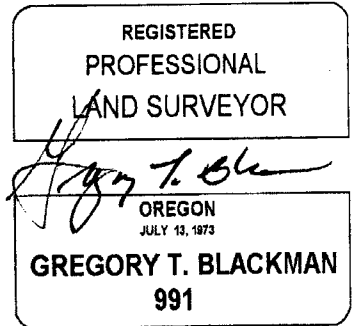
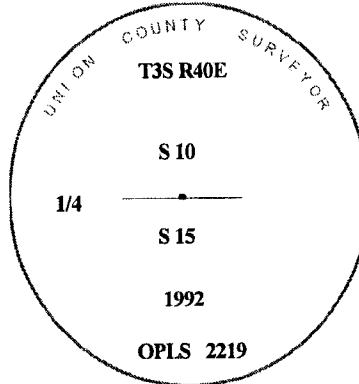

Renewal Date: Dec. 31, 2001

1 METER = 3.2808333333... US FEET = 39.37 INCHES

1 METER = 3.280839895 INT'L FEET OR 1 INCH = 2.54 CM

TO CALCULATE ELEVATION FACTOR ( IN THE NORTH AMERICAN CONTINENT)

DIVIDE 20,906,000 BY (20,906,000 + ELLIPSOID ELEV. IN FEET)