

CERTIFIED RECORD OF LAND CORNER MONUMENTATION

History of original corner establishment:

Corner not set during original GLO survey.

No other records available.

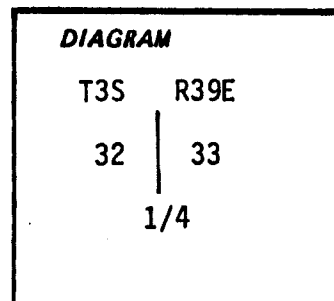

Description of corner evidence found:

No evidence found.

Refer to Union County Survey Records.

Description of monument and accessories | established to perpetuate the original location of this corner:

At the midpoint of the line between the SE and NE corners of Section 32, T3S, R39E, as depicted on a survey for the Oregon Department of Fish and Wildlife, Dated July, 1990, we set a 5/8"x30" Iron Rod, buried 3" in a gravel County Road, with plastic cap attached, marked "AP&A,

From which the following corner accessories:

A 2"x30" aluminum pipe, set 25" in the ground and 3' west of a N-S fence, with magnet-equipped aluminum cap marked:

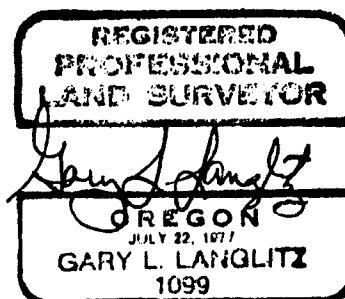
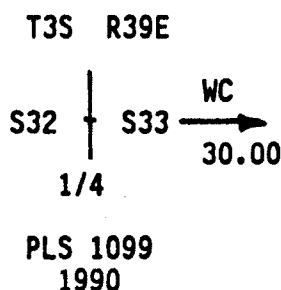

August 13, 1990

Bears S89°20'52"W 30.00 feet,

A 5/8"x30" Iron Rod (rebar) with yellow plastic cap marked "AP&A" bears N41°57'40"E 57.17 feet,

A 5/8"x30" Iron Rod (rebar) with yellow plastic cap marked "AP&A" bears S23°34'00"E 97.80 feet, and

An "+" chiseled on top of the SE corner of a concrete bridge wingwall, bears S56°31'10"W 120.93 feet.

Accessory ties were made using a Theodolite, steel tape and electronic distance meter.

June 30, 1990

Gary Langlitz, LS 1900
Jared Russell

A rectangular stamp with a double border. The top part says "UNION COUNTY SURVEYOR". Below that, it says "Date Received 8-13-90", "Date Filed 8-22-90", and "By" followed by a signature. At the bottom right, there is a handwritten "X-9" and "37-90".

CERTIFIED RECORD OF LAND CORNER MONUMENTATION

HISTORY OF ORIGINAL CORNER ESTABLISHMENT:

Corner not set during original GLO survey.

Monumentation record number 51-90R states:

Set 5/8" rebar with yellow plastic cap marked "AP&A", at corner position in gravel road.. From which:

A 5/8" x 30" rebar with yellow cap bears S23°34'00"E, a distance of 97.80 feet, marked "AP&A".

A 5/8" x 30" rebar with yellow cap bears N41°57'40"E, a distance of 57.17 feet, marked "AP&A"

"+" chiseled on top of S.E. Corner of Concrete bridge wing wall bears S56°31'10"W, a distance of 120.93 feet.

A 2" Pipe with cap bears S89°20'52"W, a distance of 30.00 feet marked as shown.

No subsequent monumentation found in Union County survey records.

DESCRIPTION OF CORNER EVIDENCE FOUND:

Found corner monument and accessories as per monumentation record number 51-90R.

See Union County Survey Number 027-1990.

DESCRIPTION OF MONUMENT AND ACCESSORIES I ESTABLISHED

TO PERPETUATE THE ORIGINAL LOCATION OF THIS CORNER: At position of found 5/8" pin, I set a 5/8"x 30" Copper Clad iron pin with 2 1/2" Brass Cap monument, marked as shown. From which:

NEW BEARING OBJECT:

A 5/8" x 30" rebar with 1 1/2" aluminum cap bears N 33°W, a distance of 28.75 feet, marked NW R.P.

I hereby certify that the corner was rehabilitated on July 14, 2010

Witness: Greg Blackman Jr. & Jeff Hsu

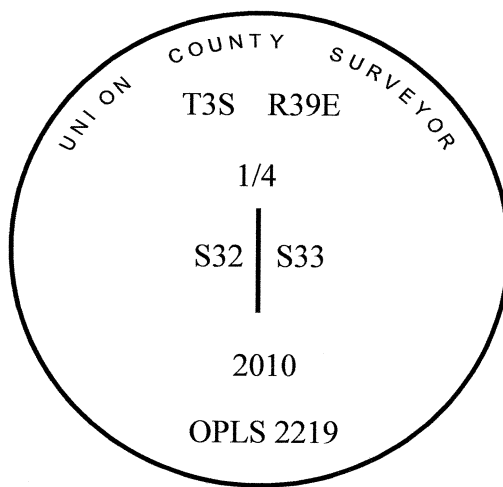
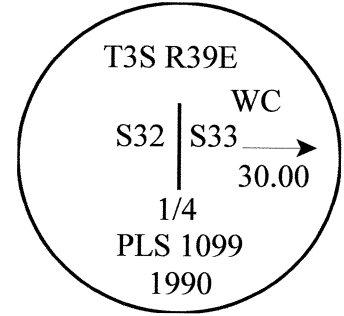
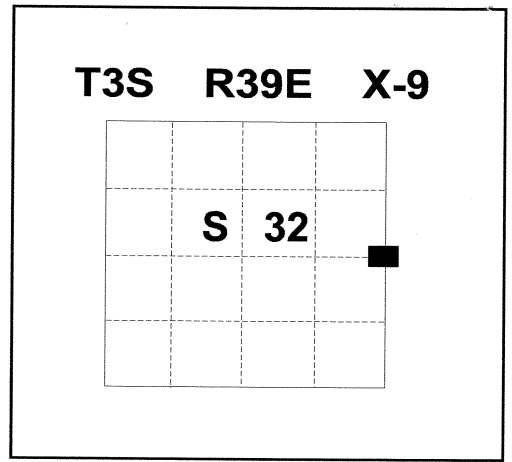

**REGISTERED
PROFESSIONAL
LAND SURVEYOR**

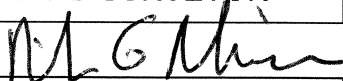

OREGON
July 17, 1986
RICK G. ROBINSON
2219

Renewal Date: December 31, 2010

**UNION COUNTY
SURVEYOR**

Date Received 7/30/2010

Date Filed 7/30/2010

Filed By Greg Bla

File Number 028-2010R

I used a compass and steel tape in the establishment of the new accessory. I used 18° East declination, distance is to center of aluminum cap. Basis of Bearing for existing accessories is that of Survey number 027-1990.

HORIZONTAL CONTROL DATA

UNION COUNTY, OREGON

OREGON STATE PLANE, NORTH ZONE (3601)

STA NAME: 201012

QUARTER CORNER COMMON TO SECTIONS 32 AND 33

TWP. 3 S. RGE. 39 E.

GEODETIC COORD: NAD 83(91)

DATE TIED: JULY 15, 2010

LAT: 45 ° 15 ' 38.39516 " N

SURVEYOR: RICK G. ROBINSON
OPLS 2219

LONG: 117 ° 57 ' 10.33242 " W

FIRM: BAGETT, GRIFFITH, & BLACKMAN
2006 ADAMS AVENUE
LAGRANDE, OR 97850
(541) 963-6092

SP. COOR: NAD 83(91)

N: 591464.448 INT FT.

E: 8857829.699 INT FT.

TYPE: GPS

THETA: 1 ° 48 ' 23 "

ORDER: SECOND CLASS: 1

SCALE FACTOR: 0.9998958663

ELEV: 2695.20 US FT.

ELEV: DATUM: NGVD 29

COMMENTS:

Corner is 2 1/2" brass cap on 5/8" copperclad iron pin with cap marked as shown. Corner falls 5" below road surface in center of Peach Road.

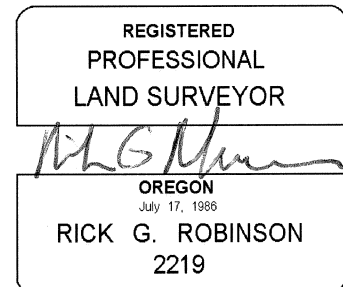
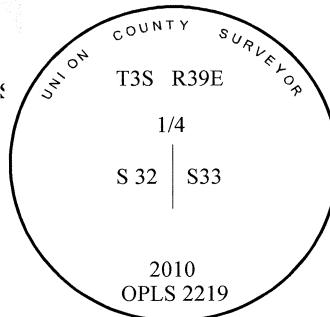

Renewal Date: December 31, 2010

1 METER = 3.2808333333... US FEET = 39.37 INCHES

1 METER = 3.280839895 INT'L FEET OR 1 INCH = 2.54 CM

TO CALCULATE ELEVATION FACTOR (IN THE NORTH AMERICAN CONTINENT)

DIVIDE 20,906,000 BY (20,906,000 + ELLIPSOID ELEV. IN FEET)