

CERTIFIED RECORD OF LAND CORNER MONUMENTATION

History of original corner establishment:

Original survey by the General Land Office, 1863, states:

Set post for corner to Sections 32, 33, 28, and 29 at edge of swampy lake and built mound of earth with charred stake, pits and trenches per instructions.

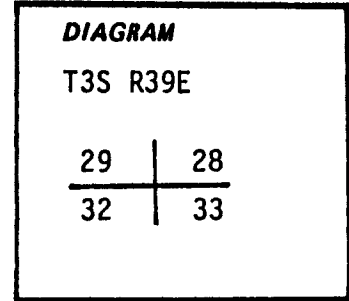

Description of corner evidence found:

No evidence of original corner found.

Refer to the Union County Surveyor's Records.

Description of monument and accessories I established to perpetuate the original location of this corner:

At the corner point determined as shown on a survey for the Oregon Department of Fish and Wildlife, dated July, 1990, we set a 5/8"x30" Iron Rod (rebar) with yellow plastic cap marked "AP&A", buried 3" in a gravel County Road.

From which the following corner accessories:

A 2"x36" Aluminum pipe buried 2" in the ground and located 3' east of a N-S fence, with magnet-equipped aluminum cap, marked:

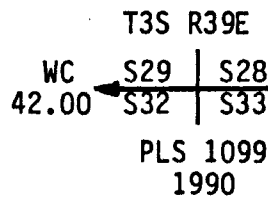

Bears S89°56'18"E 42.00 feet,

A 5/8"x30" Iron Rod (rebar) with yellow plastic cap marked "AP&A", located one foot east of a N-S fence, bears N31°36'30"W 52.72 feet,

A 5/8"x30" Iron Rod (rebar) with yellow plastic cap marked "AP&A", located one foot east of a N-S fence, bears S29°53'20"W 54.58 feet, and

The center of an existing 4" diameter steel well casing pipe near the SW corner of the old Hot Lake School Building, bears S58°52'00"E 79.22 feet.

Accessory ties made with a Theodolite, steel tape and electronic distance meter.

June 30, 1990

Gary Langlitz, LS 1099
Jared Russell

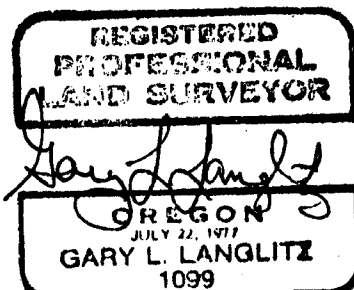

August 13, 1990

UNION COUNTY SURVEYOR	
Date Received	8-13-90
Date Filed	8-22-90
By	<i>Greg Blackman</i>
File No.	79-90R

V-9

CERTIFIED RECORD OF LAND CORNER MONUMENTATION

HISTORY OF ORIGINAL CORNER ESTABLISHMENT:

Corner originally established by David P. Thompson Contract No. 103, dated September 3, 1863. Surveyor General record states: Set Post for corner to Sections 32,33,28 and 29 at edge of swampy lake and built mound of earth with charred stake, pits and trenches as per instructions.

Monumentation record 49-90R states: Set 5/8" Iron rebar with yellow plastic cap marked "AP&A". From which:

BEARING OBJECTS:

Center of a 4" dia. steel well casing bears S 58°52'00"E, a distance of 79.22 feet,

A 5/8" rebar with yellow plastic cap marked "AP&A" bears S 29°53'20"W, a distance of 54.58 feet,

A 5/8" rebar with yellow plastic cap marked "AP&A" bears N 31°36'30"W, a distance of 52.72 feet,

A 2"x36" aluminum pipe with cap marked as shown bears S 89°56'18"E, a distance of 42.00 feet.

No subsequent monumentation found in Union County survey records.

DESCRIPTION OF CORNER EVIDENCE FOUND:

No evidence of the original corner was found.

Found: Corner monument and accessories as per monumentation record 49-90R.

See Union County Survey Number 027-1990.

DESCRIPTION OF MONUMENT AND ACCESSORIES I ESTABLISHED

TO PERPETUATE THE ORIGINAL LOCATION OF THIS CORNER: At the position of the found 5/8" rebar I set a 2 1/2" x 30" Copper Clad iron pin with 2 1/2" Brass Cap marked as shown, 6" below the surface of existing gravel road. From which;

NEW BEARING OBJECT:

A 5/8" x 30" rebar with 1 1/2" aluminum cap bears N 54°E, a distance of 22.20 feet, marked NE R.P.

I hereby certify that the corner was rehabilitated on July 14, 2010

Witness: Greg Blackman Jr. & Jeff Hsu

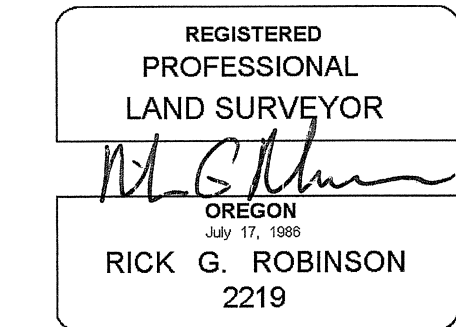
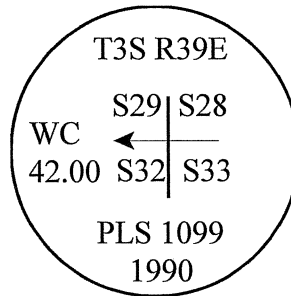
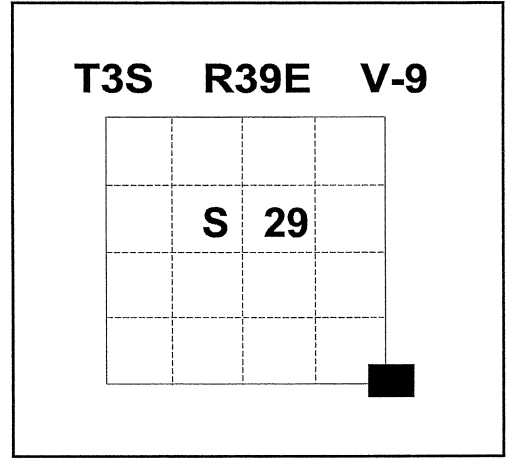

Renewal Date: December 31, 2010

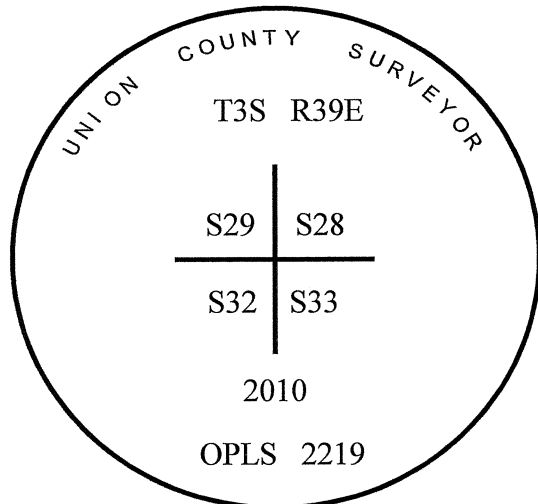

UNION COUNTY SURVEYOR

Date Received 7/30/2010

Date Filed 7/30/2010

Filed By Greg T. Blackman

File Number 027-2010R

I used a compass and steel tape in the establishment of the new accessory. I used 18° East declination, distance is to center of aluminum cap. Basis of Bearing for existing accessories is that of Survey number 027-1990.

HORIZONTAL CONTROL DATA

UNION COUNTY, OREGON

OREGON STATE PLANE, NORTH ZONE (3601)

STA NAME: 201011

SECTION CORNER COMMON TO SECTION 28, 29, 32 AND 33

TWP. 3 S. RGE. 39 E.

GEODETIC COORD: NAD 83(91)

DATE TIED: JULY 15, 2010

LAT: 45 ° 16 ' 5.29965 " N

SURVEYOR: RICK G. ROBINSON
OPLS 2219

LONG: 117 ° 57 ' 10.22672 " W

FIRM: BAGETT, GRIFFITH, & BLACKMAN
2006 ADAMS AVENUE
LAGRANDE, OR 97850
(541) 963-6092

SP. COOR: NAD 83(91)

N: 594188.043 INT FT.

E: 8857751.366 INT FT.

TYPE: GPS

THETA: 1 ° 48 ' 23.1 "

ORDER: SECOND CLASS: 1

SCALE FACTOR: 0.9998960835

ELEV: 2694.89 US FT.

ELEV: DATUM: NGVD 29

COMMENTS:

Corner is 2 1/2" brass cap on 5/8" copperclad iron pin with cap marked as shown.

Corner falls in center of Peach Road.

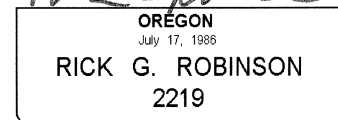
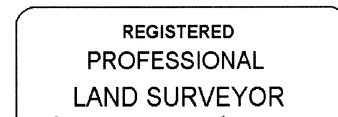
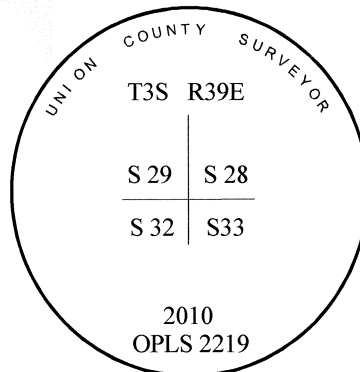

Renewal Date: December 31, 2010

1 METER = 3.280833333... US FEET = 39.37 INCHES

1 METER = 3.280839895 INT'L FEET OR 1 INCH = 2.54 CM

TO CALCULATE ELEVATION FACTOR (IN THE NORTH AMERICAN CONTINENT)

DIVIDE 20,906,000 BY (20,906,000 + ELLIPSOID ELEV. IN FEET)