

CERTIFIED RECORD OF LAND CORNER MONUMENTATION

HISTORY OF ORIGINAL CORNER ESTABLISHED:

Corner was originally established under GLO contract number No. 103, dated September 3, 1963, executed David P. Thompson. Surveyor General field notes state:

Set post for 1/4 sec. corner in mound of earth with charred stake, pits, trench, as per instructions.

T 3 S R 39 E T-21

	S	26	

DESCRIPTION OF CORNER EVIDENCE FOUND:

None. Position falls in Godley Road. A West running tree row falls to the West.

SEE SURVEY NUMBER 018-2025

DESCRIPTION OF MONUMENT AND ACCESSORIES I ESTABLISHED TO REHABILITATE THE MONUMENT AT THE ORIGINAL LOCATION OF THIS CORNER:

At position by Survey, I set a 5/8" x 30" iron pin, with 3" brass cap, marked as shown below, 38" in the ground and below the gravel road surface, from which:

NEW BEARING OBJECTS:

A 5/8" x 30" iron pin bears North 44°48' East, a distance of 26.05 feet, with 1 ½" aluminum cap marked UNION COUNTY SURVEYOR NE RP.
A 5/8" x 30" iron pin bears South 46°51' East, a distance of 25.77 feet, with 1 ½" aluminum cap marked UNION COUNTY SURVEYOR SE RP.
A 5/8" x 30" iron pin bears South 42°06' West, a distance of 28.65 feet, with 1 ½" aluminum cap marked UNION COUNTY SURVEYOR SW RP.
A 5/8" x 30" iron pin bears North 38°16' West, a distance of 28.24 feet, with 1 ½" aluminum cap marked UNION COUNTY SURVEYOR NW RP.

I hereby certify that the corner was monumented on April 15, 2025

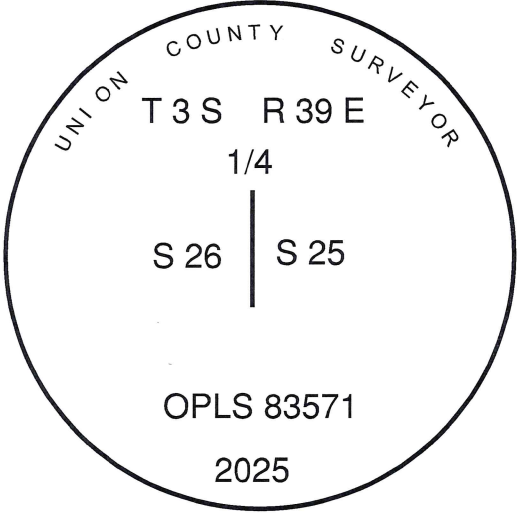

Renewal Date: June 30, 2025

I used RTK GPS in the establishment of the accessories. Bearing and distances are to the center of the aluminum caps. Basis of bearings is as per Survey Number 018-2025.

UNION COUNTY
SURVEYOR

Date Received4/28/25

Date Filed4/28/25

Filed By

File Number018-2025R

HORIZONTAL CONTROL DATA
UNION COUNTY, OREGON
OREGON STATE PLANE, NORTH ZONE (3601)

STA NAME: 2025016

QUARTER CORNER COMMON TO SECTIONS 25 AND 26

TWP. 3 S RGE. 39 E

GEODETIC COORD: NAD 83(91)

DATE TIED: April 15, 2025

LAT: 45 ° 16 ' 30.55637 " N

SURVEYOR: JEFFREY S. HSU
OPLS 83571

LONG: 117 ° 53 ' 28.05406 " W

FIRM: BAGETT, GRIFFITH, & BLACKMAN
2006 ADAMS AVENUE
LAGRANDE, OR 97850
(541) 963-6092

SP. COOR: NAD 83(91)

N: 597251.456 INT FT.

E: 8873548.983 INT FT.

TYPE: GPS

THETA: 1 ° 51 ' 0.6 "

ORDER: SECOND CLASS: 1

SCALE FACTOR: 0.999896303

ELEV: 2691.79 US FT.

ELEV: DATUM: NGVD 29

COMMENTS:

3" Brass Cap marked as shown in
center of road

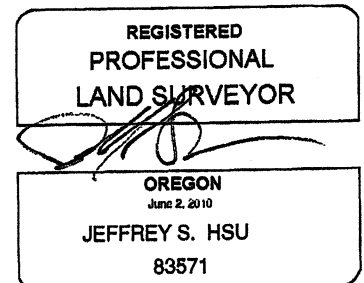
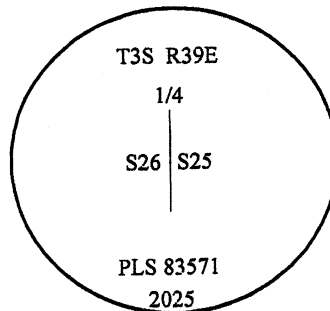

Renewal Date: June 30, 2025

1 METER = 3.280833333... US FEET = 39.37 INCHES

1 METER = 3.280839895 INT'L FEET OR 1 INCH = 2.54 CM

TO CALCULATE ELEVATION FACTOR (IN THE NORTH AMERICAN CONTINENT)

DIVIDE 20,906,000 BY (20,906,000 + ELLIPSOID ELEV. IN FEET)

GEOID MODEL : 2012B