

**CERTIFIED RECORD OF LAND CORNER MONUMENTATION**

**HISTORY OF ORIGINAL CORNER ESTABLISHED:**

Corner was originally established under GLO contract number No. 103, dated September 3, 1963, executed David P. Thompson. Surveyor General field notes state:

Set post for 1/4 sec. corner in mound of earth with charred stake, pits, trench, as per instructions.

Survey for Road Petition 394, dated Aug. 12, 1891, executed by J.L. Curtis commences at this corner where he calls it a 1/4 corner post

T 3 S R 39 E N-07

S	20	

**DESCRIPTION OF CORNER EVIDENCE FOUND:**

None. Position falls at the intersection of Peach Road and an old fence going West.

SEE SURVEY NUMBER 018-2025

**DESCRIPTION OF MONUMENT AND ACCESSORIES I ESTABLISHED TO REHABILITATE THE MONUMENT AT THE ORIGINAL LOCATION OF THIS CORNER:**

At position by Survey, I set a 5/8" x 30" iron pin, with 3" brass cap, marked as shown below, 38" in the ground and below the gravel road surface, from which:

**NEW BEARING OBJECTS:**

- A 5/8" x 30" iron pin bears North 53°42' East, a distance of 24.61 feet, with 1 ½" aluminum cap marked UNION COUNTY SURVEYOR NE RP.
- A 5/8" x 30" iron pin bears South 32°49' East, a distance of 48.92 feet, with 1 ½" aluminum cap marked UNION COUNTY SURVEYOR SE RP.
- A 5/8" x 30" iron pin bears South 43°20' West, a distance of 39.47 feet, with 1 ½" aluminum cap marked UNION COUNTY SURVEYOR SW RP.
- A 5/8" x 30" iron pin bears North 39°47' West, a distance of 26.80 feet, with 1 ½" aluminum cap marked UNION COUNTY SURVEYOR NW RP.

I hereby certify that the corner was monumented on April 1, 2025

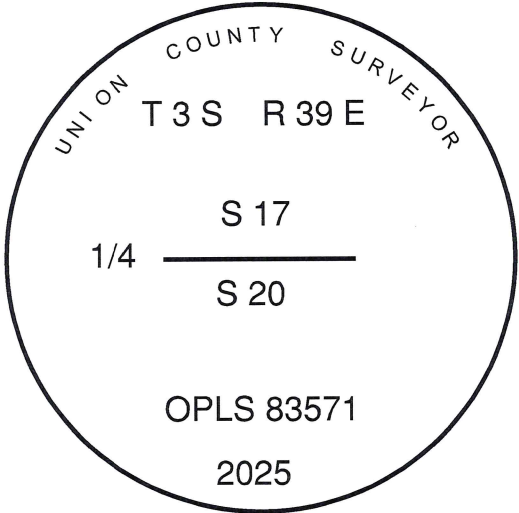

REGISTERED  
PROFESSIONAL  
LAND SURVEYOR



OREGON  
June 2, 2010  
JEFFREY S. HSU  
83571

Renewal Date: June 30, 2025

I used RTK GPS in the establishment of the accessories. Bearing and distances are to the center of the aluminum caps. Basis of bearings is as per Survey Number 018-2025.

UNION COUNTY  
SURVEYOR

Date Received 4/28/25

Date Filed 4/28/25

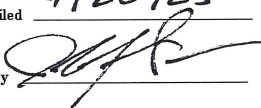
Filed By 

File Number 010-2025R

**HORIZONTAL CONTROL DATA**  
**UNION COUNTY, OREGON**  
**OREGON STATE PLANE, NORTH ZONE (3601)**

STA NAME: 2025008

QUARTER CORNER COMMON TO SECTIONS 17 AND 20

TWP. 3 S RGE. 39 E

GEODETIC COORD: NAD 83(91)

DATE TIED: April 1, 2025

LAT: 45 ° 17 ' 49.26136 " N

SURVEYOR: JEFFREY S. HSU  
OPLS 83571

LONG: 117 ° 57 ' 48.02537 " W

FIRM: BAGETT, GRIFFITH, & BLACKMAN  
2006 ADAMS AVENUE  
LAGRANDE, OR 97850  
(541) 963-6092

SP. COOR: NAD 83(91)

N: 604626.427 INT FT.

E: 8854719.079 INT FT.

TYPE: GPS

THETA: 1 ° 47 ' 56.3 "

ORDER: SECOND CLASS: 1

SCALE FACTOR: 0.999897083

ELEV: 2698.60 US FT.

ELEV: DATUM: NGVD 29

---

COMMENTS:

3" Brass Cap marked as shown in  
center of road

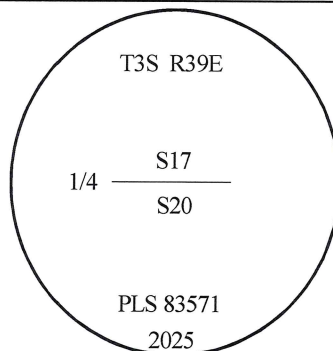

1 METER = 3.280833333... US FEET = 39.37 INCHES

1 METER = 3.280839895 INT'L FEET OR 1 INCH = 2.54 CM

TO CALCULATE ELEVATION FACTOR ( IN THE NORTH AMERICAN CONTINENT)

DIVIDE 20,906,000 BY (20,906,000 + ELLIPSOID ELEV. IN FEET)

GEOID MODEL : 2012B