

**CERTIFIED RECORD OF LAND CORNER MONUMENTATION**

**HISTORY OF ORIGINAL CORNER ESTABLISHED:**

Corner was originally established under GLO contract number No. 103, dated September 3, 1963, executed David P. Thompson. Surveyor General field notes state:

Set post for 1/4 sec. corner in mound of earth with charred stake, pits, trench, as per instructions.

In Old Book 91, dated Sept. 5th, 1888, J.W. Kimbrell found no trace of the quarter corner. Field Notes states:

Set stone 6x12x17 inches for 1/4 sec. corner bet. Sec. 13&14 in road

Survey for Road Petition 359, dated Sept 13, 1890, executed by J. L. Curtis, specifically calls to this corner as established by J W Kimball.

Survey for Road Petition 505, dated Jan. 18, 1899, executed by W.B. Blakeslee commences at a point 45.30 Lks North of this corner. Not specific about describing monument.

T 3 S R 39 E L-21

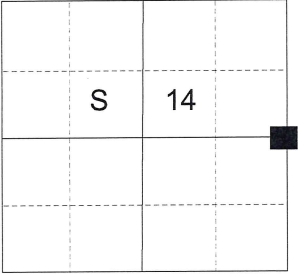

**DESCRIPTION OF CORNER EVIDENCE FOUND:**

None. Falls approximately at the intersection of Gekeler Lane and Godley Road. Large ditch falls along the South side of Gekeler Lane and runs East/West.

SEE SURVEY NUMBER 018-2025

**DESCRIPTION OF MONUMENT AND ACCESSORIES I ESTABLISHED TO REHABILITATE THE MONUMENT AT THE ORIGINAL LOCATION OF THIS CORNER:**

At position by Survey, I set a 5/8" x 30" iron pin, with 3" brass cap, marked as shown below, 36" in the ground and below the gravel road surface, from which:

**NEW BEARING OBJECTS:**

A 5/8" x 30" iron pin bears North 43°15' East, a distance of 70.01 feet, with 1 ½" aluminum cap marked UNION COUNTY SURVEYOR NE RP, falls in East/West fence line.

A 5/8" x 30" iron pin bears South 45°49' East, a distance of 31.15 feet, with 1 ½" aluminum cap marked UNION COUNTY SURVEYOR SE RP.

A 5/8" x 30" iron pin bears South 38°13' West, a distance of 34.56 feet, with 1 ½" aluminum cap marked UNION COUNTY SURVEYOR SW RP.

A 5/8" x 30" iron pin bears North 39°18' West, a distance of 66.36 feet, with 1 ½" aluminum cap marked UNION COUNTY SURVEYOR NW RP, falls in East/West fence line.

I hereby certify that the corner was monumented on April 15, 2025

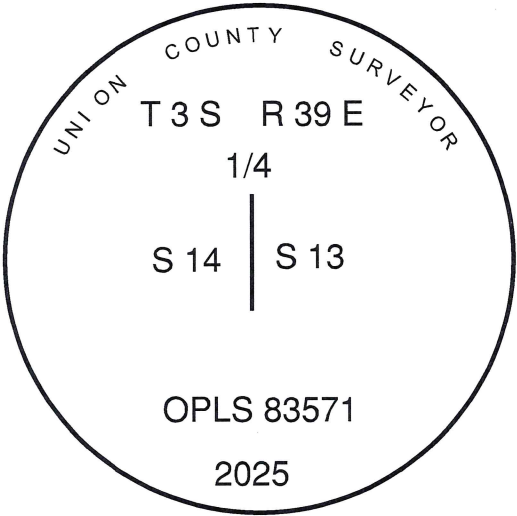

Renewal Date: June 30, 2025

I used RTK GPS in the establishment of the accessories. Bearing and distances are to the center of the aluminum caps. Basis of bearings is as per Survey Number 018-2025.

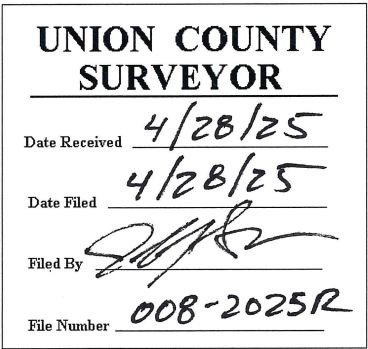

# HORIZONTAL CONTROL DATA

## UNION COUNTY, OREGON

### OREGON STATE PLANE, NORTH ZONE (3601)

STA NAME: 2025019

QUARTER CORNER COMMON TO SECTIONS 13 AND 14

TWP. 3 S RGE. 39 E

GEODETIC COORD: NAD 83(91)

DATE TIED: April 15, 2025

LAT: 45 ° 18 ' 15.17169 " N

SURVEYOR: JEFFREY S. HSU  
OPLS 83571

LONG: 117 ° 53 ' 28.06141 " W

FIRM: BAGETT, GRIFFITH, & BLACKMAN  
2006 ADAMS AVENUE  
LAGRANDE, OR 97850  
(541) 963-6092

SP. COOR: NAD 83(91)

N: 607840.730 INT FT.

E: 8873206.393 INT FT.

TYPE: GPS

THETA: 1 ° 51 ' 0.6 "

ORDER: SECOND CLASS: 1

SCALE FACTOR: 0.999897371

ELEV: 2690.40 US FT.

ELEV: DATUM: NGVD 29

---

#### COMMENTS:

3" Brass Cap marked as shown in  
center of road

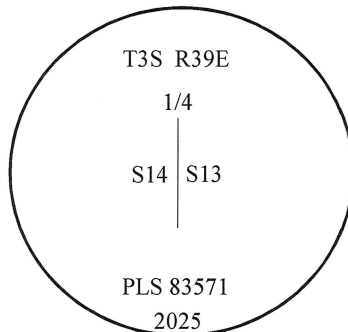

Renewal Date: June 30, 2025

1 METER = 3.280833333... US FEET = 39.37 INCHES

1 METER = 3.280839895 INT'L FEET OR 1 INCH = 2.54 CM

TO CALCULATE ELEVATION FACTOR ( IN THE NORTH AMERICAN CONTINENT)

DIVIDE 20,906,000 BY (20,906,000 + ELLIPSOID ELEV. IN FEET)

GEOID MODEL : 2012B