

CERTIFIED RECORD OF LAND CORNER MONUMENTATION

HISTORY OF ORIGINAL CORNER ESTABLISHED:

Corner was originally established under GLO contract number No. 103, dated September 3, 1963, executed David P. Thompson. Surveyor General field notes state:

Set post for 1/4 sec. corner in mound of earth with charred stake, pits, trench, as per instructions.

In Survey 28-65, James Voelz notes this corner as being along an existing fence line.

T 3 S R 39 E J-11

	S	16	

DESCRIPTION OF CORNER EVIDENCE FOUND:

None. Position falls along a shared North/South running farm road, attested by the landowners as intended to run along the line.

SEE SURVEY NUMBER 018-2025

DESCRIPTION OF MONUMENT AND ACCESSORIES I ESTABLISHED TO REHABILITATE THE MONUMENT AT THE ORIGINAL LOCATION OF THIS CORNER:

At position by Survey, I set a 2 1/2" x 30" aluminum pipe, with 3" aluminum cap, marked as shown below, 34" in the ground and below the gravel road surface, from which:

NEW BEARING OBJECTS:

- A 5/8" x 30" iron pin bears North 46°15' East, a distance of 12.19 feet, with 1 ½" aluminum cap marked UNION COUNTY SURVEYOR NE RP.
- A 5/8" x 30" iron pin bears South 32°37' East, a distance of 14.67 feet, with 1 ½" aluminum cap marked UNION COUNTY SURVEYOR SE RP.
- A 5/8" x 30" iron pin bears South 39°37' West, a distance of 78.98 feet, with 1 ½" aluminum cap marked UNION COUNTY SURVEYOR SW RP, which bears approx. 2 ft. East of a pivot stop.
- A 5/8" x 30" iron pin bears North 50°50' West, a distance of 13.82 feet, with 1 ½" aluminum cap marked UNION COUNTY SURVEYOR NW RP.

I hereby certify that the corner was monumented on April 1, 2025

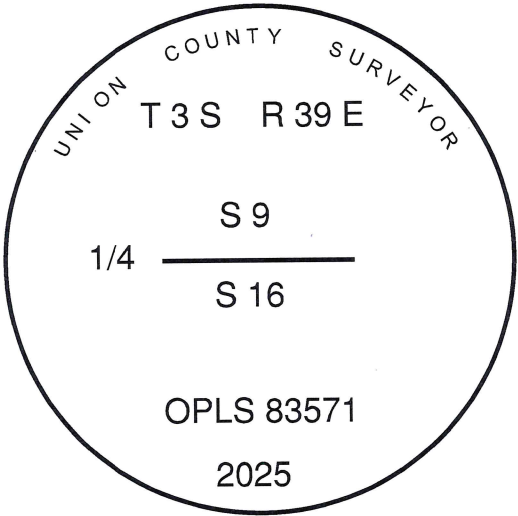

REGISTERED
PROFESSIONAL
LAND SURVEYOR



OREGON
June 2, 2010
JEFFREY S. HSU
83571

Renewal Date: June 30, 2025

I used RTK GPS in the establishment of the accessories. Bearing and distances are to the center of the aluminum caps. Basis of bearings is as per Survey Number 018-2025.

**UNION COUNTY
SURVEYOR**

Date Received 4/28/25

Date Filed 4/28/25

Filed By 

File Number 005-2025R

HORIZONTAL CONTROL DATA
UNION COUNTY, OREGON
OREGON STATE PLANE, NORTH ZONE (3601)

STA NAME: 2025004

QUARTER CORNER COMMON TO SECTIONS 9 AND 16

TWP. 3 S RGE. 39 E

GEODETIC COORD: NAD 83(91)

DATE TIED: April 1, 2025

LAT: 45 ° 18 ' 41.75076 " N

SURVEYOR: JEFFREY S. HSU
OPLS 83571

LONG: 117 ° 56 ' 33.43376 " W

FIRM: BAGETT, GRIFFITH, & BLACKMAN
2006 ADAMS AVENUE
LAGRANDE, OR 97850
(541) 963-6092

SP. COOR: NAD 83(91)

N: 610107.650 INT FT.

E: 8859879.777 INT FT.

TYPE: GPS

THETA: 1 ° 48 ' 49.2 "

ORDER: SECOND CLASS: 1

SCALE FACTOR: 0.999897683

ELEV: 2692.85 US FT.

ELEV: DATUM: NGVD 29

COMMENTS:

3" Aluminum Cap marked as shown
in farm road

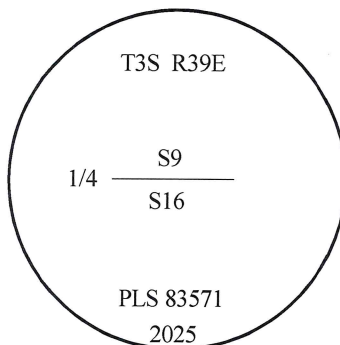

Renewal Date: June 30, 2025

1 METER = 3.280833333... US FEET = 39.37 INCHES

1 METER = 3.280839895 INT'L FEET OR 1 INCH = 2.54 CM

TO CALCULATE ELEVATION FACTOR (IN THE NORTH AMERICAN CONTINENT)

DIVIDE 20,906,000 BY (20,906,000 + ELLIPSOID ELEV. IN FEET)

GEOID MODEL : 2012B