

CERTIFIED RECORD OF LAND CORNER MONUMENTATION

HISTORY OF ORIGINAL CORNER ESTABLISHED:

Corner was originally established under GLO contract number No. 103, dated September 3, 1963, executed David P. Thompson. Surveyor General field notes state:

Set post 1/4 sec. corner in mound of earth with charred stake. Pins, trenches as per instructions.

Corner not found in Old Book Surveys Page 98, dated October 1st, 1888, by J.W. Kimbrell. Kimbrell sets a temp stake.

T 3 S R 39 E J-07

S	17	

DESCRIPTION OF CORNER EVIDENCE FOUND:

None. Position falls at the intersection of Gekeler Lane and Peach Road.

SEE SURVEY NUMBER 018-2025

DESCRIPTION OF MONUMENT AND ACCESSORIES I ESTABLISHED TO REHABILITATE THE MONUMENT AT THE ORIGINAL LOCATION OF THIS CORNER:

At the intersection of Gekeler Lane and Peach Road, I set a 5/8" x 30" iron pin, with 3" brass cap, marked as shown below, 36" in the ground and below the gravel road surface, from which:

NEW BEARING OBJECTS:

- A 5/8" x 30" iron pin bears North 51°42' East, a distance of 39.28 feet, with 1 ½" aluminum cap marked UNION COUNTY SURVEYOR NE RP.
- A 5/8" x 30" iron pin bears South 44°41' East, a distance of 45.48 feet, with 1 ½" aluminum cap marked UNION COUNTY SURVEYOR SE RP.
- A 5/8" x 30" iron pin bears South 46°03' West, a distance of 45.70 feet, with 1 ½" aluminum cap marked UNION COUNTY SURVEYOR SW RP.
- A 5/8" x 30" iron pin bears North 40°33' West, a distance of 49.30 feet, with 1 ½" aluminum cap marked UNION COUNTY SURVEYOR NW RP, falls approx. 3 feet NW'ly of fence corner to North and West bearing fences.

Fence corner bears approx. 30 feet North and West from which fences run North and West along the right of way. North/South fence line falls approx. 30 feet East.

I hereby certify that the corner was monumented on April 15, 2025

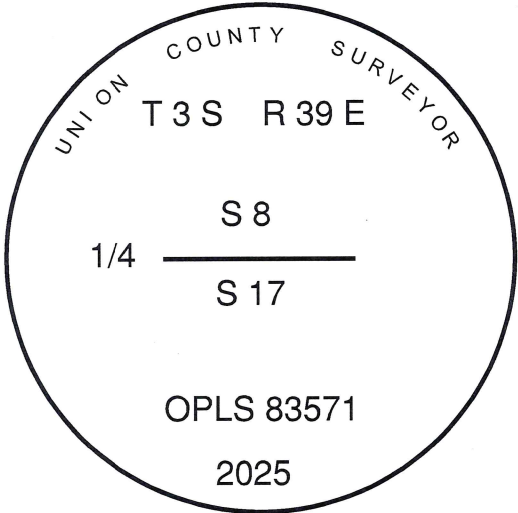

REGISTERED  
PROFESSIONAL  
LAND SURVEYOR

  
OREGON  
June 2, 2010  
JEFFREY S. HSU  
83571

Renewal Date: June 30, 2025

I used RTK GPS in the establishment of the accessories. Bearing and distances are to the center of the aluminum caps. Basis of bearings is as per Survey Number 018-2025.

UNION COUNTY  
SURVEYOR

Date Received 4/28/25

Date Filed 4/28/25

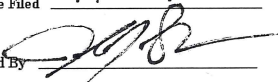
Filed By 

File Number 003-2025R

# HORIZONTAL CONTROL DATA

## UNION COUNTY, OREGON

### OREGON STATE PLANE, NORTH ZONE (3601)

STA NAME: 2025015

QUARTER CORNER COMMON TO SECTIONS 8 AND 17

TWP. 3 S RGE. 39 E

GEODETIC COORD: NAD 83(91)

DATE TIED: April 15, 2025

LAT: 45 ° 18 ' 41.23385 " N

SURVEYOR: JEFFREY S. HSU  
OPLS 83571

LONG: 117 ° 57 ' 48.27287 " W

FIRM: BAGETT, GRIFFITH, & BLACKMAN  
2006 ADAMS AVENUE  
LAGRANDE, OR 97850  
(541) 963-6092

SP. COOR: NAD 83(91)

N: 609886.757 INT FT.

E: 8854536.167 INT FT.

TYPE: GPS

THETA: 1 ° 47 ' 56.1 "

ORDER: SECOND CLASS: 1

SCALE FACTOR: 0.999897677

ELEV: 2695.77 US FT.

ELEV: DATUM: NGVD 29

#### COMMENTS:

3" Brass Cap marked as shown in  
center of road

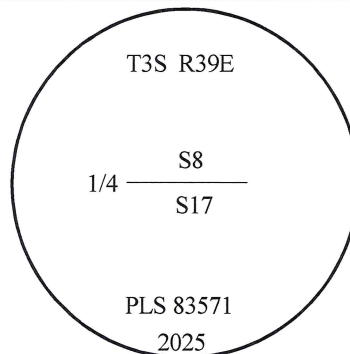

Renewal Date: June 30, 2025

1 METER = 3.280833333... US FEET = 39.37 INCHES

1 METER = 3.280839895 INT'L FEET OR 1 INCH = 2.54 CM

TO CALCULATE ELEVATION FACTOR ( IN THE NORTH AMERICAN CONTINENT)

DIVIDE 20,906,000 BY (20,906,000 + ELLIPSOID ELEV. IN FEET)

GEOID MODEL : 2012B